

**CUSTOMER SERVICE**  
**SERVICE BULLETIN**

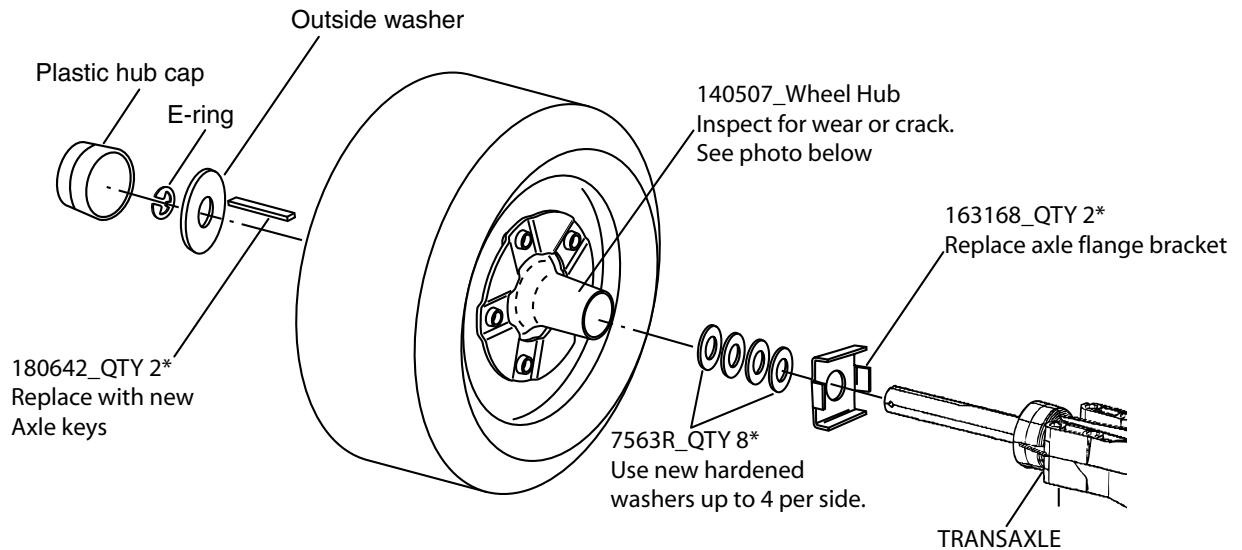

**\*THESE PARTS ARE INCLUDED IN KIT#180696**

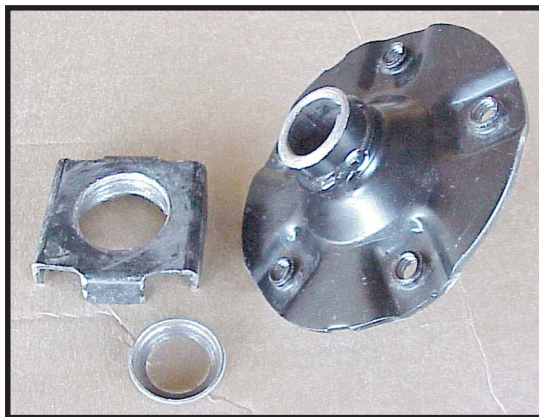

**WORN HUB, BRACKET & WASHER**

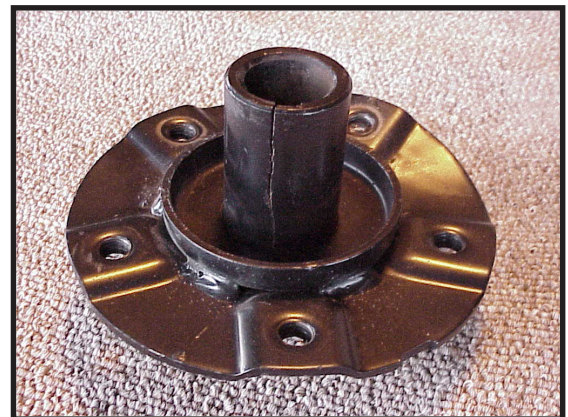

**CRACKED HUB**

**Outdoor Products Customer Service Department**  
Electrolux Home Products  
250 Bobby Jones Expressway  
Augusta, GA 30909 USA

**CUSTOMER SERVICE**  
**SERVICE BULLETIN**

**GT wheel hubs may show excessive wear after extensive use.**

**CONDITIONS:**

ON SPECIFIC AUTOMATIC TRANSAXLE UNITS, THE KEYWAY INSIDE THE WHEEL HUB MAY BECOME DAMAGED DUE TO AN UNDERSIZED 2" KEY AND SOFT WASHERS. THERE MAY BE WEAR ON THE INSIDE SURFACE OF THE REAR WHEEL HUB, WASHERS AND AXLE FLANGE BRACKETS INBOARD OF THE GT WHEEL HUB. THIS CONDITION MAY DEVELOP AFTER SEVERAL HUNDRED HOURS OF EXTREME USE.

**MODELS AFFECTED:**

PRGT22H48A

**DATE CODE RANGE AFFECTED 011501 THRU 092101.** THE TRANSAXLE PART NUMBERS ARE EITHER 176056 OR 176057, AS LISTED IN THE OWNERS MANUAL AND ON THE TRANSAXLE SERIAL TAG.

**CORRECTION:**

REMOVE THE TWO PLASTIC AXLE CAPS IF EQUIPPED, E-RINGS, AND OUTSIDE WASHERS AT THE END OF THE TRANSAXLE SHAFTS. REMOVE THE REAR WHEEL HUB ASSEMBLY, WASHERS/SPACER, THE 2" KEYS ON BOTH AXLES, AND THE TWO AXLE FLANGE WASHERS ADJACENT TO TRANSAXLE. INSTALL KIT# 180696 IN THE ORDER ILLUSTRATED. INSPECT THE WHEEL HUB FOR ANY CRACKS OR WEAR. IF THE WHEEL HUB IS CRACKED OR SHOWS EXTENSIVE WEAR REPLACE WITH PART # 140507. WHEN INSTALLING THE AXLE FLANGE WASHER, THE WIDER FLANGES GO ON TOP AND BOTTOM OF TRANSAXLE AS ANTI-ROTATIONAL FEATURES. REINSTALL ORIGINAL TWO E-RINGS, OUTSIDE WASHERS AND PLASTIC HUB CAPS.

**NOTE: DO NOT REUSE ORIGINAL 2" LONG KEY, OR ORIGINAL WASHER / SPACER.**

**Parts:**

Order Kit #180696 through parts distributor, following normal parts ordering procedures.

***Outdoor Products Customer Service Department***

Electrolux Home Products  
250 Bobby Jones Expressway  
Augusta, GA 30909 USA