



Service Advisory

MTD-081

(Walk Behind Mowers-Self Propelled)

Models Affected: 12AJ866E066; 12AI86K1266; 12AI865Q711 and 12AI867Q011
Serial Number Range Affected: 2008 Model Year units built between January 3, 2008 (Date Code "...A038...") and March 12, 2008 (Date Code "...C128...")
Date: 4/4/2008
Subject: Self Propelled High Wheel Mower Wheel Drive Gear Noise

ACTION REQUIRED: This repair is to be considered a **Fix-As-Fail** repair.

SYMPTOM(S): An intermittent chatter (similar to a loud grinding) sound is heard when the mower is being free wheeled. This chatter/grinding sound is not always present and will start and stop unpredictably.

CORRECTIVE ACTION:

1. Before proceeding with any tear down or service kit installation, test the mower to establish the source of the "noise" alluded to by the customer.
2. If the "noise" is present when the unit is being pushed (free wheeling) **without** the engine running, then the drive wheel gears are the source. The chatter/grinding sound is more easily heard without the engine running but can also be present with the engine running. Refer to SYMPTOM(S) for added information.
3. Please be aware, if the gear noise, when free wheeling, sounds more like gear whine, a little gear whine is normal.
4. If the noise has the audible characteristics as outlined in Step 2 above and not normal gear whine, then install service kit **753-05884** See attached service kit instruction sheet.

Warranty: Normal warranty terms apply. Indicate Service Advisory **MTD- 081** and **P/N 717-04575** as the original failed part on the claim. Repair time allowance is **18 Minutes (.30 Hrs)**. List model and serial number of the unit on claim.

SERVICE MANAGER	PARTS MANAGER	SALES MANAGER	SERVICE TECH.	SERVICE TECH.

Circulate and Initial



Service Kit

753-05884

Date: 4/4/2008

Subject: Drive Wheel Noise

Models Affected: 2008 Model Year 800 (XP) Series
High Wheel Self Propelled Walk Behind Mower

REFERENCE: S/A MTD-081

Read through and understand these instructions completely before proceeding with repair.

PURPOSE: This service kit supplies the hardware and the instructions to install the hardware. The supplied hardware will reduce operational noise from the wheel drive gears.

NOTE: These materials are prepared for use by trained technicians who are experienced in the service and repair of equipment of the kind described in this publication, and are not intended for use by untrained or inexperienced individuals. Such individuals should seek the assistance of an authorized service technician or dealer.

NOTE: *Save this Instruction Sheet. Refer to it when ordering replacement parts.*

Service Kit Contents

(See Figure 1)

ITEM NO.	PART NUMBER	QTY	DESCRIPTION
1	732-04557	2	SPRING: COMPRESSION
2	736-0514	2	WASHER: FLAT: .885 x 1.850 x .060
3	736-3084	2	WASHER: FLAT: .51 x 1.12 x .06 HT
4	736-0160	2	WASHER: FLAT: .53 x .93 x .050
5	736-3068	2	WASHER: FLAT: .531 x .875 x .060
6	712-04065	4	NUT: FLANGE LOCK: 3/8"-16:GRF:NYLON
7	*	1	THIS INSTRUCTION SHEET

* - Not Available Separately

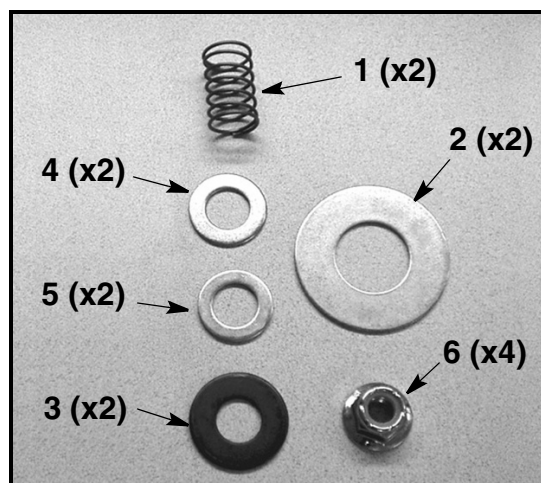

FIGURE 1

Pre-Service Preparation:

1. Place mower on a flat and level surface, turn off the engine and allow engine and muffler to cool before proceeding with the upgrade.

2. Remove the spark plug wire from the spark plug and ground wire to the engine block.

Installation Instructions:

NOTE: Left and right are determined from the operator's position at the rear of the mower and facing forward.

3. On the left hand (LH) side of the mower, place a 3"-4" wood block under the deck side just forward of the rear wheel.

4. Remove the hub cap from the wheel by using a flat blade screw driver to pull the edge of the hub cap away from the wheel. Using your fingers, pull the hub cap off of the wheel hub. The hub cap's "snap-on" retaining feature is on a inner diameter hub. See Figure 2.

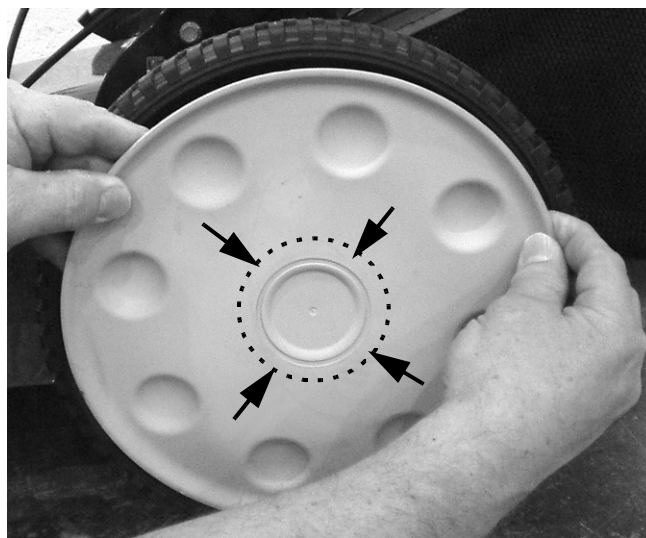

FIGURE 2

5. Using a 9/16" socket and ratchet, remove and discard the hex flange lock nut securing the wheel to the axle. Remove the wheel.

NOTE: To facilitate removal of the Torx screw in the next step, secure the drive bail to the upper handle in the drive engaged position with tape or rope.

6. Using a No. 30 Torx bit, remove the Torx head screw at the end of the transmission's output shaft. Remove the 16T spur gear (mark an "LH" on the gear) and dowel pin. See Figure 3.

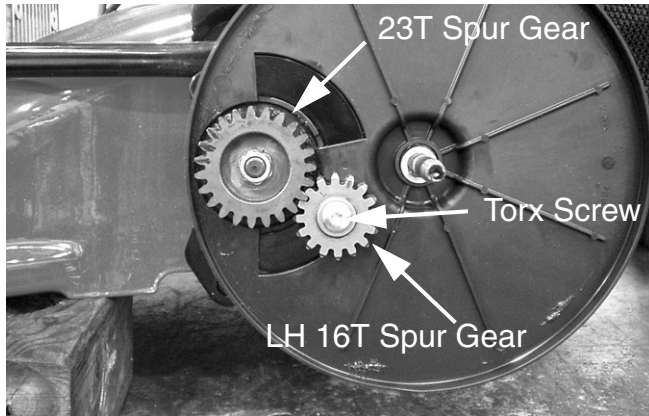

FIGURE 3

7. Using a 9/16" socket and ratchet, remove the hex flange lock nut retaining the 23T spur gear. Remove the 23T spur gear.

8. Remove the dust cover.

9. Assemble a Compression Spring, Item 1, and a Flat Washer, Item 4, onto the transmission's output shaft end. See Figure 4.

10. Assemble a Flat Washer, Item 2, onto the wheel axle shoulder. See Figure 4.

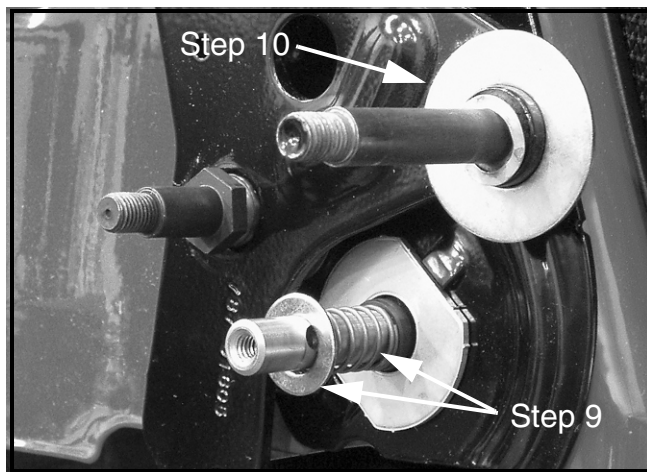

FIGURE 4

11. Re-install the dust cover onto the three shafts/axles.

12. Assemble one (1) Flat Washer, Item 5, and one (1) Flat Washer (HT), Item 3, onto the transmission output shaft, as shown in Figure 5.

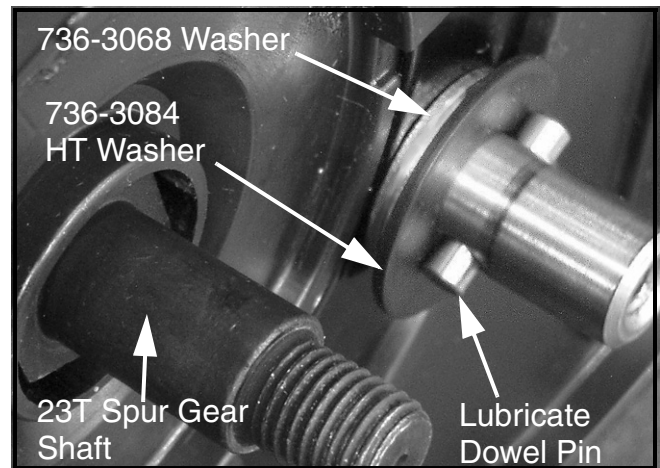

FIGURE 5

13. Using a light lithium or silicone base grease, sparingly lubricate dowel pin (removed in Step 6) and the dowel pin facing side of the 736-3084 HT washer.

14. Install the dowel pin as shown in Figure 5.

15. Using a light lithium or silicone base grease, sparingly lubricate the end of the transmission's output shaft.

16. Reassemble the LH 16T spur gear onto the end of the output shaft.

17. Clean off the threads of old locking compound from the Torx screw. Apply Loctite 242 (Blue) or 246 (Red) or equivalent to the clean Torx screw.

18. Secure the 16T spur gear to the transmission's output shaft with the prepared Torx screw. Tighten securely.

19. Using a lithium or silicone base grease, lubricate the 23T spur gear shaft. Refer to Figure 5.

20. Assemble the 23T spur gear onto the shaft.

21. Using a 9/16" socket and ratchet, assemble a new 3/8"-16 Flange Lock Nut, Item 6, securing the 23T spur gear onto the shaft.

22. Re-assemble the wheel onto the wheel axle. Using a 9/16" socket and ratchet, assemble a new 3/8"-16 Flange Lock Nut, Item 6.

23. Re-install the wheel hub cap.

24. Perform Steps 3 through 24 for the right hand side rear wheel drive gears.

25. Release the drive bail from the upper handle.

This completes the installation of this service kit.