



Service Kit 753-04373

CODE: PE-124

DATE: FEBRUARY 5, 2003

SUBJECT: Conversion Kit for Grass
Bagger Accessory Model
OEM-190-602

MODELS Tractor Model Series 660
AFFECTED: Through 690, 820 and 840

PURPOSE: Use this kit to upgrade an OEM-190-602 Grass Bagger to an OEM-190-182 FastAttach Grass Bagger. This kit will convert an OEM-190-602 Grass Bagger to fit on the 660 through 690, 820 and 840 Series Box Frame Tractors equipped with a 46" cutting deck.

NOTE: Save this Instruction Sheet. Refer to it when ordering replacement parts.

Typical Installation Time: N/A

Service Kit Contents

REF. NO.	PART NUMBER	QTY	DESCRIPTION
1	783-04137	1	LH Catcher Support Bracket
2	783-04132	1	RH Catcher Support Bracket
3	711-0310	1	Clevis Pin, 1/2" x 1 3/16" Lg
4	712-0459	2	Flange Lock Nut, 7/16-20
5	736-0407	2	Bell Washer, 29/64" I.D. x 1" O.D.
6	738-1020	2	Shoulder Screw, 5/8" x 1/2" Lg
7	710-0623	4	Screw, Self-Tapping, 3/8"-16 x 3/4"
8	783-04138	2	Catcher Support Bracket (800)

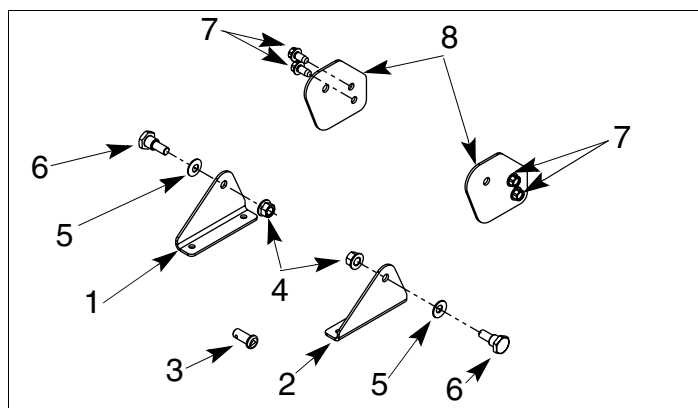

Figure 1

NOTE: If the grass bagger you purchased contains this kit you will need to follow these instructions in place of the instructions in your Owner's Manual noted under the heading "Assembling Support Brackets". This insures you will install the correct brackets for your model tractor.

NOTE: References to LEFT, RIGHT, FRONT and REAR of the tractor are from the operator's position.

NOTE: Before assembly, place the tractor on a firm, level surface, disengage the PTO, stop the tractor engine and set the parking brake.

Tractor Model Series 660 through 690

NOTE: If your tractor is a series 660 through 690 box frame style you will not need Ref. No's. 7 and 8. You will need Ref. No's. 1 through 6.

Assembling Support Brackets

- Remove the top four self-tapping screws from the rear of the lawn tractor. See Figure 2.
- Place the RH Catcher Support Bracket (Ref. No. 2) in position as shown in Figure 3.
- Secure the RH Catcher Support Bracket to the tractor frame with two self-tapping screws removed earlier. Refer to Figure 2.

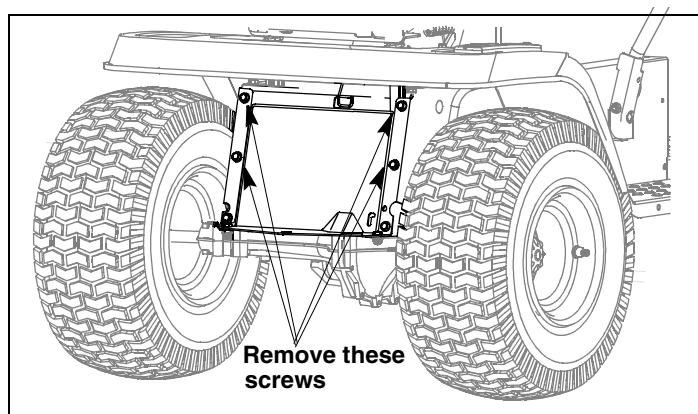

Figure 2

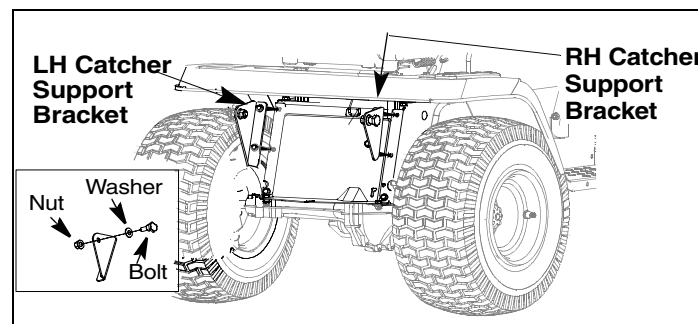

Figure 3

Form No. 769-00644

- Repeat on the left hand side using the LH Catcher Support Bracket (Ref. No. 1).

NOTE: If the grass collection system is removed for any reason, it is not necessary to remove the support brackets from the tractor.

- Insert a Shoulder Screw (Ref. No. 6) through a Bell Washer (Ref. No. 5).

NOTE: When placing the bell washer onto the shoulder screw make sure that the concave side of the bell washer is facing away from the head of the shoulder screw.

- Insert the Shoulder Screw/Bell Washer subassembly through the hole on the RH Catcher Support Bracket. Secure with a Flange Lock Nut (Ref. No. 4). See Figure 3 inset for details. Repeat on other side.

<> (Continuation step for Series 820 and 840 units)

- Refer to Figure 2 of your Owner's Manual that came with the grass bagger. Locate the Bracket Assembly.
- The Bracket Assembly is configured for the 600 through 619 series tractors. It will be necessary to reconfigure the Bracket Assembly for the 660 through 690 series tractors.
- Remove the four bolts that fasten the Support Cross Bracket to the two Catcher Support Brackets. Refer to Figure 4.
- Rotate the Support Cross Bracket between the Support Catcher Brackets so that the tongue portion is facing the same direction as the hook ends of the Catcher Support Brackets. Refer to Figure 6.
- Reinstall the four (4) bolts and nuts removed earlier. Do not tighten, leave slightly loose.
- Position the hooked ends of the Support Catcher Bracket Assembly to the outside of the Support Catcher Brackets sides as shown in Figure 5.
- Locate the clevis pin, 711-0309A, from the hardware package that came with the grass bagger.
- Align the hole at the lower end of the Support Bracket Assembly to the hole on the hitch plate on the tractor and insert the clevis pin through these two holes. Secure the clevis pin with the internal cotter pin, 714-0117, also from the hardware package that came with the grass bagger. Refer to Figure 6.

NOTE: For some tractor models, this clevis pin is too large. Use a smaller clevis pin (Ref. No. 3) in its place with the same hairpin clip.

- When all the brackets are aligned and hardware is installed tighten all hardware securely. This will ensure proper alignment of the Fast Attach Catcher Support Assembly to the 3 attach points on the tractor.
- This completes the assembly of the Catcher Support Bracket Assembly using this kit. Please continue with

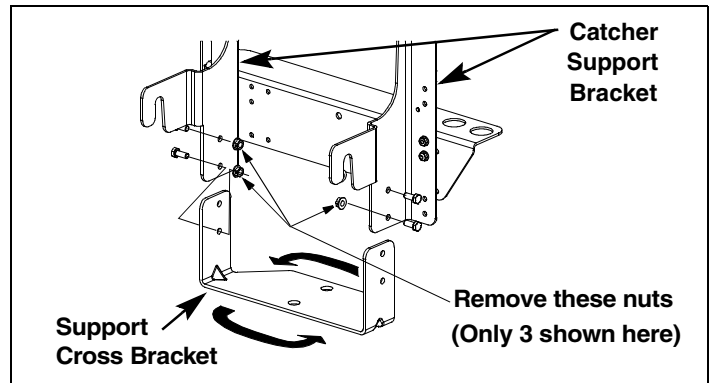

Figure 4

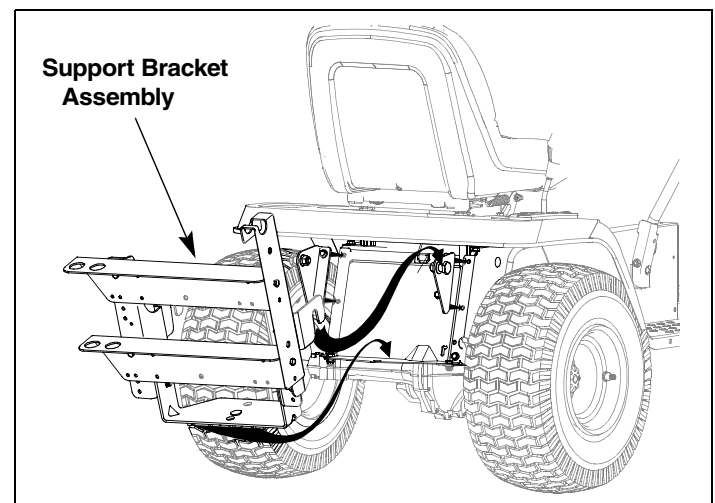

Figure 5

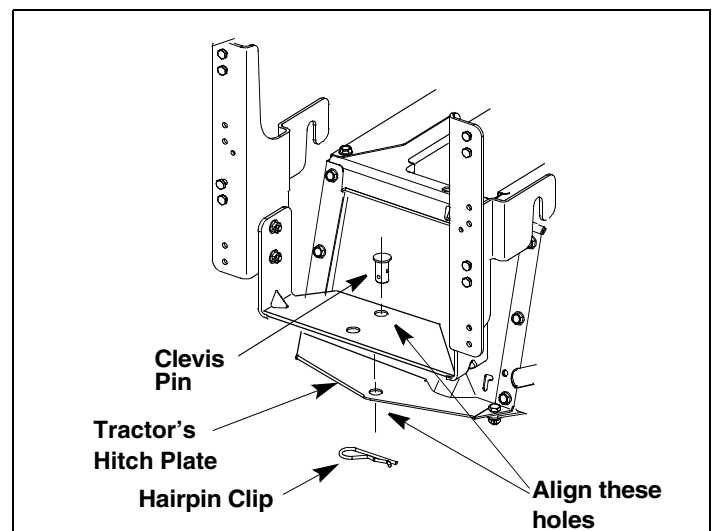

Figure 6

the assembly of the grass bagger as instructed in the Owner's Manual that came with the grass bagger accessory.

Tractor Model Series 820 and 840

NOTE: If your tractor is a series 820 or 840 box frame style you will not need Ref. No.'s 1,2,and 4-6. You will need Ref. No's. 3, 7 and 8.

- Place one Catcher Support Bracket (Ref. No. 8) on each side of the tractor frame aligning the two smaller holes on the bracket with the corresponding holes on the tractor frame as shown in Figure 10.
- Secure the Catcher Support Brackets to the tractor frame with two Self-Tapping Screws (Ref. No. 7). See Figure 10.

NOTE: If the grass collection system is removed for any reason, it is not necessary to remove the support brackets from the tractor.

- Insert a Shoulder Screw (Ref. No. 6) through a Bell Washer (Ref. No. 5).

NOTE: When placing the bell washer onto the shoulder screw make sure that the concave side of the bell washer is facing away from the head of the shoulder screw.

- From the outside of the Catcher Support Bracket insert the Shoulder Screw/Bell Washer subassembly through the hole on the Catcher Support Bracket. Secure with a Flange Lock Nut (Ref. No. 4). See Figure 10. Repeat on other side.
- Continue with the assembly of the support catcher assembly by following the instructions on page 2 from the step denoted by (<>).

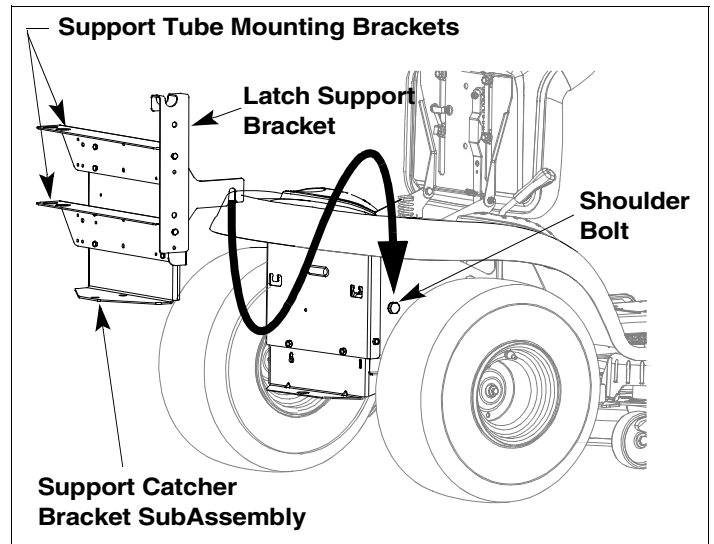

Figure 8

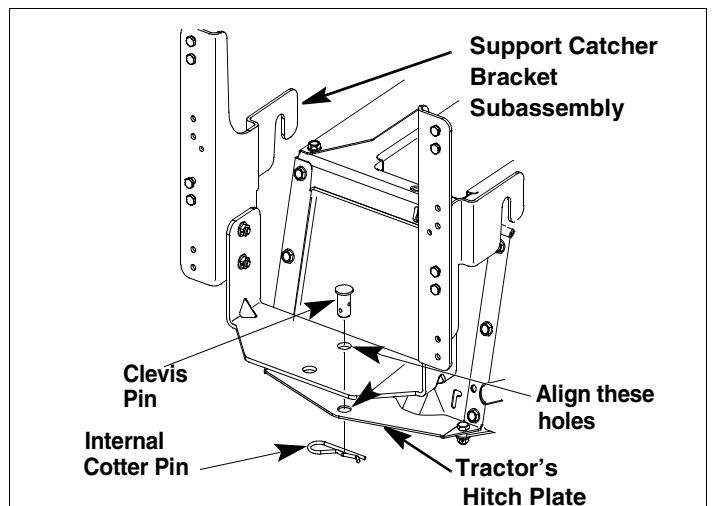

Figure 9

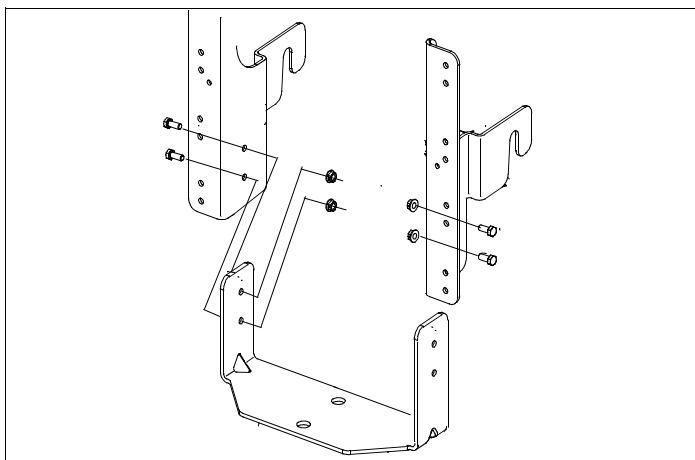

Figure 7

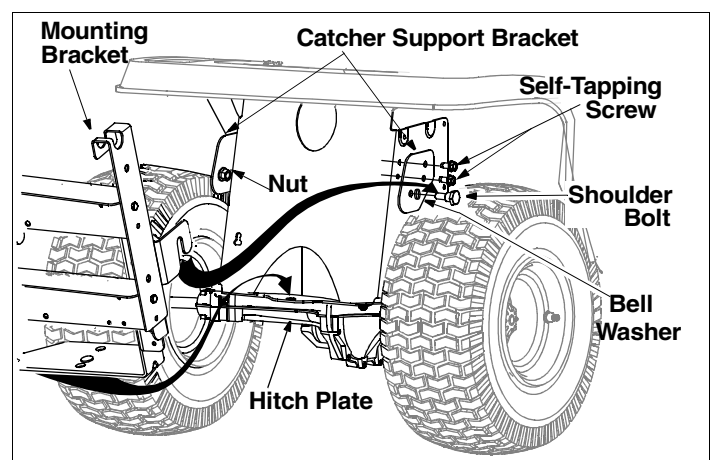

Figure 10