



Service Kit

753-05343

REF: MTD-034

Date: 4/07/2006

Subject: Upper Transmission Drive Belt Path Alignment

Models Affected: 2006 Model Year 600-609 Series AutoDrive Units built between November 1, 2005 and February 17, 2006

Read through and understand these instructions completely before proceeding with repair.

PURPOSE: This service kit provides the latest production transmission torque bracket and upper belt tensioning idler configuration. The new hardware reduces idler vertical movement thereby providing improved belt path alignment.

NOTE: These materials are prepared for use by trained technicians who are experienced in the service and repair of equipment of the kind described in this publication, and are not intended for use by untrained or inexperienced individuals. Such individuals should seek the assistance of an authorized service technician or dealer.

NOTE: *Save this Instruction Sheet. Refer to it when ordering replacement parts.*

Service Kit Contents

(See Figure 1)

ITEM NO.	PART NUMBER	QTY	DESCRIPTION
1	683-04286	1	BRACKET: IDLER: COATED
2	683-04287	1	BRACKET: TORQUE: COATED
3	710-0227	2	SCREW: AB:#8-18: 0.50LG
4	710-1007	1	SCREW: TAPTIGHT SEMS: 3/8" -16 x 1.50
5	712-04065	1	NUT: FLANGELOCK :3/8" -16: GRF: NYLON
6	731-05675A	1	CONDUIT: PLASTIC: SPLIT: 5.0 INCH LONG
7	732-04370	1	SPRING: EXTENSION: 0.76" DIA. x 6.1" LG
8	732-1013	1	BELT: GUARD
9	736-0262	1	WASHER: FLAT: .385 x .870 x .135: HT
10	736-3010	1	WASHER: FLAT: 0.407 x 0.812 x 0.135: HT
11	738-0322A	1	SCREW: SHOULDER:0.625 DIA. x 0.217:GR5
12	756-04241	1	PULLEY: IDLER:V-TYPE 5L x 3.06 DIA.

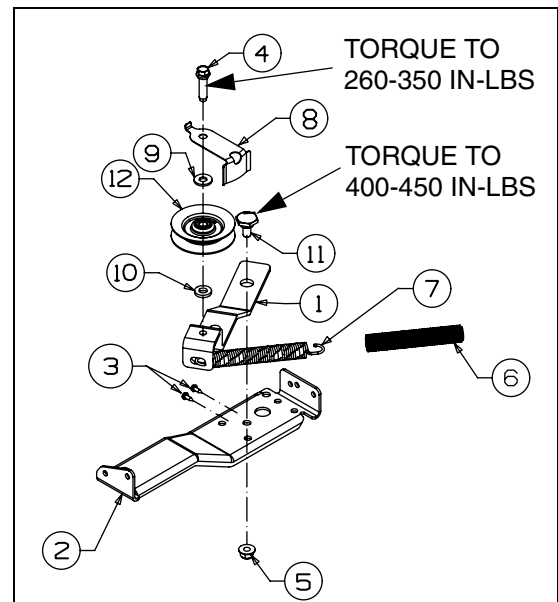

FIGURE 1

Pre-service Instructions:

NOTE: Reference to the left and right sides is from the operator's position in the seat facing the front of the rider.

NOTE: Retain all hardware removed unless stated otherwise.

1. Place rider unit on level ground. Set parking brake on, turn engine off and remove ignition key.
2. Remove cutting deck from under the rider. Refer to the Operator's Manual for deck removal.

Removal Instructions:

3. Refer to Figure 2. From the underside of the rider, disconnect the extension spring, 732-0384, that provides upper transmission belt idler tension, from the hook on the lower frame and the transmission's upper belt tensioning idler. Discard the spring.

NOTE: Inspect the transmission's upper drive belt for damage. Replace if necessary.

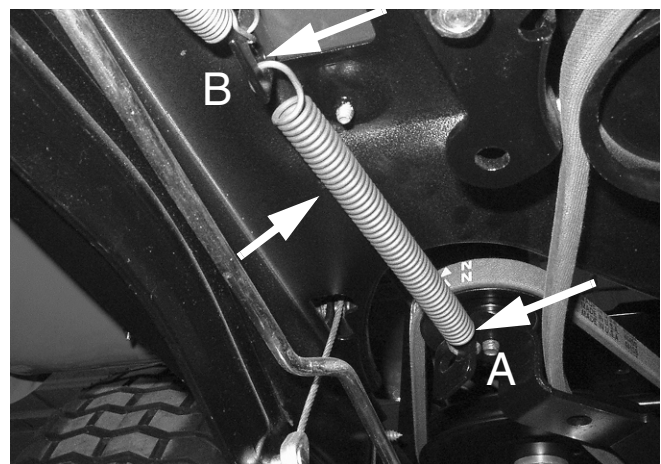

FIGURE 2

4. Refer to Figure 3 for Steps 4 and 5. From the underside of the rider, remove the cotter pin that secures the shift lever to the shift bracket. Remove the hairpin clip that secures the shift rod's adjustable ferrule to the shift lever, see Figure 3 Inset.

NOTE: Make note of the what gear the shift lever (transmission) is in, before removing the hairpin clip, for re-connection later in the instructions.

5. From the underside of the rider, disconnect the wire from the reverse safety spring switch located on the cross member torque bracket.

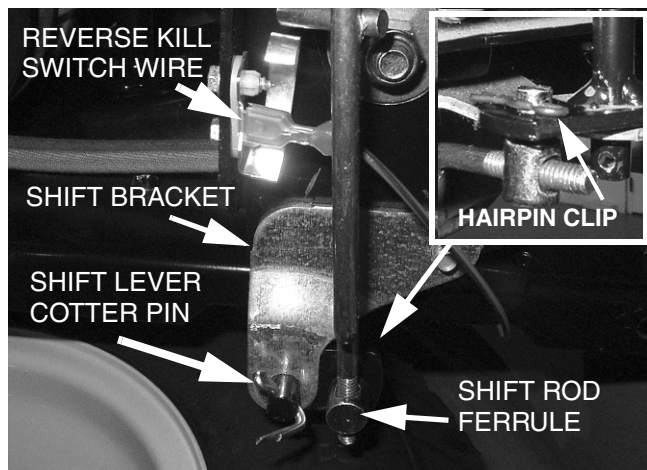

FIGURE 3

6. From the underside of the rider, using a 1/2" socket and ratchet, remove the two tapite screw that attach the torque bracket to the transmission. See Figure 4.

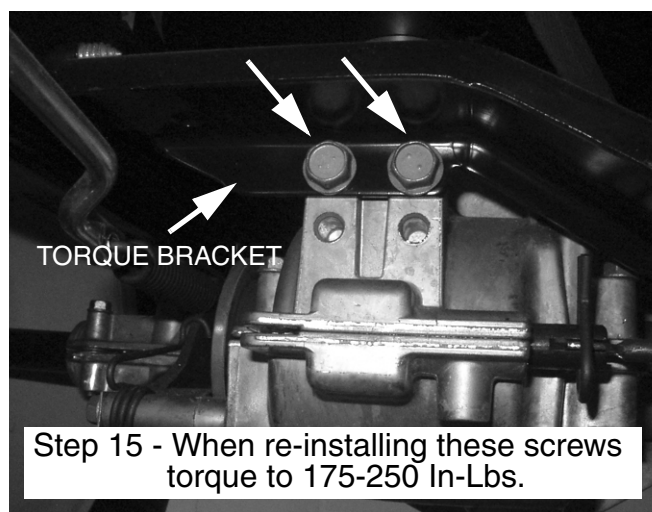

FIGURE 4

7. On the left side of the rider, using a 1/2" socket and ratchet, remove the two tapite screws that attach the torque bracket to the frame. See Figure 5A.

8. On the right side of the rider, using a 1/2" socket and ratchet remove the two tapite screws that attach the torque bracket to the frame. See Figure 5B.

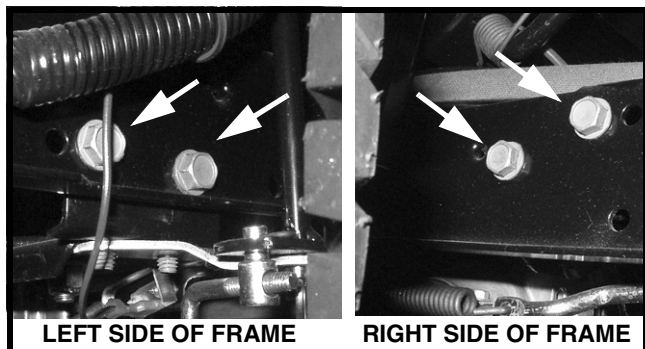

FIGURE 5A

FIGURE 5B

9. Carefully slip the torque bracket /idler assembly out from between the frame rails.

10. Using a 1/2" socket and ratchet, remove the two screws that secure the shift bracket to the old torque bracket assembly.

11. Using a 1/4" nutdriver remove and discard the two screws that secure the reverse safety spring switch and insulator to the torque bracket assembly. Discard the remaining torque bracket/idler subassembly.

NOTE: Inspect the insulator. If the insulator is cracked or damaged, replace.

Torque Bracket/Idler Assembly Instructions:

12. Assemble the "V" Type Idler Pulley, Item 12, Belt Guard, Item 8, and Flat Washers, Items 9 and 10, to the Idler Bracket, Item 1, using SEMS TapTite Screw, Item 4. The raised (higher) end of the hub on the pulley must be mounted facing the Idler Bracket. Do not tighten the 3/8" mounting screw. Leave about two threads from tight, so that the belt can be installed in a later step.

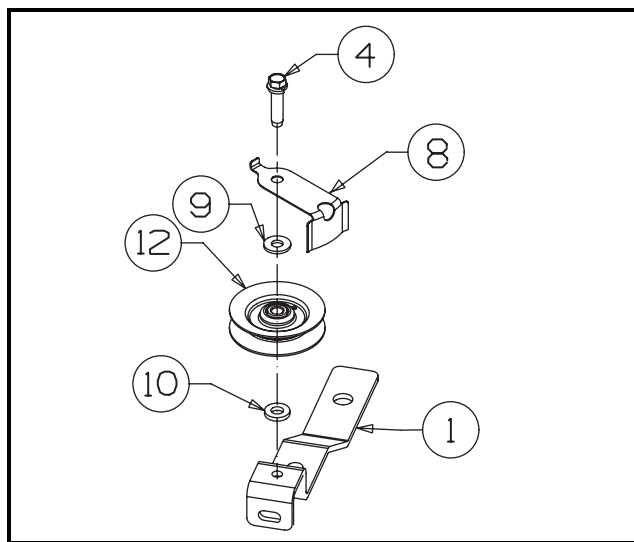

FIGURE 6

13. Assemble the new Idler Bracket, Item 1, subassembly onto the new Torque Bracket, Item 2, using the new Shoulder Screw, Item 11, and Flange Lock Nut, Item 5, as shown in Figure 7.

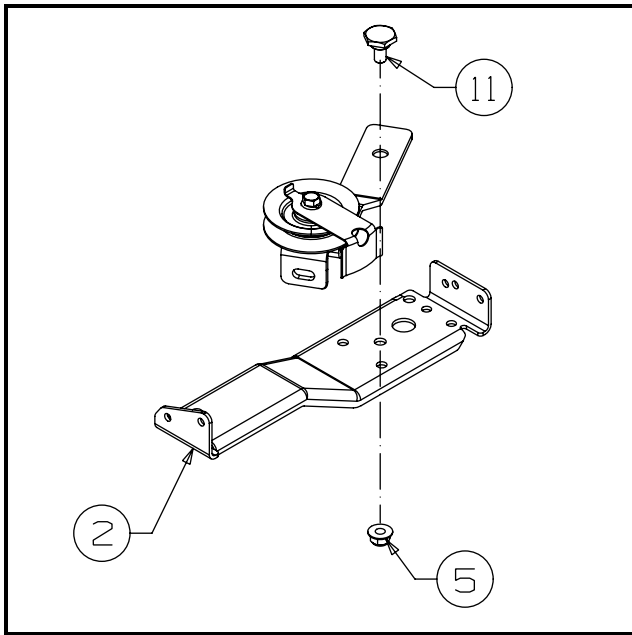

FIGURE 7

14. Re-install the reverse safety spring switch and insulator to the new Torque Bracket with the two new AB Screws, Item 3. Do not overtighten the screws, which could result in a cracked insulator and a grounded switch.

15. Re-install the shift bracket to the new Torque Bracket assembly with the hardware removed in Step 10.

Torque Bracket/Idler Assembly Installation:

16. Install the new Torque Bracket/Idler assembly into the rider in the reverse order of the **Removal Instructions**. Refer to Figure 4 for torque specifications.

NOTE: *Ensure that the transmission shifts into each gear properly in sync with the shift lever location.*

17. Re-install the upper transmission drive belt. Ensure that the belt is properly routed and set in all three pulleys and the Belt Guard is positioned so not to rub on the belt. Lightly tighten the idler pulley mounting screw.

18. Slip the Split Plastic Conduit, Item 6, onto the new Extension Spring, Item 9. Install the new spring as shown in Figure 2.

19. Check the position of the Belt Guard and readjust it's position as necessary to ensure that the belt guard does not rub the belt throughout the idler's full motion of travel from low to high speed.

20. Test run the tractor varying the speed from low to high and high to low in forward and reverse. Ensure the belt guard does not rub on the belt nor the belt is thrown off.

21. Re-install the cutting deck. Refer to the **Operator's Manual - Section 6 - Maintaining Your Tractor - Cutting Deck Removal**

22. This completes the service kit installation.

NOTES