

Service Kit 753-0907

CODE: R-467

DATE: July 17, 2001

SUBJECT: Retrofit to 42" 2 - Belt Deck

MODELS AFFECTED: 600-619 Series Manual PTO
Lawn Tractors w/ Single Belt
Deck

NOTE: Only parts identified with a reference number in Kit Breakdown View 1 are included in the deck assembly of this kit. Additional parts pictured are shown for reference purposes only.

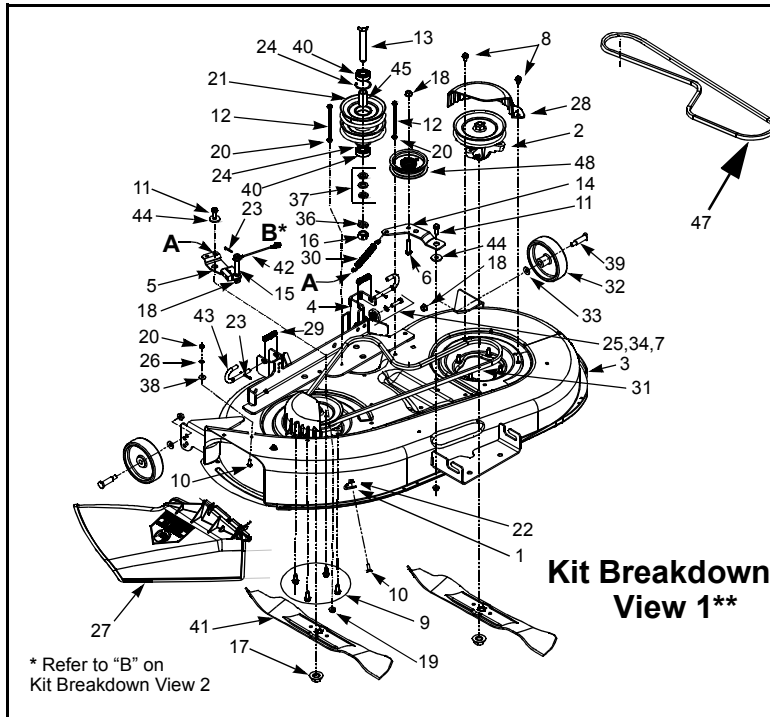

2 - Belt Deck**

See Page 2 for
2 - Belt Deck Manual PTO

Color Codes:

-0637 Powder Black
-0638 MTD Red
-0650 Red Metallic
-0665 Yardman Green
-0691 Black Jack

REF. NO.	PART NUMBER	QTY	DESCRIPTION
1	16606	1	Retainer Hook Bracket
2	618-0574	2	Spindle Assembly: 5.75 DIA
3	683-0198E	1	42 inch Deck Assembly
4	683-0254	1	Deck Hanger Bracket Assembly
5	683-0440	1	Deck Brake Assembly
6	710-0520	1	Hex Screw: 3/8-16: 1.50
7	710-0528	1	Hex Screw: 5/16-18: 1.25
8	710-0604A	4	Hex Screw: 5/16-18: .625
9	710-0650	8	Hex Screw TT: 5/16-18: .875
10	710-0751	3	Hex Screw: 1/4-20: .620: GR5
11	710-1238	2	Hex Screw: 5/16-18: .875: GR5
12	710-1830	2	Hex Screw TT: 1/4-20: 4.00
13	710-3151	1	Hex Screw: 5/8-18: 4.25
14	783-1291	1	Idler Bracket
15	711-1534	1	Hex Screw: 3/8-16: 3.27
16	712-0337	1	Hex Nut: 5/8-18
17	712-0417A	2	Hex Flange Nut: 5/8-18
18	712-0431	4	Hex Flange Lock Nut: 3/8-16
19	712-3004A	3	Lock Nut: 5/16-18
20	712-3006	4	Hex Nut: 1/4-20
21	756-1202	1	Double Pulley
22	712-3027	1	Lock Nut: 1/4-20
23	714-0470	3	Cotter Pin
24	716-3020	2	Snap Ring
25	717-1553A	1	Deck Adjustment Gear

REF. NO.	PART NUMBER	QTY	DESCRIPTION
26	726-0233	2	Push Nut
27	731-1032B	1	Discharge Chute Assembly
28	731-2486	2	Belt Cover
29	732-0306	2	Compression Spring: 1.75 LG
30	732-0470A	1	Extension Spring: 4.74 LG
31	754-0498	1	V Belt (Deck Belt)
32	734-0973	2	Deck Wheel
33	736-0105	2	Bell Washer
34	736-0119	1	Lock Washer
35	736-0140	1	Flat Washer
36	736-0158	1	Lock Washer
37	736-0162	3	Flat Washer
38	736-0270	2	Bell Washer
39	738-0373	2	Shoulder Screw
40	741-0524	2	Bearing: .625 ID x 1.57 OD
41	742-0616	2	Blade
42	746-0970	1	Brake Cable
43	747-1116	2	Deck Release Handle
44	748-0331	2	Shoulder Spacer
45	750-0932A	1	Spacer
46	756-0627B	1	Idler Pulley
47	754-0497	1	V Belt (PTO Belt)

**** NOTE:** To order a complete deck assembly only as shown in Kit Breakdown View 1 order 753-0894-xxxx (for appropriate color code see above).

NOTE: Only parts identified with a reference number in Kit Breakdown View 2 are included in this kit as loose parts. Additional parts pictured are shown for reference purposes only.

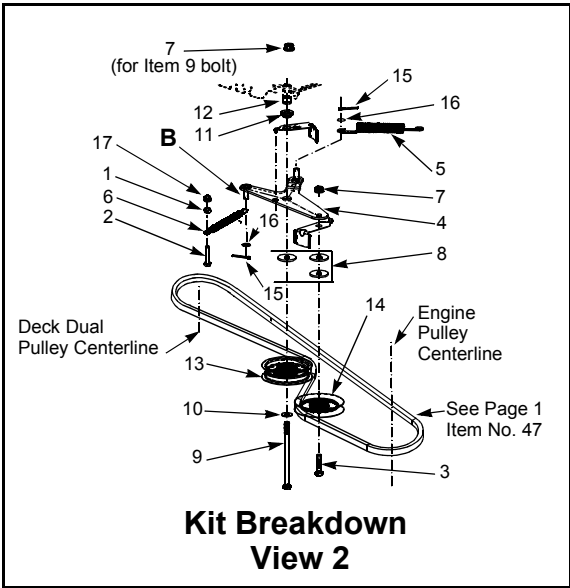

2 - Belt Deck Manual PTO

REF. NO.	PART NUMBER	QTY	DESCRIPTION
1	712-3010	1	Hex Nut: 5/16-18
2	710-3180	1	Hex Screw: 5/16-18: 1.75
3	710-0520	1	Hex Screw: 3/8 -16: 1.50
4	683-0450	1	Engagement Plate Assembly
5	732-1170	1	Extension Spring: .75 Dia: 6.75
6	732-1165	1	Extension Spring: .50 Dia: 5.0
7	712-0431	1	Hex Flange Lock Nut: 3/8-16
8	736-3039	3	Flat Washer: .406 ID: 1.5: 11GA
9	710-0831	1	Hex Screw: 3/8-16: 5.50: GR5
10	736-0300	1	Flat Washer: .406 ID: .875 OD: .059
11	738-0372B	1	Shoulder Spacer: 1.00: 3/8: 3/8
12	748-0415B	1	Spacer : .385 ID: .635 OD: 1.54
13	756-0627B	1	Flat Idler Pulley: 3.5 OD
14	756-1208	1	V Idler Pulley: 4.0 OD "A" Section
15	714-0470	2	Pin: Cotter: 1/8 x 1.25
16	736-0140	2	Wash: Flat: .385ID: .62 OD: .063
17	712-3004A	1	Nut: FlgLk 5/16-18: GR5 Side Lock
18	712-0229	1	Nut: Push: 3/8 (Not Shown)

Deck Removal and Manual PTO Retrofit Instructions

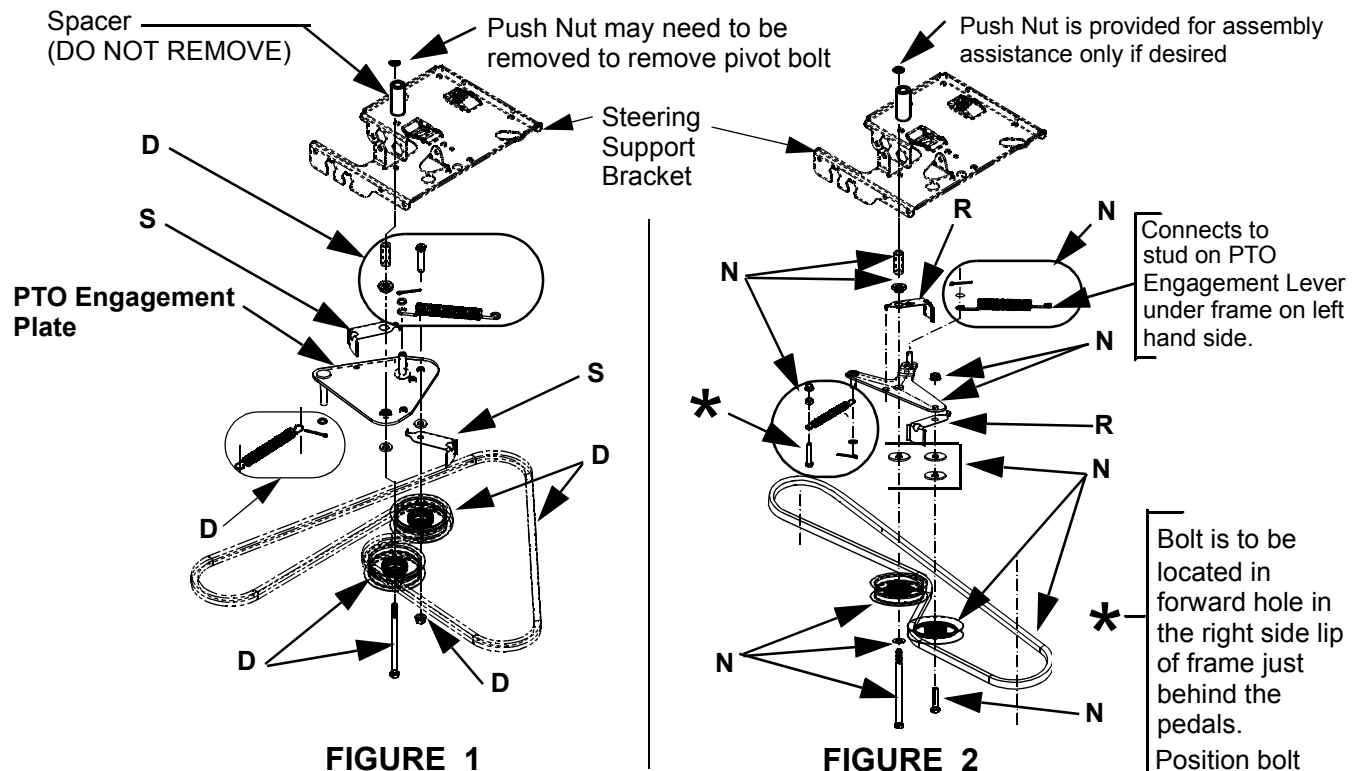

FIGURE 1
Retro Fit From
Single Belt Deck Manual PTO

LEGEND:

D - REMOVE AND DISCARD
S - REMOVE AND SAVE

FIGURE 2
To
2 - Belt Deck Manual PTO

LEGEND:

N - NEW PART SUPPLIED IN KIT
R - REUSE FROM SINGLE BELT DECK PTO HARDWARE

Deck Removal:

1. Ensure unit is off, key is removed, engine and muffler are cooled down and parking brake is "ON".
2. Place manual PTO in the "OFF" position.
3. Lower deck to lowest position.
4. Loosen engine pulley belt guides.
5. Remove belt from engine pulley.
6. Disconnect blade brake cable from PTO Engagement Plate (See Figure 1).
7. Carefully work belt off of both PTO Engagement Plate pulleys. Do not damage belt keepers that will be reused later.
8. Pull both "J" hooks at rear of deck to release rear of deck from lift links.
9. Push deck forward and lift "U" shaped adjusting deck rod up and out of forward deck hanger.
10. Remove single belt drive deck from under rider.

PTO Retrofit:

1. Remove fuel tank cap. Place a piece of plastic sheet over the opening and replace fuel cap securely.
2. Remove four (4) screws retaining fuel tank.

3. Lift fuel tank out and support on top of engine. Ensure no fuel will leak from tank.

4. From the engine compartment remove the hex flange nut that retains the long PTO Engagement Plate pivot bolt.

NOTE: Do not remove spacer from between the Steering Support Bracket and Lower Frame. The push nut may need to be removed in order to remove the PTO Engagement Plate pivot bolt.

5. Remove the single belt deck PTO hardware as shown in Figure 1. Discard those parts marked with a "D". Save the two belt keepers for reuse.

6. Install 2 - belt deck manual PTO hardware supplied as shown in Figure 2.

7. Slide 2 belt deck under retrofitted rider.

8. Reverse **Deck Removal** instructions and install deck.

NOTES