



380 K

Reservdelar

Spare parts

Ersatzteile

Pièces de rechange

Utgåva A 10 12 363-96

Édition A 5. 11-73

Ausgabe A

Flik
Sheet No.
Register
Index

4

| Bild-nr | Beställn.-nummer | Anm. |
|---------|------------------|----------------------------|
| Fig. No | Part number | Remarks |
| Abb. Nr | Best. Nr | Anm. |
| Fig. No | Node commande | Notes |
| 1 | 254 81 18-14 | N |
| 2 | 501 20 87-01 | |
| 3 | 501 27 78-01 | kpl. |
| 4 | 501 27 49-01 | |
| 5 | 501 50 20-01 | N kpl. |
| 6 | 501 14 40-01 | |
| 7 | 501 27 74-01 | |
| 8 | 501 14 36-01 | |
| 9 | 501 27 31-01 | |
| 10 | 296 52 59-16 | |
| 11 | 501 50 18-01 | N |
| 12 | 501 50 14-01 | N |
| 13 | 297 04 70-02 | |
| 14 | 501 50 17-10 | N. pr/m |
| 15 | 206 22 96-52 | |
| 16 | 501 21 22-01 | |
| 17 | 202 43 37-55 | |
| 18 | 288 81 70-01 | |
| 19 | 202 43 39-55 | |
| 20 | 501 21 27-01 | |
| 21 | 501 21 67-01 | |
| 22 | 501 22 43-01 | |
| 23 | 501 24 82-01 | |
| 24 | 501 28 62-01 | |
| 25 | 501 46 24-01 | N |
| 26 | 501 50 29-01 | N |
| 27 | 501 28 44-01 | |
| 28+100 | 501 28 85-01 | |
| 29 | 501 25 21-01 | |
| 30 | 501 40 74-01 | |
| 31 | 200 63 82-42 | |
| 32 | 501 27 92-01 | |
| 33 | 202 43 29-55 | |
| 34 | 284 71 70-01 | |
| 35 | 501 40 88-01 | |
| 36 | 501 21 66-02 | Ch. CJ 7 Y WKA 225 T 36 |
| 37 | 501 21 66-04 | |
| 38 | 202 43 35-55 | |
| 39 | 288 81 70-01 | |
| 39+43 | 501 25 02-01 | kpl. |
| 40 | 501 28 93-01 | |
| 41 | 501 28 47-01 | |
| 42 | 501 05 64-01 | |
| 43 | 501 25 02-02 | Class A |
| | 501 25 02-03 | Class B |
| | 501 25 02-04 | class c |
| | 501 25 02-05 | Class D |
| | 501 25 02-06 | Class E |
| 44 | 501 15 28-10 | |
| 45+46 | 501 22 62-02 | |
| 48 | 293 11 95-04 | |
| 47 | 501 50 04-01 | N |
| 48 | 501 27 37-01 | |
| 49 | 501 50 01-01 | N |
| 50 | 501 50 73-01 | N kpl. |
| 51 | 501 42 36-01 | |
| 52 | 501 50 07-01 | N |
| 53 | 501 50 08-01 | N |
| 54 | 202 43 31-55 | |
| 55 | 281 61 81-01 | |
| 56 | 501 50 06-01 | N |
| 57 | 258 11 32-54 | |
| 58 | 501 28 64-01 | |
| 59 | 501 50 05-01 | N |
| 60 | 501 41 75-03 | N |
| 61 | 501 25 09-01 | |
| | 501 41 06-01 | |
| | 501 27 12-01 | |
| | 501 28 58-01 | |
| 65 | 501 25 10-01 | |
| 66 | 204 13 13-09 | |
| 67 | 202 43 37-44 | |
| 68 | 281 61 82-01 | |

| Bild-nr | Beställn.-nummer | Anm. |
|----------|------------------|---------|
| Fig. No. | Part number | Remarks |
| Abb. Nr | Best. Nr | Anm. |
| Fig. No. | Node commande | Notes |
| 69 | 202 63 35-44 | |
| 70 | 231 42 05-42 | |
| 71 | 250 93 14-41 | |
| 72 | 501 42 37-01 | |
| 73 | 501 42 35-01 | |
| 74 | 282 51 95-07 | |
| 75 | 501 42 40-01 | |
| 76 | 501 42 41-01 | |
| 77 | 501 44 71-01 | |
| 78 | 501 22 49-01 | |
| 79 | 501 42 29-01 | |
| 80 | 501 43 72-01 | |
| 81 | 282 53 77-07 | |
| 82 | 501 41 42-01 | |
| 83 | 501 44 46-01 | |
| 84 | 501 28 59-01 | |
| 85 | 121 06 89-01 | N |
| 86 | 206 22 85-11 | N |
| 87 | 501 27 82-01 | |
| 88 | 501 43 14-01 | |
| 89 | 501 27 62-01 | |
| 90 | 202 63 27-54 | |
| 91 | 501 27 63-01 | |
| 92 | 501 28 69-01 | |
| 93 | 501 27 13-01 | |
| 94 | 501 50 30-01 | N kpl. |
| 95 | 501 41 02-01 | |
| 96 | 122 72 07-01 | |
| 97 | 501 27 07-01 | |
| 98 | 112 70 43-02 | |
| 99 | 290 12 30-01 | |
| 100+28 | 501 42 68-02 | |
| 101 | 501 28 65-01 | |
| 102 | 296 52 59-16 | |
| 103 | 501 08 17-01 | |
| 104 | 501 75 55-01 | |
| 105 | 501 05 95-10 | prim |
| 106 | 501 28 14-10 | prim |
| 107 | 501 43 00-01 | |
| 108 | 501 24 40-01 | |
| 109 | 501 28 46-01 | |
| 110 | 281 61 65-01 | |
| 111 | 280 42 81-01 | |
| 112+107 | 206 22 93-52 | |
| 113 | 501 50 74-01 | N |
| 114 | 501 42 13-01 | |
| 115 | 501 40 16-01 | |
| 116 | 289 52 05-01 | |
| 117 | 501 42 14-01 | |
| 118 | 250 12 69-01 | |
| 119 | 299 89 42-45 | |
| 120 | 501 42 46-01 | |
| 121 | 501 40 89-01 | |
| 122 | 501 40 27-01 | |
| 123 | 501 40 72-01 | |
| 124 | 501 25 79-01 | |
| 125 | 501 26 49-01 | |
| 126 | 501 21 81-01 | |
| 127 | 501 40 24-01 | |
| 128 | 230 41 42-01 | |
| 129 | 501 44 02-01 | N |
| 130 | 501 40 22-01 | |
| 131 | 501 27 83-01 | |
| 132 | 501 40 95-01 | |
| 133 | 501 40 29-03 | |
| | 501 40 19-01 | N kpl. |
| | 501 40 18-01 | |
| 134 | 288 81 70-01 | |
| 135 | 206 23 31-42 | |
| 136 | 501 50 10-01 | N |
| 137 | 202 43 33-55 | |
| 138 | 501 41 31-01 | |
| 139 | 501 27 99-01 | |

| Bild-nr | Beställn.-nummer | Anm. |
|----------|------------------|---------|
| Fig. No. | Part number | Remarks |
| Abb. Nr | Best. Nr | Anm. |
| Fig. No. | Node commande | Notes |
| 140 | 501 28 28-01 | |
| 141 | 501 50 45-01 | N |
| 142 | 501 14 13-01 | |
| 143 | 208 23 25-11 | |
| 144 | 501 14 11-01 | |
| 145 | 293 11 95-39 | |
| 146 | 501 41 00-01 | |
| 147 | 501 50 27-01 | N |
| 148 | 501 50 39-01 | N |
| 149 | 290 05 50-01 | |
| 150 | 501 50 35-01 | N |
| | 501 50 34-01 | N kpl. |
| 151 | 501 14 08-01 | |
| 152 | 293 11 95-39 | |
| 153 | 501 50 38-01 | N |
| 154 | 206 33 28-11 | |
| 155 | 501 14 33-01 | |
| 156 | 501 14 34-01 | |
| 157 | 501 14 35-01 | |
| 158 | 501 26 49-01 | |
| 159 | 501 50 28-01 | N |
| 160 | 501 14 94-01 | |
| 161 | 501 14 68-01 | |
| 162 | 501 14 71-01 | |
| 163 | 501 50 43-01 | N |
| 164 | 284 71 91-01 | N |
| 165 | 250 83 18-12 | N |
| 166 | 200 64 63-12 | N |
| 167 | 250 12 47-12 | |
| 168 | 206 22 89-11 | |
| 169 | 501 14 12-01 | |
| 170 | 501 50 41-01 | N |
| 200 | 501 22 30-01 | |
| 201 | 502 01 22-01 | |
| 202 | 501 42 69-01 | |
| 203 | 501 48 50-01 | N |
| 204 | 501 50 24-01 | N |
| 205 | 501 22 15-01 | |
| 206 | 501 22 14-01 | |
| 207 | 501 22 13-01 | |
| 208 | 501 22 12-01 | |
| 209 | 501 22 24-01 | |
| 210 | 501 23 88-01 | |
| 211 | 501 22 29-01 | |
| 212 | 501 22 30-01 | |
| 214 | 501 22 00-01 | |
| 215 | 501 22 03-01 | |
| 216 | 501 22 01-01 | |
| 217 | 501 22 23-01 | |
| 218 | 501 22 25-01 | |
| 219 | 501 22 20-01 | |
| 220 | 501 22 08-01 | |
| 221 | 501 22 09-01 | |
| 222 | 501 22 10-01 | |
| 223 | 501 22 11-01 | |
| 224 | 501 22 02-01 | |
| 225 | 501 22 21-01 | |
| 226 | 501 48 52-01 | N |
| 227 | 501 22 18-01 | |
| 228 | 501 25 46-01 | |
| 229 | 501 22 04-01 | |
| 230 | 501 22 05-01 | |
| 231 | 501 22 19-01 | |
| 232 | 501 22 74-01 | |
| 233 | 501 42 71-01 | |
| 234 | 501 22 17-01 | H |
| 235 | 501 26 90-01 | L |
| 236 | 501 26 85-01 | L |
| 237 | 501 22 32-01 | |
| 238 | 501 42 73-01 | |
| 239 | 501 26 89-01 | H |
| 240 | 501 22 30-01 | |
| 241 | 501 28 92-01 | |

N
Ny reservdel
New spare part
Neues Ersatzteil
Nouvelle pièce

Packn.sats 5012238-02
Set of gaskets 5012238-02
Dichtungssatz 5012238-02
Jeu de joints 5012238-02

1 5014235-01
1 Bakra handtag kpl.
Rear handle compl.
Hinterer Handgriff kpl.
Poignée derrière compl.

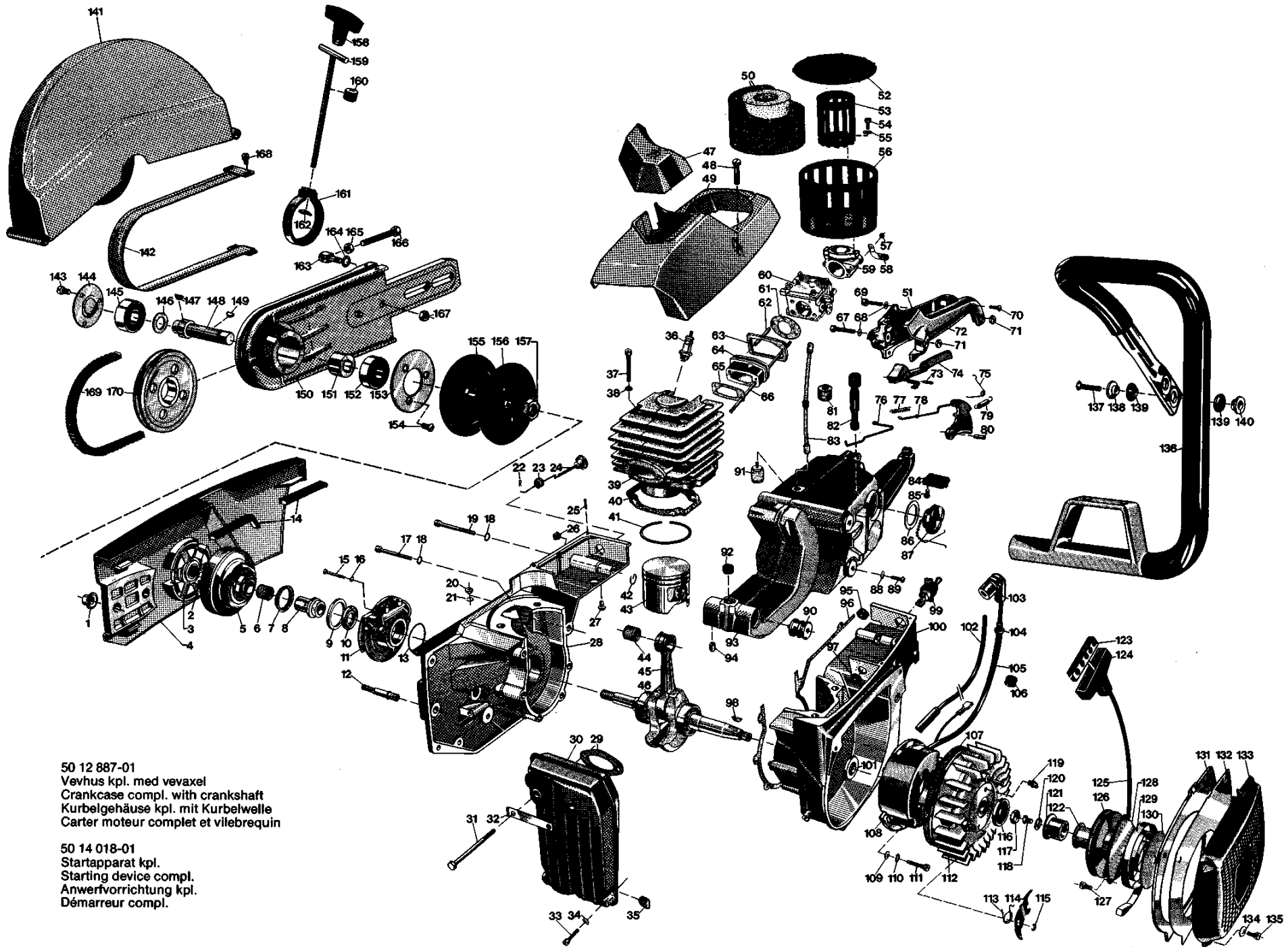

50 12 887-01
 Vevhus kpl. med vevaxel
 Crankcase compl. with crankshaft
 Kurbelgehäuse kpl. mit Kurbelwelle
 Carter moteur complet et vilebrequin

50 14 018-01
 Startapparat kpl.
 Starting device compl.
 Anwerfvorrichtung kpl.
 Démarreur compl.

