

Ref #	Part Number	Qty	Description
1	530035007		Clip-Throttle Shaft
2	530035003		Cover-Metering Diaphragm
3	530035004		Cover-Fuel Pump
4	530035005		Shaft-Throttle
5	530035006		Shutter-Throttle
6	530035008		Valve-Inlet Needle
7	530035009		Gasket-Fuel Pump
8	530035012		Gasket-Circuit Plate
9	530035011		Gasket-Metering Diaphragm
10	530035013		Diaphragm-Fuel Pump
11	530035014		Diaphragm-Metering
12	530035015		Screw-Throttle Shutter
13	530035016		Screw-Metering Lever Pin
14	530035019		Screw-Idle Adj.
15	530035018		Screw-Circuit Plate
16	530035021		Screw-Metering Cover
17	530035017		Screw-Pump Cover
18	530035023		Spring-Idle Adj. Needle
19	530035022		Spring-Idle Adj. Screw
20	530035025		Spring-Metering Lever
21	530035024		Spring-Throttle Return
22	530035026		Needle-Idle
23	530035027		Screen-Inlet
24	530035028		Pin-Metering Lever
25	530035029		Plate-Circuit (Standard)
25	530035044		Plate-Circuit (High altitude above 5,000 feet)
26	530035031		Lever-Metering
	530035032		Kit-Repair (Inc.6,7,8,9,10,11,12,15,20,23, 24,26)

20D Gas Saw Page 2 of 6
 CARBURETOR 35001

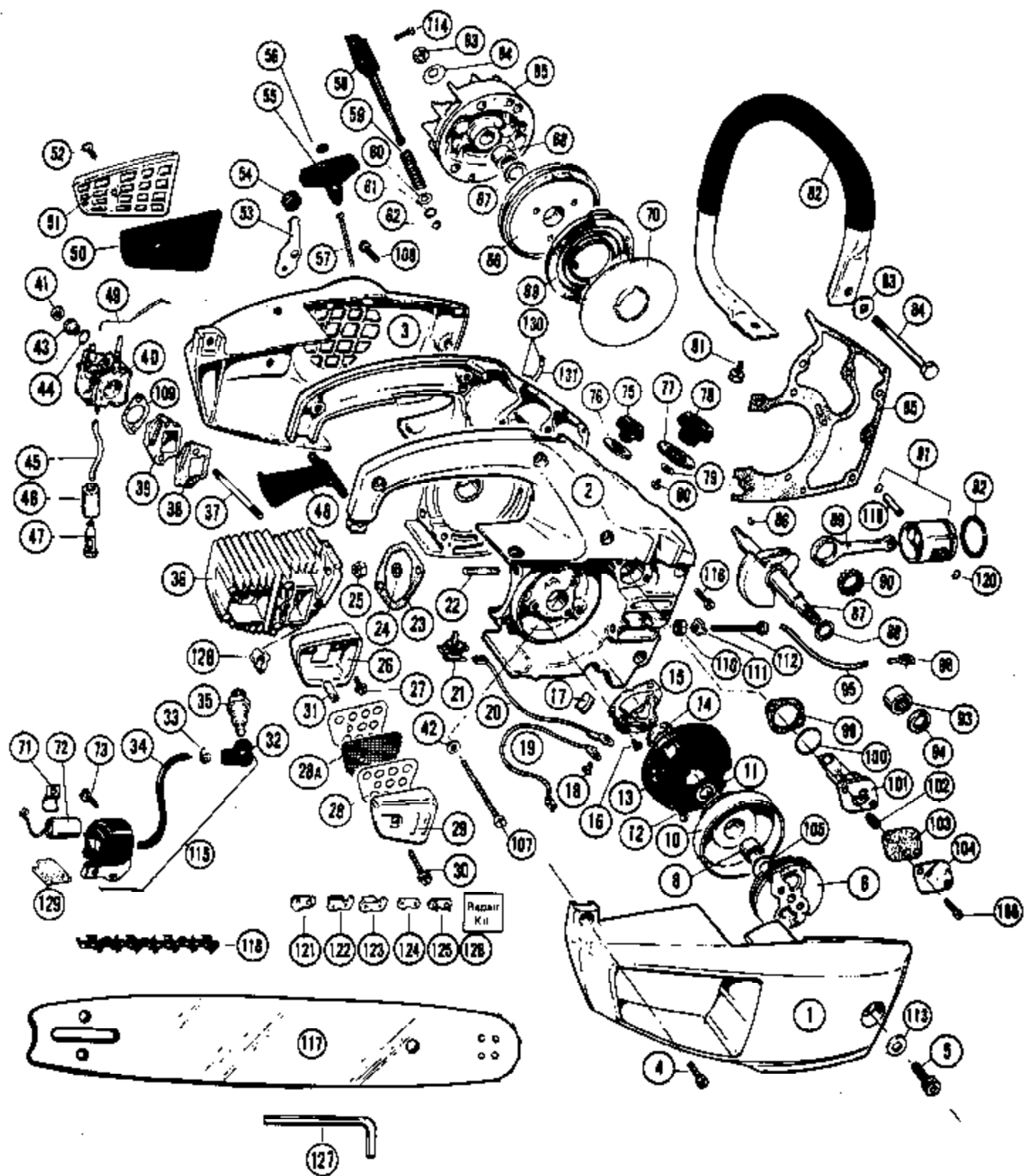

Ref #	Part Number	Qty	Description
1	530011219	1	Barclamp
2	530010209	1	Crankcase Ass'y. Inc.22,75-76,85,93-94, 110-112,130-131
3	530011216	1	Fan Housing
4	530015174	1	Screw-Bar Clamp-rear
5	530015183	1	Barclamp Screw
6	530010158	1	Clutch Ass'y.
8	530032028	1	Bushing-Clutch Drum
10	530048017	1	Drum & Sprocket Ass'y. Inc. Ref. 8
11	530023519	1	Spacer-Clutch (inside)
12	530015166	2	Screw-Point Cover
13	530023503	1	Cover-Breaker Points
14	530019061	1	Seal-Breaker Points Cover
15	530039054	1	Breaker Points Ass'y.
16	530015004	2	Screws-Breaker Points Base
17	530633560	1	Felt-Cam Wiper
18	530625712	1	Screw-Terminal
19	530039055	1	Lead Wire-Points To Coil
20	530039056	1	Lead Wire-Points To Switch
21	530023504	1	Stop Switch Ass'y.
22	530001674	2	Stud-Cylinder Mounting
23	530019068	1	Gasket-Cylinder
24	530001677	2	Lockwasher-Cylinder
25	530001660	2	Nut-Cylinder
26	530023521	1	Body-Muffler
27	530015178	1	Screw-Muffler Body
28	530023533	2	Baffle-Muffler
28A	530023534		Screen-Spark Arresting
29	530023523	1	Cover-Muffler
30	530015169	1	Screw-Muffler Cover
31	530023535	1	Spacer-Muffler
32	530003933	1	Boot-Spark Plug
33	530003934	1	Connector-Spark Plug
34	530039057	1	Lead-High Tension
35	530030005	1	Spark Plug
36	530011224	1	Cylinder Ass'y. Inc. Ref. 37
37	530015172	2	Stud-Carburetor Mount
38	530019069	1	Gasket-Carburetor Adapter
39	530023515	1	Adapter-Carburetor
40	530035001		CARBURETOR WA-18
	535035001	1	SCREW,MOTOR
41	530015064	2	Nut-10-24
42	530019072		Washer-Fiber
43	530023375	1	Spacer-Choke
44	530015146	2	Wave Washer
45	530021014	1	Line-Fuel (Bulk No. 8133)
46	530023364	1	Filter Felt-Fuel Pick-up
47	530023363	1	Weight-Fuel Pick-up
48	530023505		Trigger-Throttle
49	530023506	1	Wire-Throttle
50	530023502	1	Air Filter (Gray)
51	530011217	1	Cover-Air Filter
52	530015164	1	Screw-Cover Air Filter
53	530023525	1	Shutter-Choke
54	530023541	1	Bumper-Choke Lever
55	530042025	1	Handle-Starter Rope
56	530023496	1	Plug-Starter Handle

20D Gas Saw Page 4 of 6

CHAINSAW ASSEMBLY

Ref #	Part Number	Qty	Description
57	530042035	1	Rope-Starter
58	530023513	1	Plunger-Oil Pump
59	530023514	1	Spring-Pump Plunger
60	530015171	1	Washer-Pump Plunger
61	530001952	1	O-Ring-Pump Plunger (Top)
62	530019066	1	O-Ring-Pump Plunger (Bottom)
63	530626605	1	Nut-Flywheel
64	530015127	1	Washer-Ramp Conical
65	530039058	1	Flywheel Ass'y.
66	530010163	1	Starter Pulley Ass'y. Inc. Ref. 68
67	530015177	1	Thrust Washer
68	530032029	1	Bearing-Starter Pulley
69	530042029	1	Spring-Starter Recoil
70	530042031	1	Plate-Starter Pulley Back-up
71	530039053	1	Clamp-Condenser
72	530039052	1	Condenser
73	530015128	2	Screw-Sems (Coil)
75	530023741	1	Oil Cap Ass'y. Inc. Ref. 76
76	530019071	1	Gasket-Oil Cap
77	530019048	1	Gasket-Gas Cap
78	530010154	1	Gas Cap Ass'y. Inc. Ref. 77-79-80
79	530001520	1	Washer
80	530001726	1	Screw
81	530015176	1	Screw
82	530022096	1	Handlebar
83	530015151	1	Washer-1/4 (Handlebar, Top)
84	530015175	1	Screw
85	530019062	1	Gasket-Crankcase
86	530015126	1	Woodruff Key
87	530022099	1	Crank Shaft
88	530032027	2	Washer-Crankshaft Thrust
89	530022098		Connecting Rod
90	530032025	12	Bearings-Crank Pin Roller
91	530011226	1	Piston Ass'y. Inc. Ref. 119-120
92	530023495	1	Piston Ring
93	530032026	2	Bearing-Crankshaft
94	530019059	2	Seal-Crankshaft
95	530021017	1	Line-Impulse (Bulk No. 8133)
98	530022102	1	Check Valve
99	530019064	1	Gasket-Oil Pump Body
100	530019063	1	O-Ring-Oil Pump Body
101	530022097	1	Oil Pump Body Ass'y.
102	530023511	1	Filter-Oil Pump
103	530019065	1	Gasket-Oil Pump Cover
104	530023512	1	Cover-Oil Pump
105	530015173	1	Thrust Washer (Outside)
106	530001643	2	Screws
107	530015167	1	Screw
108	530015163	1	Screw
109	530019045	1	Gasket-Carburetor
110	530015135	1	Nut-Adjusting Screw
111	530023492	1	Pin-Bar Adjusting
112	530015185	1	Screw-Bar Adjusting
113	530015149	1	Washer-Barclamp Screw
114	530001714	1	Screw-Oil Plunger Lock
115	530039051	1	Coil & Lamination Ass'y. Inc. 32 - 34

20D Gas Saw Page 5 of 6

CHAIN SAW ASSEMBLY

Ref #	Part Number	Qty	Description
116	530015168	10	Screws-Crankcase
117	530044101	1	Bar-12"
117	530044099	1	Bar-14"
118	530051046	1	Chain-12" Bar
118	530051041	1	Chain-14" Bar
119	530032024	1	Wrist Pin
120	530015162	2	Retaining Ring-Wrist Pin
121	530052044	AR	Drive Link-Chain
122	530052046	AR	Cutter LH-Chain
123	530052045	AR	Cutter RH-Chain
124	530052038	AR	Tie Strap-Chain
125	530052039	AR	Pre-set Tie Strap-Chain
126	052043	AR	Repair Kit-Chain
127	530031017	1	Bar Wrench
128	530015195	1	Clip-High Tension lead (1st fin-bottom)
129	530023609	1	Coil Insulator
130	530022132	1	Vent Plug Ass'y.
131	530021023	1	Line-Oil Tank Vent (7" Long Cut from No. 8133 Tubing)

20D Gas Saw - Page 6 of 6
 CHAIN SAW ASSEMBLY