



Ref #	Part Number	Qty	Description
1	33942	0	Cylinder Assy. (2-5/16" Bore)
2	26727	0	Pin, Dowel
3	27642	0	Plug, Drain
3A	27642	0	Plug, Drain
4	29183	0	Seal, Oil
5	31444A	0	Valve, Intake (Standard) (Long Life)
5	31483	0	Valve, Intake (1/32" oversize)
6	31445A	0	Valve, Exhaust (Standard) (Long Life)
6	31483	0	Valve, Intake (1/32" oversize)
7	31671	0	Cap, Upper valve spring
8	31672	0	Spring, Valve
9	31673	0	Cap, Lower valve spring
11	31274	0	Crankshaft Assy.
12	29783	0	Pin, Crankshaft gear
13	27613	0	Gear, Crankshaft
14	31761	0	Piston & Pin Assy. (Standard) (2-5/16")
14	32662	0	Piston & Pin Assy. (.010 oversize)
14	32663	0	Piston & Pin Assy. (.020 oversize)
15	27565	0	Ring Set, Piston (Standard) (2-5/16")
15	27566	0	Ring Set, Piston (.010 oversize)
15	27567	0	Ring Set, Piston (.020 oversize)
16	20381	0	Ring, Piston pin retaining
17	30963B	0	Rod Assy., Connecting
18	26706	0	Bolt, Connecting rod
19	28594	0	Dipper, Oil
20	27573	0	Nut, Connecting rod bolt
21	33149	0	Camshaft (Compression release)
22	27241	0	Lifter, Valve
23	30756B	0	Cover, Cylinder
25	27625	0	Plug, Oil filler
26	29673	0	Gasket, Filler plug
27	27677	0	Gasket, Cylinder cover
28	30564	0	Screw
29	30981	0	Bushing, Crankshaft
30	650168	0	Washer, Flat
30	650675	0	Washer, Flat
31A	650489	0	Screw
31	650489	0	Screw
32	29953B	0	Gasket, Cylinder head
33	30579	0	Head, Cylinder
34	26073	0	Washer, Connecting rod bolt
35	6021	0	Screw
35	650694	0	Screw, Hex hd. cap, 5/16-18 x 2
35	650695	0	Screw, Hex hd. cap, 5/16-18 x 2-1/4 (Grade 8
37	33636	0	Plug, Spark (Champion J-8 or equivalent)
38A	27234	0	Gasket, Breather cover
39A	27666	0	Breather Assy.
40	27233	0	Element, Breather
41	27667	0	Cover, Breather box
42	650128	0	Screw
43	32446	0	Grommet, Breather tube
44	32447	0	Tube, Breather
45	26754	0	Gasket, Exhaust
46	28416	0	Pipe, Intake
47	650664	0	Screw, Phil. fil. hd. Sems, 1/4-20 x 1-19/32
48	30646	0	Screw, Phil. fil. hd. Sems, 1/4-20 x 1-3/8
48	650517	0	Screw, Fil. flex hd. self-locking, 1/4-20 x
48	650664	0	Screw, Phil. fil. hd. Sems, 1/4-20 x 1-19/32

Ref #	Part Number	Qty	Description
50	650708	0	Washer, Flat 5/16"
50	8303	0	Lockwasher
53	650152	0	Screw
53	650684	0	Screw, Fil. hd mach., 8-32 x 5/16
58	31858	0	Link, Throttle
59	31510	0	Lever, Governor
63A	31334	0	Rod, Governor
64	30658	0	Baffle, Blower housing
65	30200	0	Screw
65	650561	0	Screw
66	31345	0	Plate, Identification
67	29309	0	Stud, Drive
68	650548	0	Screw, Hex washer hd., 8-32 x 5/16
69	29212	0	Screw
70	30655A	0	Housing, Blower
71	650490	0	Washer, Belleville
72	650607	0	Nut, Flywheel
73	29716	0	Screw
74	16645	0	Lockwasher
75	30747	0	Clip, Shorting
76	30596	0	Decal, Name & H.P. (2-1/4 H.P.)
76	30597	0	Decal, Name & H.P. (3 H.P.)
76	30612	0	Decal, Name & H.P. (3-1/2 H.P.)
76	30631	0	Decal, Name & H.P. (2-1/2 H.P.)
76	31328	0	Decal, Name & H.P. (4 H.P.)
76A	33306	0	Decal, Mini-Bike (2-1/2 H.P.)
76A	33307	0	Decal, Mini-Bike (3 H.P.)
76A	33308	0	Decal, Mini-Bike (3-1/2 H.P.)
78	27272	0	Gasket, Air cleaner
78A	30767	0	Spacer, Air cleaner
81A	31700	0	Element, Air cleaner
83	28820	0	Screw
83	650163	0	Screw, Fil. hd. Sems, 10-32 x 7/8
83	650399	0	Screw, Phil. fil. hd. Sems, 10-32 x 5/8
83	650709	0	Screw
84	30564	0	Screw
84	6201	0	Screw
84	6202	0	Screw
84	650551	0	Screw, Hex hd. cap, 1/4-28 x 1-1/4
87	26756	0	Gasket, Carburetor
89	29752	0	Nut
90	31432	0	Bracket, Speed limit
91	27793	0	Clip, Conduit
92	28942	0	Screw
95	28277	0	Washer, Flat
106	30574	0	Shaft, Mechanical governor
107A	30590A	0	Washer, Flat
107	30591	0	Gear Assy., Governor
108	29193	0	Ring, Retaining
109	30588A	0	Spool, Governor
110	28212	0	Spacer
113	30688	0	Screw, Hex hd. Sems, 1/4-20 x 1/2
113	650306	0	Screw, Hex hd. cap, 1/4-20 x 1/2
113	650561	0	Screw
115	26027	0	Cap, Fuel filler (Special bayonet type)
115	30998B	0	Cap, Fuel filler (Red Plastic) (Sno Proof)
115	32387A	0	Cap, Fuel filler (Charcoal Plastic) (Spurt
115	33032	0	Cap, Fuel filler (Red Plastic) (Spurt

Ref #	Part Number	Qty	Description
	115 410144B	0	Cap, Fuel filler (White Plastic) (Std.)
	116 650556	0	Screw
	116 650665	0	Screw
	116 650697	0	Screw, Hex hd. cap, 5/16-18 x 2-1/2
	117 28837	0	Strainer & Fitting
	117B 29683	0	Strainer & Shut-off
	117B 32961	0	Valve, Fuel shut-off
	118 29774	0	Line, Fuel (Braided 8.25")
	118 30705	0	Line, Fuel (Braided 16")
	118 30962	0	Line, Fuel (Braided 32")
	119 28819	0	Spring, Fuel line
	119A 31778	0	Spring, Coil
	120 650128	0	Screw
	121 29745	0	Extension, Blower housing
	122 31871	0	Decal, Air cleaner
	126 30322	0	Nut & Lockwasher
	129 27247	0	Key, Flywheel
	130 32576	0	Seal, Snow guard
	131 31680	0	Guard, Starter
	132 31875	0	Baffle, Heat
	133 28763	0	Screw, Hex washer hd. thread-forming, 10-24
	137 31373	0	Spacer, Carburetor
	160 31692	0	Body, Air cleaner
	161 31714	0	Decal, Instruction
	161 32078	0	Decal, Instruction
	161 33320	0	Decal, Instruction Spec. Nos. 25205H, 212H,
	166 33356	0	Terminal, Ground
	167 29117	0	Screw
	167 30688	0	Screw, Hex hd. Sems, 1/4-20 x 1/2
	167 650561	0	Screw
	167 650643	0	Screw
	168 27675	0	Nut, Conduit
	176 650116	0	Nut, Lock
	178 30200	0	Screw
	179 28539	0	Ring, Retaining (All ball bearing models)
	180 28537	0	Washer, Flat
	181 28458	0	Bearing, Ball All ball bearing models except
	183 31861	0	Clip, Shorting
	184 29443	0	Clip, Fuel line
	185 31335	0	Clamp, Governor lever
	203 30865	0	Link, Bellcrank
	204 27275	0	Clip, Hi-tension wire
	209A 32187	0	Decal, Super-start
	209 32179	0	Decal, Super-start
	213 30595	0	Decal, Ezee-start
	214 650518	0	Lockwasher, No. 10
	216 730127	0	Cleaner Assy., Air (Poly)
	217 730512	0	Kit, Pre-cleaner
	218 31668	0	Bag, Pre-cleaner
	219 31667	0	Spring, Pre-cleaner bag
	221 26460	0	Clamp, Fuel line
	222 30980	0	Bushing, Crankshaft
	231 30968	0	Nipple, Oil (2-1/2")
	231 32678	0	Nipple, Oil drain
	232 30969	0	Cap, Oil drain
	233 28250	0	Decal, H.P. (3 H.P.)
	233 30077	0	Decal, H.P. (3-1/2 H.P.)
	233 31427	0	Decal, H.P. (2-1/2 H.P.)

Ref #	Part Number	Qty	Description
234	590417	0	Screen, Starter cup
234A	590416	0	Cup, Starter
235	28942	0	Screw
235	30200	0	Screw
238	28545	0	Grommet, Plastic
243	30879	0	Bracket, Toggle switch
244	610164	0	Switch, Toggle
257	631021	0	Inlet Needle, Seat & Clip Assy.
259	30547A	0	Contact Assy., Breaker
260	30548A	0	Condenser
261A	631134	0	Carburetor
262	610690A	0	Magneto, Tecumseh
263	590420	0	Starter, Rewind
264	33233	0	Gasket Set

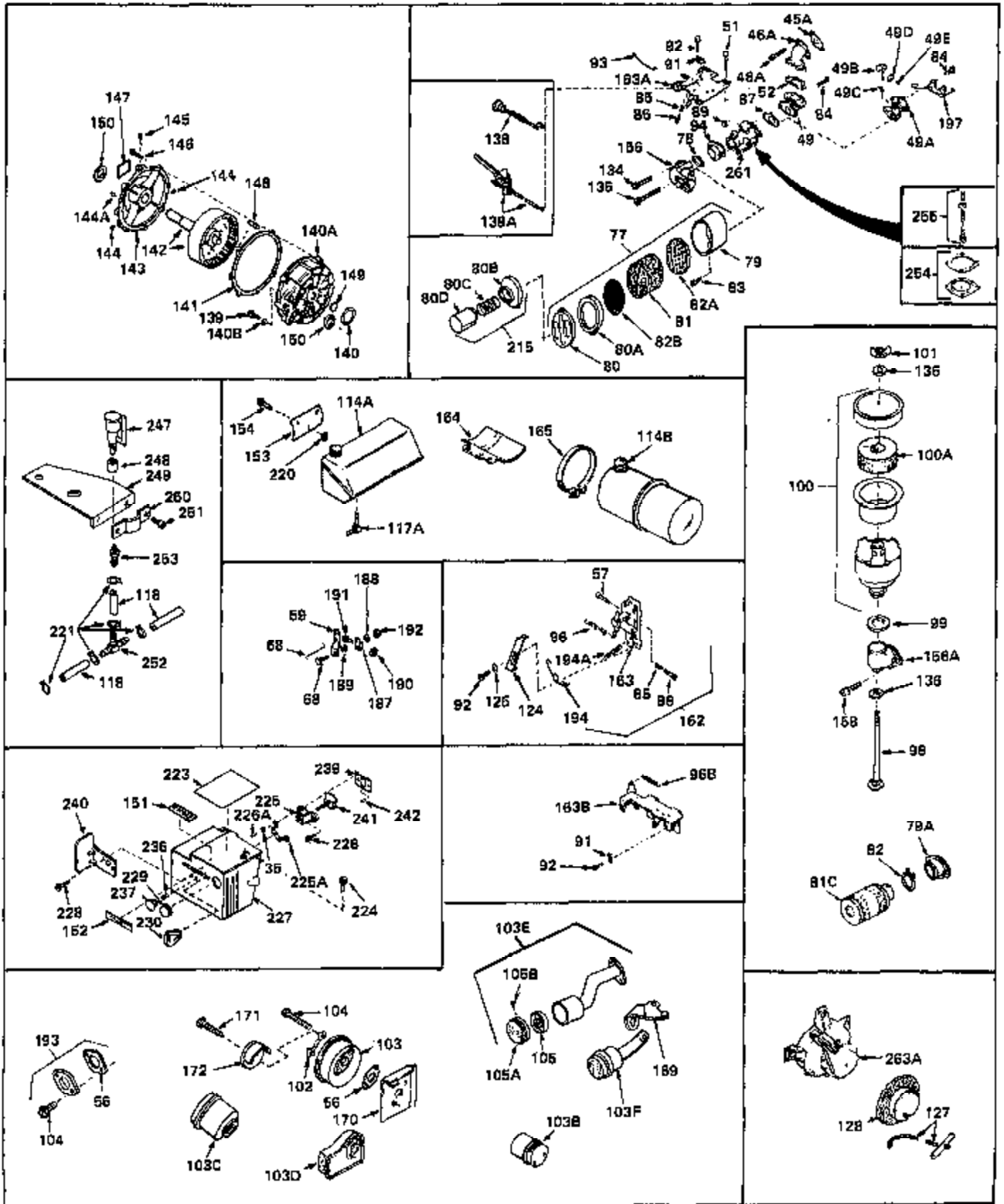

Ref #	Part Number	Qty	Description
	36 8269	0	Washer
	45A 30188	0	Gasket, Intake pipe
	48A 650451	0	Screw
	51 650454	0	Screw, Fil. flex hd. 1/4-20 x 3/4
	57 28942	0	Screw
	57 30091	0	Screw, Hex slotted washer hd., 8-32 x 1/2
	57 30200	0	Screw
	59 31510	0	Lever, Governor
	68 650548	0	Screw, Hex washer hd., 8-32 x 5/16
	77 31545	0	Cleaner Assy., Air
	78 27272	0	Gasket, Air cleaner
	80D 450124	0	Bag, Pre-cleaner
	80C 450150	0	Spring, Pre-cleaner
	82A 29962	0	Screen, Air cleaner
	83 28820	0	Screw
	83 650163	0	Screw, Fil. hd. Sems, 10-32 x 7/8
	83 650399	0	Screw, Phil. fil. hd. Sems, 10-32 x 5/8
	83 650709	0	Screw
	84 30564	0	Screw
	84 6201	0	Screw
	84 6202	0	Screw
	84 650551	0	Screw, Hex hd. cap, 1/4-28 x 1-1/4
	85 28564	0	Spring, Compression
	85 31342	0	Spring, Compression
	85 32924	0	Spring, Compression
	86 29500	0	Screw, Fil. hd. mach., Sems, 8-32 x 3/4
	86 650549	0	Screw
	86 650688	0	Screw, Hex hd., 10-32 x 1-5/16" (Drilled
	87 26756	0	Gasket, Carburetor
	89 29752	0	Nut
	91 27793	0	Clip, Conduit
	92 28942	0	Screw
	96B 31426	0	Spring, Extension
	101 9577	0	Nut, Wing, 10-24
	102 30083	0	Plate, Locking
	103F 33288	0	Muffler
	103C 29633	0	Muffler
	104 27182	0	Screw, Hex hd. cap, 1/4-20 x 3-3/8
	104 650253	0	Screw, Hex hd. cap, 1/4-20 x 2-1/4
	104 650327	0	Screw, Fil slotted hd. Sems, 114-20 x 2-1/2
	104 650493	0	Screw, Hex hd. Sems, 1/4-20 x 1-3/4
	104 650561	0	Screw
	104 650599	0	Screw, Hex hd. cap, Sems, 1/4-20 x 1-1/2
	104 650795	0	Screw, Hex hd. cap, Sems, 1/4-20 x 2-5/16
	105A 33172	0	Cover, Muffler
	105 33171	0	Screen, Muffler
	105B 650578	0	Screw
	117A 28584	0	Strainer & Elbow
	118 29774	0	Line, Fuel (Braided 8.25")
	118 30705	0	Line, Fuel (Braided 16")
	118 30962	0	Line, Fuel (Braided 32")
	124 33966	0	Bracket, Governor speed limit
	125 27261	0	Washer, Flat
	134 650163	0	Screw, Fil. hd. Sems, 10-32 x 7/8
	135 650520	0	Screw
	135 650544	0	Screw, Pan flex hd., 10-24 x 7/8
	136 27183	0	Washer, Fiber
	136 31905	0	Washer, Paper

Ref #	Part Number	Qty	Description
138	30985	0	Control, Throttle
138A	24522	0	Control, Throttle
139	28454	0	Screw
140	28451	0	Gasket, Housing
140B	8274	0	Lockwasher
140A	30516	0	Housing, Reducer
141	30517A	0	Gasket, Reduction cover
143	30518	0	Cover, Housing (All 6:1 gear reduction
144	9556	0	Plug, Oil drain (Sq. hd. pipe, 1/8-27)
145	24590	0	Plug, Pipe
146	30564	0	Screw
148	32714	0	Pin, Shaft & Gear (All 6:1 gear reduction
149	28508	0	Plug, Expansion
150	30256	0	Seal, Oil
154	650561	0	Screw
158	650163	0	Screw, Fil. hd. Sems, 10-32 x 7/8
162	730136A	0	Control Assy., Mini Bike Speed
163	33879	0	Bracket Assy., Speed control
169	33127	0	Bracket, Muffler
170	31874	0	Baffle, Heat
171	650665	0	Screw
172	30997	0	Cover, Muffler
193	730162	0	Kit, Muffler Adapter
215	730510	0	Kit, Pre-cleaner
220	31266	0	Spacer, Strip
221	26460	0	Clamp, Fuel line
224	650687	0	Screw, Pan hd. self-tap, 10-32 x 5/16
228	650257	0	Screw, Pan hd. Sems, 8-32 x 5/16
229	31291	0	Plug, Cover
230	32410	0	Knob, Speed control
236	32399	0	Spring, Choke knob
237	32400	0	Knob, Choke
241	32397	0	Plate Assy., Choke
242	650571	0	Screw, Flat trim hd. mach. , 10-32 x 7/16