



| Ref # | Part Number | Qty | Description                                  |
|-------|-------------|-----|--|
| 1     | 31428       | 0   | Cylinder Assy. (2-5/16" Bore) (Cast-iron     |
| 2     | 26727       | 0   | Pin, Dowel                                   |
| 3     | 27642       | 0   | Plug, Drain                                  |
| 3A    | 27642       | 0   | Plug, Drain                                  |
| 4     | 29183       | 0   | Seal, Oil                                    |
| 5     | 29314A      | 0   | Valve, Intake (Standard)                     |
| 5     | 29315B      | 0   | Valve, Intake (1/32" oversize)               |
| 6     | 29313B      | 0   | Valve, Exhaust (Standard)                    |
| 6     | 29315B      | 0   | Valve, Intake (1/32" oversize)               |
| 7     | 31671       | 0   | Cap, Upper valve spring                      |
| 8     | 31672       | 0   | Spring, Valve                                |
| 9     | 31673       | 0   | Cap, Lower valve spring                      |
| 11    | 29367       | 0   | Crankshaft Assy.                             |
| 12    | 29783       | 0   | Pin, Crankshaft gear                         |
| 13    | 27613       | 0   | Gear, Crankshaft                             |
| 14    | 31761       | 0   | Piston & Pin Assy. (Standard) (2-5/16")      |
| 14    | 32662       | 0   | Piston & Pin Assy. (.010 oversize)           |
| 14    | 32663       | 0   | Piston & Pin Assy. (.020 oversize)           |
| 15    | 27565       | 0   | Ring Set, Piston (Standard) (2-5/16")        |
| 15    | 27566       | 0   | Ring Set, Piston (.010 oversize)             |
| 15    | 27567       | 0   | Ring Set, Piston (.020 oversize)             |
| 15    | 29903       | 0   | Re-Ringing Set, Piston                       |
| 16    | 20381       | 0   | Ring, Piston pin retaining                   |
| 17    | 30963B      | 0   | Rod Assy., Connecting                        |
| 18    | 26706       | 0   | Bolt, Connecting rod                         |
| 19    | 28594       | 0   | Dipper, Oil                                  |
| 20    | 27573       | 0   | Nut, Connecting rod bolt                     |
| 21    | 31317       | 0   | Camshaft (No compression release)            |
| 22    | 27241       | 0   | Lifter, Valve                                |
| 23    | 30758       | 0   | Cover, Cylinder                              |
| 24    | 30256       | 0   | Seal, Oil                                    |
| 25    | 27625       | 0   | Plug, Oil filler                             |
| 26    | 29673       | 0   | Gasket, Filler plug                          |
| 27    | 27677       | 0   | Gasket, Cylinder cover                       |
| 28    | 30564       | 0   | Screw  |
| 29    | 30981       | 0   | Bushing, Crankshaft                          |
| 30    | 650168      | 0   | Washer, Flat                                 |
| 30    | 650675      | 0   | Washer, Flat                                 |
| 31A   | 650489      | 0   | Screw  |
| 31    | 650489      | 0   | Screw  |
| 32    | 29953B      | 0   | Gasket, Cylinder head                        |
| 33    | 30579       | 0   | Head, Cylinder                               |
| 34    | 26073       | 0   | Washer, Connecting rod bolt                  |
| 35    | 6021        | 0   | Screw  |
| 35    | 650694      | 0   | Screw, Hex hd. cap, 5/16-18 x 2              |
| 35    | 650695      | 0   | Screw, Hex hd. cap, 5/16-18 x 2-1/4 (Grade 8 |
| 37    | 33636       | 0   | Plug, Spark (Champion J-8 or equivalent)     |
| 38    | 31619       | 0   | Gasket, Breather cover                       |
| 39    | 31337       | 0   | Breather Assy.                               |
| 40    | 31410       | 0   | Element, Breather                            |
| 42    | 650128      | 0   | Screw  |
| 45    | 26754       | 0   | Gasket, Exhaust                              |
| 46    | 28416       | 0   | Pipe, Intake                                 |
| 47    | 650664      | 0   | Screw, Phil. fil. hd. Sems, 1/4-20 x 1-19/32 |
| 48    | 30646       | 0   | Screw, Phil. fil. hd. Sems, 1/4-20 x 1-3/8   |
| 48    | 650517      | 0   | Screw, Fil. flex hd. self-locking, 1/4-20 x  |
| 48    | 650664      | 0   | Screw, Phil. fil. hd. Sems, 1/4-20 x 1-19/32 |
| 50    | 650708      | 0   | Washer, Flat 5/16"                           |

| Ref # | Part Number | Qty | Description                                |
|-------|-------------|-----|--|
| 50    | 8303        | 0   | Lockwasher                                 |
| 53    | 650152      | 0   | Screw                                      |
| 53    | 650684      | 0   | Screw, Fil. hd mach., 8-32 x 5/16          |
| 58    | 31858       | 0   | Link, Throttle                             |
| 59    | 31510       | 0   | Lever, Governor                            |
| 63A   | 31334       | 0   | Rod, Governor                              |
| 64    | 30658       | 0   | Baffle, Blower housing                     |
| 65    | 30200       | 0   | Screw                                      |
| 65    | 650561      | 0   | Screw                                      |
| 66    | 31345       | 0   | Plate, Identification                      |
| 67    | 29309       | 0   | Stud, Drive                                |
| 68    | 650548      | 0   | Screw, Hex washer hd., 8-32 x 5/16         |
| 69    | 29212       | 0   | Screw                                      |
| 70    | 30655A      | 0   | Housing, Blower                            |
| 71    | 650490      | 0   | Washer, Belleville                         |
| 72    | 650607      | 0   | Nut, Flywheel                              |
| 73    | 29716       | 0   | Screw                                      |
| 74    | 16645       | 0   | Lockwasher                                 |
| 75    | 30747       | 0   | Clip, Shorting                             |
| 76A   | 33306       | 0   | Decal, Mini-Bike (2-1/2 H.P.)              |
| 76A   | 33307       | 0   | Decal, Mini-Bike (3 H.P.)                  |
| 76A   | 33308       | 0   | Decal, Mini-Bike (3-1/2 H.P.)              |
| 76    | 30596       | 0   | Decal, Name & H.P. (2-1/4 H.P.)            |
| 76    | 30597       | 0   | Decal, Name & H.P. (3 H.P.)                |
| 76    | 30612       | 0   | Decal, Name & H.P. (3-1/2 H.P.)            |
| 76    | 30631       | 0   | Decal, Name & H.P. (2-1/2 H.P.)            |
| 76    | 31328       | 0   | Decal, Name & H.P. (4 H.P.)                |
| 78A   | 30767       | 0   | Spacer, Air cleaner                        |
| 78    | 27272       | 0   | Gasket, Air cleaner                        |
| 81B   | 30727       | 0   | Element, Air cleaner                       |
| 83    | 28820       | 0   | Screw                                      |
| 83    | 650163      | 0   | Screw, Fil. hd. Sems, 10-32 x 7/8          |
| 83    | 650399      | 0   | Screw, Phil. fil. hd. Sems, 10-32 x 5/8    |
| 83    | 650709      | 0   | Screw                                      |
| 84    | 30564       | 0   | Screw                                      |
| 84    | 6201        | 0   | Screw                                      |
| 84    | 6202        | 0   | Screw                                      |
| 84    | 650551      | 0   | Screw, Hex hd. cap, 1/4-28 x 1-1/4         |
| 87    | 26756       | 0   | Gasket, Carburetor                         |
| 89    | 29752       | 0   | Nut  |
| 90    | 31432       | 0   | Bracket, Speed limit                       |
| 91    | 27793       | 0   | Clip, Conduit                              |
| 92    | 28942       | 0   | Screw                                      |
| 95    | 28277       | 0   | Washer, Flat                               |
| 106   | 30574       | 0   | Shaft, Mechanical governor                 |
| 107   | 30591       | 0   | Gear Assy., Governor                       |
| 107A  | 30590A      | 0   | Washer, Flat                               |
| 108   | 29193       | 0   | Ring, Retaining                            |
| 109   | 30588A      | 0   | Spool, Governor                            |
| 110   | 28212       | 0   | Spacer                                     |
| 111   | 29539       | 0   | Bracket, Upper fuel tank                   |
| 112B  | 29540       | 0   | Bracket, Lower fuel tank                   |
| 113   | 30688       | 0   | Screw, Hex hd. Sems, 1/4-20 x 1/2          |
| 113   | 650306      | 0   | Screw, Hex hd. cap, 1/4-20 x 1/2           |
| 113   | 650561      | 0   | Screw                                      |
| 114   | 29809       | 0   | Tank Assy., Fuel (1 gal.)                  |
| 115   | 26027       | 0   | Cap, Fuel filler (Special bayonet type)    |
| 115   | 30998B      | 0   | Cap, Fuel filler (Red Plastic) (Sno Proof) |

| Ref # | Part Number | Qty | Description                                  |
|-------|-------------|-----|--|
| 115   | 32387A      | 0   | Cap, Fuel filler (Charcoal Plastic) (Spurt   |
| 115   | 33032       | 0   | Cap, Fuel filler (Red Plastic) (Spurt        |
| 115   | 410144B     | 0   | Cap, Fuel filler (White Plastic) (Std.)      |
| 116   | 650556      | 0   | Screw  |
| 116   | 650665      | 0   | Screw  |
| 116   | 650697      | 0   | Screw, Hex hd. cap, 5/16-18 x 2-1/2          |
| 117B  | 29683       | 0   | Strainer & Shut-off                          |
| 117B  | 32961       | 0   | Valve, Fuel shut-off                         |
| 117   | 28837       | 0   | Strainer & Fitting                           |
| 118   | 29774       | 0   | Line, Fuel (Braided 8.25")                   |
| 118   | 30705       | 0   | Line, Fuel (Braided 16")                     |
| 118   | 30962       | 0   | Line, Fuel (Braided 32")                     |
| 119A  | 31778       | 0   | Spring, Coil                                 |
| 119   | 28819       | 0   | Spring, Fuel line                            |
| 120   | 650128      | 0   | Screw  |
| 121   | 29745       | 0   | Extension, Blower housing                    |
| 122   | 31752       | 0   | Decal, Air cleaner                           |
| 126   | 30322       | 0   | Nut & Lockwasher                             |
| 129   | 27247       | 0   | Key, Flywheel                                |
| 130   | 32576       | 0   | Seal, Snow guard                             |
| 131   | 31680       | 0   | Guard, Starter                               |
| 132   | 31875       | 0   | Baffle, Heat                                 |
| 133   | 28763       | 0   | Screw, Hex washer hd. thread-forming, 10-24  |
| 137   | 31373       | 0   | Spacer, Carburetor                           |
| 159   | 31691       | 0   | Bracket, Air cleaner                         |
| 160   | 31692       | 0   | Body, Air cleaner                            |
| 161   | 30586       | 0   | Decal, Instruction                           |
| 161   | 31714       | 0   | Decal, Instruction                           |
| 161   | 33320       | 0   | Decal, Instruction Spec. Nos. 25205H, 212H,  |
| 166   | 33356       | 0   | Terminal, Ground                             |
| 167   | 29117       | 0   | Screw  |
| 167   | 30688       | 0   | Screw, Hex hd. Sems, 1/4-20 x 1/2            |
| 167   | 650561      | 0   | Screw  |
| 167   | 650643      | 0   | Screw  |
| 168   | 27675       | 0   | Nut, Conduit                                 |
| 176   | 650116      | 0   | Nut, Lock                                    |
| 177   | 27276       | 0   | Cover, Spark plug                            |
| 178   | 30200       | 0   | Screw  |
| 179   | 28539       | 0   | Ring, Retaining (All ball bearing models)    |
| 180   | 28537       | 0   | Washer, Flat                                 |
| 181   | 28458       | 0   | Bearing, Ball All ball bearing models except |
| 183   | 31861       | 0   | Clip, Shorting                               |
| 184   | 29443       | 0   | Clip, Fuel line                              |
| 185   | 31335       | 0   | Clamp, Governor lever                        |
| 203   | 30865       | 0   | Link, Bellcrank                              |
| 204   | 27275       | 0   | Clip, Hi-tension wire                        |
| 209A  | 32187       | 0   | Decal, Super-start                           |
| 209   | 32179       | 0   | Decal, Super-start                           |
| 213   | 30595       | 0   | Decal, Ezee-start                            |
| 214   | 650518      | 0   | Lockwasher, No. 10                           |
| 216   | 730127      | 0   | Cleaner Assy., Air (Poly)                    |
| 217   | 730512      | 0   | Kit, Pre-cleaner                             |
| 218   | 31668       | 0   | Bag, Pre-cleaner                             |
| 219   | 31667       | 0   | Spring, Pre-cleaner bag                      |
| 221   | 26460       | 0   | Clamp, Fuel line                             |
| 222   | 30980       | 0   | Bushing, Crankshaft                          |
| 231   | 30968       | 0   | Nipple, Oil (2-1/2")                         |
| 231   | 32678       | 0   | Nipple, Oil drain                            |

| Ref # | Part Number | Qty | Description                     |
|-------|-------------|-----|---------------------------------|
| 232   | 30969       | 0   | Cap, Oil drain                  |
| 233   | 28250       | 0   | Decal, H.P. (3 H.P.)            |
| 233   | 30077       | 0   | Decal, H.P. (3-1/2 H.P.)        |
| 233   | 31427       | 0   | Decal, H.P. (2-1/2 H.P.)        |
| 235   | 28942       | 0   | Screw                           |
| 235   | 30200       | 0   | Screw                           |
| 238   | 28545       | 0   | Grommet, Plastic                |
| 243   | 30879       | 0   | Bracket, Toggle switch          |
| 244   | 610164      | 0   | Switch, Toggle                  |
| 257   | 631021      | 0   | Inlet Needle, Seat & Clip Assy. |
| 259   | 30547A      | 0   | Contact Assy., Breaker          |
| 260   | 30548A      | 0   | Condenser                       |
| 261A  | 631070A     | 0   | Carburetor                      |
| 262   | 610690A     | 0   | Magneto, Tecumseh               |
| 264   | 33233       | 0   | Gasket Set                      |

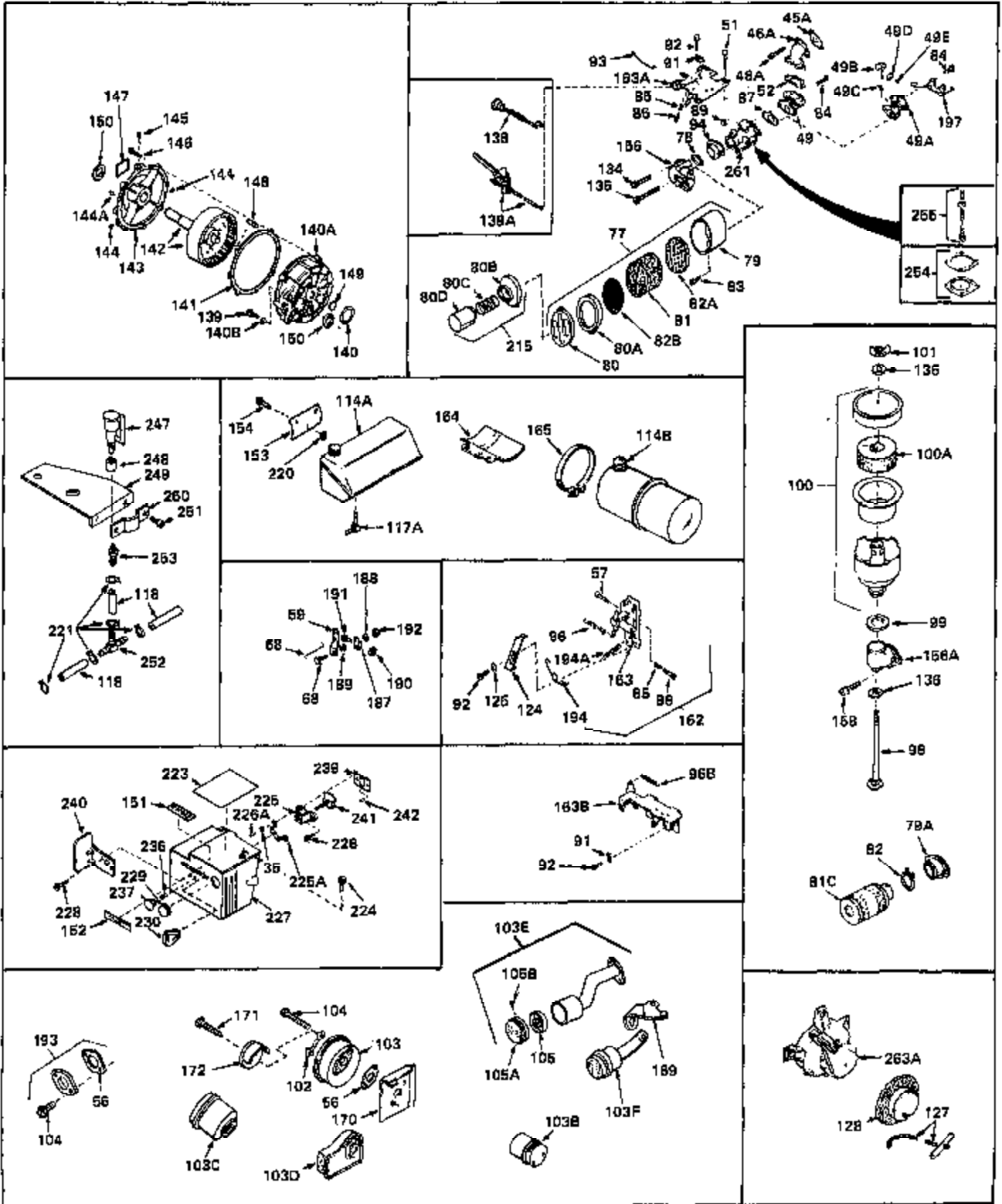

| Ref # | Part Number | Qty | Description                                 |
|-------|-------------|-----|---|
| 36    | 8269        | 0   | Washer                                      |
| 45A   | 30188       | 0   | Gasket, Intake pipe                         |
| 48A   | 650451      | 0   | Screw                                       |
| 51    | 650454      | 0   | Screw, Fil. flex hd. 1/4-20 x 3/4           |
| 56    | 30081       | 0   | Gasket, Exhaust                             |
| 57    | 28942       | 0   | Screw                                       |
| 57    | 30091       | 0   | Screw, Hex slotted washer hd., 8-32 x 1/2   |
| 57    | 30200       | 0   | Screw                                       |
| 59    | 31510       | 0   | Lever, Governor                             |
| 68    | 650548      | 0   | Screw, Hex washer hd., 8-32 x 5/16          |
| 77    | 31545       | 0   | Cleaner Assy., Air                          |
| 78    | 27272       | 0   | Gasket, Air cleaner                         |
| 80C   | 450150      | 0   | Spring, Pre-cleaner                         |
| 80D   | 450124      | 0   | Bag, Pre-cleaner                            |
| 82A   | 29962       | 0   | Screen, Air cleaner                         |
| 83    | 28820       | 0   | Screw                                       |
| 83    | 650163      | 0   | Screw, Fil. hd. Sems, 10-32 x 7/8           |
| 83    | 650399      | 0   | Screw, Phil. fil. hd. Sems, 10-32 x 5/8     |
| 83    | 650709      | 0   | Screw                                       |
| 84    | 30564       | 0   | Screw                                       |
| 84    | 6201        | 0   | Screw                                       |
| 84    | 6202        | 0   | Screw                                       |
| 84    | 650551      | 0   | Screw, Hex hd. cap, 1/4-28 x 1-1/4          |
| 85    | 28564       | 0   | Spring, Compression                         |
| 85    | 31342       | 0   | Spring, Compression                         |
| 85    | 32924       | 0   | Spring, Compression                         |
| 86    | 29500       | 0   | Screw, Fil. hd. mach., Sems, 8-32 x 3/4     |
| 86    | 650549      | 0   | Screw                                       |
| 86    | 650688      | 0   | Screw, Hex hd., 10-32 x 1-5/16" (Drilled    |
| 87    | 26756       | 0   | Gasket, Carburetor                          |
| 89    | 29752       | 0   | Nut   |
| 91    | 27793       | 0   | Clip, Conduit                               |
| 92    | 28942       | 0   | Screw                                       |
| 96B   | 31426       | 0   | Spring, Extension                           |
| 101   | 9577        | 0   | Nut, Wing, 10-24                            |
| 102   | 30083       | 0   | Plate, Locking                              |
| 103F  | 33288       | 0   | Muffler                                     |
| 103   | 30996       | 0   | Muffler                                     |
| 104   | 27182       | 0   | Screw, Hex hd. cap, 1/4-20 x 3-3/8          |
| 104   | 650253      | 0   | Screw, Hex hd. cap, 1/4-20 x 2-1/4          |
| 104   | 650327      | 0   | Screw, Fil slotted hd. Sems, 114-20 x 2-1/2 |
| 104   | 650493      | 0   | Screw, Hex hd. Sems, 1/4-20 x 1-3/4         |
| 104   | 650561      | 0   | Screw                                       |
| 104   | 650599      | 0   | Screw, Hex hd. cap, Sems, 1/4-20 x 1-1/2    |
| 104   | 650795      | 0   | Screw, Hex hd. cap, Sems, 1/4-20 x 2-5/16   |
| 105B  | 650578      | 0   | Screw                                       |
| 105A  | 33172       | 0   | Cover, Muffler                              |
| 105   | 33171       | 0   | Screen, Muffler                             |
| 117A  | 28584       | 0   | Strainer & Elbow                            |
| 118   | 29774       | 0   | Line, Fuel (Braided 8.25")                  |
| 118   | 30705       | 0   | Line, Fuel (Braided 16")                    |
| 118   | 30962       | 0   | Line, Fuel (Braided 32")                    |
| 127   | 590343      | 0   | Rope & Handle Assy., Starter                |
| 128   | 30892       | 0   | Pulley, Rope starter                        |
| 134   | 650163      | 0   | Screw, Fil. hd. Sems, 10-32 x 7/8           |
| 135   | 650520      | 0   | Screw                                       |
| 135   | 650544      | 0   | Screw, Pan flex hd., 10-24 x 7/8            |
| 136   | 27183       | 0   | Washer, Fiber                               |

| Ref # | Part Number | Qty | Description                               |
|-------|-------------|-----|---|
| 136   | 31905       | 0   | Washer, Paper                             |
| 138A  | 24522       | 0   | Control, Throttle                         |
| 138   | 30985       | 0   | Control, Throttle                         |
| 139   | 28454       | 0   | Screw                                     |
| 140A  | 30516       | 0   | Housing, Reducer                          |
| 140   | 28451       | 0   | Gasket, Housing                           |
| 140B  | 8274        | 0   | Lockwasher                                |
| 141   | 30517A      | 0   | Gasket, Reduction cover                   |
| 142   | 28449A      | 0   | Shaft & Gear Assy.                        |
| 143   | 30518       | 0   | Cover, Housing (All 6:1 gear reduction    |
| 144A  | 9556        | 0   | Plug, Oil drain (Sq. hd. pipe, 1/8-27)    |
| 144   | 9556        | 0   | Plug, Oil drain (Sq. hd. pipe, 1/8-27)    |
| 145   | 24590       | 0   | Plug, Pipe                                |
| 146   | 30564       | 0   | Screw                                     |
| 147   | 28973       | 0   | Decal, Oil fill                           |
| 148   | 32714       | 0   | Pin, Shaft & Gear (All 6:1 gear reduction |
| 149   | 28508       | 0   | Plug, Expansion                           |
| 150   | 30256       | 0   | Seal, Oil                                 |
| 154   | 650561      | 0   | Screw                                     |
| 158   | 650163      | 0   | Screw, Fil. hd. Sems, 10-32 x 7/8         |
| 162   | 730136A     | 0   | Control Assy., Mini Bike Speed            |
| 163   | 33282       | 0   | Bracket Assy., Speed control              |
| 169   | 33127       | 0   | Bracket, Muffler                          |
| 170   | 31874       | 0   | Baffle, Heat                              |
| 171   | 650665      | 0   | Screw                                     |
| 172   | 30997       | 0   | Cover, Muffler                            |
| 193   | 730162      | 0   | Kit, Muffler Adapter                      |
| 215   | 730510      | 0   | Kit, Pre-cleaner                          |
| 220   | 31266       | 0   | Spacer, Strip                             |
| 221   | 26460       | 0   | Clamp, Fuel line                          |
| 224   | 650687      | 0   | Screw, Pan hd. self-tap, 10-32 x 5/16     |
| 228   | 650257      | 0   | Screw, Pan hd. Sems, 8-32 x 5/16          |
| 229   | 31291       | 0   | Plug, Cover                               |
| 230   | 32410       | 0   | Knob, Speed control                       |
| 236   | 32399       | 0   | Spring, Choke knob                        |
| 237   | 32400       | 0   | Knob, Choke                               |
| 241   | 32397       | 0   | Plate Assy., Choke                        |
| 242   | 650571      | 0   | Screw, Flat trim hd. mach. , 10-32 x 7/16 |