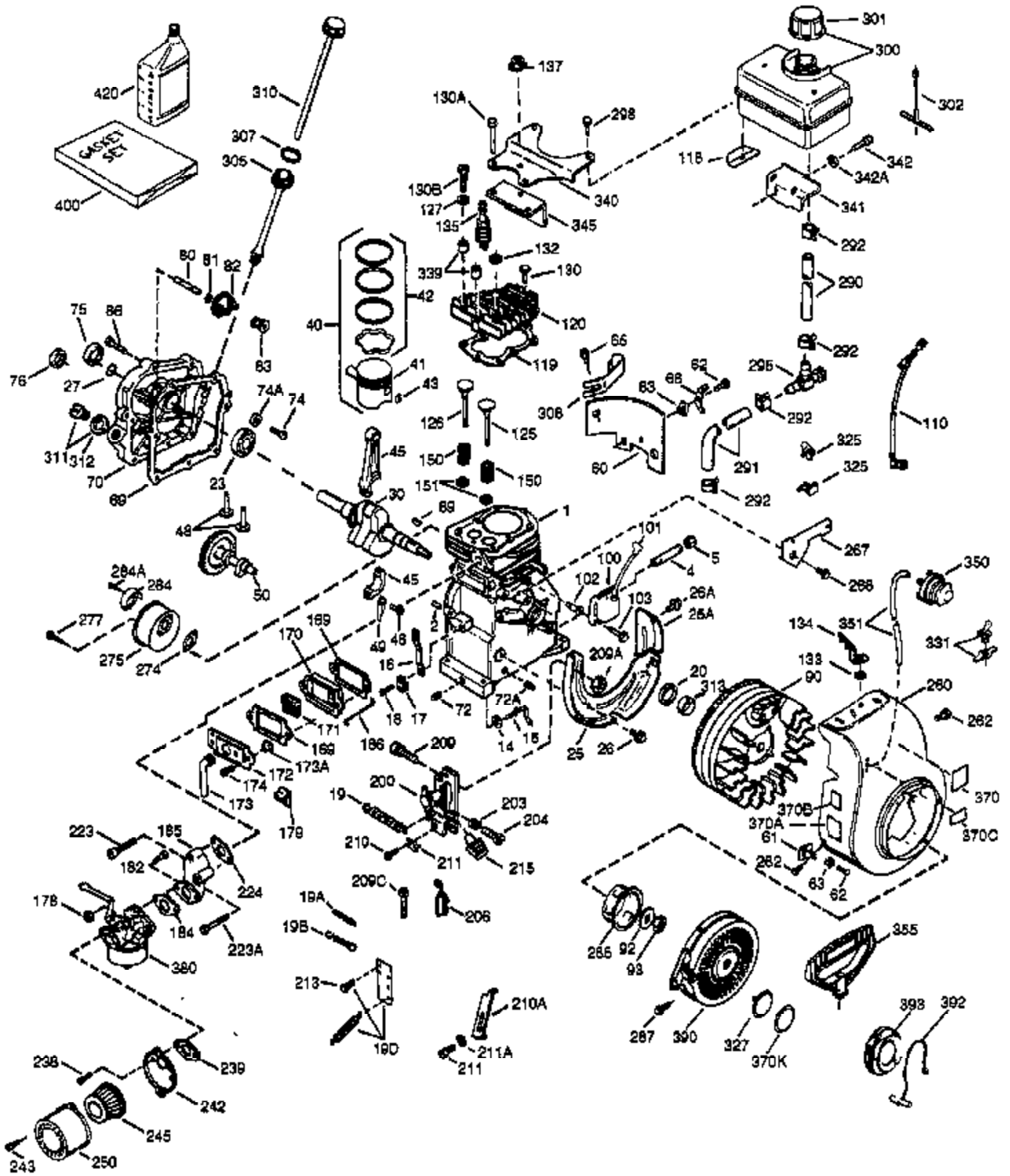

ILLUSTRATION SHOWS TYPICAL PARTS ONLY. ORDER BY PART NUMBER. PARTS NOT LISTED ARE SUPPLIED BY OEM.

VIEW 1 OF 2



Ref #	Part Number	Qty	Description
	1 36589A	1	Cylinder (Incl. 2,20,72 & 125)
	2 26727	2	Dowel Pin
	14 28277	1	Washer
	15 31334	1	Governor Rod
	16 31510	1	Governor Lever
	17 29916	1	Governor Lever Clamp
	18 651028	1	Screw, Torx T-15, 8-32 x 3/8"
	19D 33857	1	Extension Spring Ass'y. (Incl. 213)
	19 31426	1	Extension Spring
	20 32600	1	Oil Seal
	23 28458	1	Ball Bearing
	25 36552	1	Blower Housing Baffle (Incl. 262)
	25A 35883	1	Baffle Extension
	26 650802	2	Screw, 1/4-20 x 5/8"
	26A 650926	1	Screw, 8-32 x 21/64"
	27 28539	1	Bearing Retainer
	30 34727	1	Crankshaft
	40 40020	1	Piston, Pin & Ring Set (Std.)
	40 40021	1	Piston, Pin & Ring Set (.010" OS)
	41 40018	1	Piston & Pin Ass'y. (Std.) (Incl. 43)
	41 40019	1	Piston & Pin Ass'y. (.010" OS) (Incl. 43)
	42 40022	1	Ring Set (Std.)
	42 40023	1	Ring Set (.010" OS)
	43 20381	2	Piston Pin Retaining Ring
	45 30963B	1	Connecting Rod Ass'y. (Incl. 46 & 49)
	46 32610A	2	Connecting Rod Bolt
	48 27241	2	Valve Lifter
	49 28594	1	Oil Dipper
	50 32197A	1	Camshaft (MCR)
	60 29745	1	Blower Housing Extension
	62 650760	1	Screw, 8-32 x 3/8"
	63 28545	1	Grommet
	65 650128	1	Screw, 10-24 x 1/2"
	68 33356	1	Ground Terminal
	69 27677A	1	* Cylinder Cover Gasket
	70 30756C	1	Cylinder Cover (Incl. 75 thru 83,311)
	72 27642	2	Oil Drain Plug
	74A 28537	2	Washer
	74 30200	2	Screw, 10-24 x 9/16"
	75 28540	1	Oil Seal
	80 30574A	1	Governor Shaft
	81 30590A	1	Washer
	82 30591	1	Governor Gear Ass'y. (Incl. 81)
	83 30588A	1	Governor Spool
	86 650488	7	Screw, 1/4-20 x 1-1/4"
	89 610961	1	Flywheel Key
	90 611195	1	Flywheel
	92 650815	1	Belleville Washer
	93 650816	1	Flywheel Nut
	100 34443B	1	Solid State Ignition
	101 27276	1	Spark Plug Cover
	102 651024	2	Stud
	103 651007	2	Screw, Torx T-15, 10-24 x 15/16"
	110 36681	1	Ground Wire
	118 35515	1	Rope Guard
	119 36437	1	* Cylinder Head Gasket
	120 36438	1	Cylinder Head (Incl. 119 & 130)
	125 36471	1	Exhaust Valve (Std.) (Incl. 151)

Ref #	Part Number	Qty	Description
	125 36472	1	Exhaust Valve (1/32" OS) (Incl. 151)
	126 29315C	1	Intake Valve (1/32" OS) (Incl. 151)
	126 29314B	1	Intake Valve (Std.) (Incl. 151)
	130A 6021A	3	Screw, 5/16-18 x 1-1/2"
	130 650694A	5	Screw, 5/16-18 x 2"
	133 650890	1	Lock Washer, 5/16
	134 30747	1	Shorting Clip
	135 33636	1	Resistor Spark Plug
	137 29752	1	Nut & Lock Washer 1/4-28
	150 31672	2	Valve Spring
	151 31673	2	Valve Spring Cap
	169 27234A	2	* Valve Cover Gasket
	170 27666	1	Breather Body
	171 31410	1	Breather Element
	172 34146	1	Valve Cover
	173A 32446	1	Breather Tube Grommet
	173 32447	1	Breather Tube
	174 650783	2	Screw, 10-24 x 3/4"
	178 29752	2	Nut & Lock Washer, 1/4-28
	182 6201	2	Screw, 1/4-28 x 7/8"
	184 26756	1	* Carburetor To Intake Pipe Gasket
	185 28416A	1	Intake Pipe
	186 31858	1	Governor Link
	200 730136A	1	Control Bracket (Incl. 19,203 thru 21 1)
	203 31342	1	Compression Spring
	204 651019	1	Screw, Torx T-10, 5-40 x 7/16"
	209 650139	2	Screw, 8-32 x 3/4"
	209A 30322	2	Lock Nut
	210 27793	1	Conduit Clip
	211 28942	1	Screw, 10-32 x 3/8"
	213 28942	1	Screw, 10-32 x 3/8"
	223A 650840	1	Screw, 1/4-20 x 1-7/32"
	223 650664	1	Screw, 1/4-20 x 1-19/32"
	224 26754A	1	* Intake Pipe Gasket
	238 650152	2	Screw, 8-32 x 3/8"
	239 27272A	1	* Air Cleaner Gasket
	242 31691	1	Air Cleaner Base
	243 28820	2	Screw, 10-32 x 1/2"
	245 30727	1	Air Cleaner Filter
	250 31715	1	Air Cleaner Cover
	260 35657	1	Blower Housing
	262 650737	2	Screw, 1/4-20 x 1/2"
	267 34212	1	Hold Down Bracket
	268 30200	1	Screw, 10-24 x 9/16"
	275 40001	1	Muffler (W/Catalyst)
	277 650988	2	Screw, 1/4-20 x 2-5/16"
	285 36467A	1	Starter Cup
	287 650926	2	Screw, 8-32 x 21/64"
	290 30962	1	Fuel Line
	292 26460	2	Fuel Line Clamp
	298 650665	2	Screw, 1/4-15 x 7/8"
	300 35591	1	Fuel Tank (Incl. 292 & 301)
	301 36246	1	Fuel Cap
	311 27625	1	Oil Fill Plug
	313 34080	1	Spacer
	340 35230	1	Fuel Tank Bracket
	342 650751	1	Screw, 1/4-20 x 7/16"
	370 34686	1	Name Decal

Ref #	Part Number	Qty	Description
370A	36261	1	Lubrication Decal
370K	36695	1	Starter Decal
380	640130	1	Carburetor (Incl. 184)
390	590732	1	Rewind Starter (NOTE: This engine could have been built with 590738 starter.)
400	36439	1	* Gasket Set (Incl. items marked PK in notes) Incl. part #'s 26754A (1), 26756 (1), 27234A (2), 27272A (1), 27677A (1), 29673 (1), 30081A (1), 31688A (1), 32649A (1), 36437 (1)
420	730225	1	SAE 30 4-Cycle Engine Oil (Quart)

ILLUSTRATION SHOWS TYPICAL PARTS ONLY. ORDER BY PART NUMBER. PARTS NOT LISTED ARE SUPPLIED BY OEM.

VIEW 2 OF 2

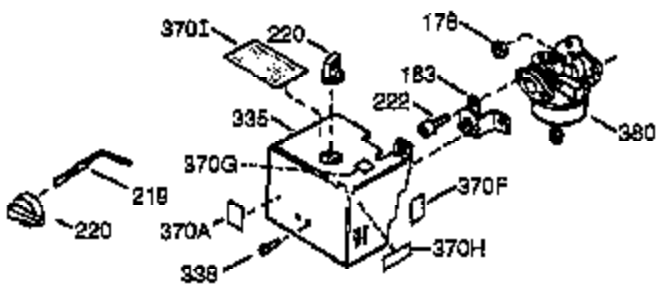
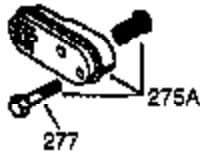
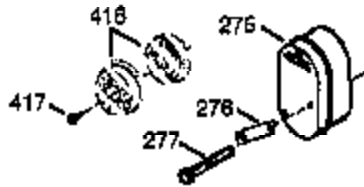
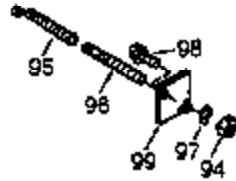

OPTIONAL 110 - 120 VOLT
STARTER MOTOR KIT



396

Ref #	Part Number	Qty	Description
16	31510	1	Governor Lever
17	29916	1	Governor Lever Clamp
18	651028	1	Screw, Torx T-15, 8-32 x 3/8"
28	30322	1	Lock Nut 8-32
35	29826	1	Screw, 10-32 x 3/4"
36	29918	1	Lock Washer
37	29216	1	Lock Nut 10-32
38	29642	1	Retaining Ring
178	29752	2	Nut & Lock Washer, 1/4-28
200	730136A	1	Control Bracket (Incl. 19,203 thru 21 1)
203	31342	1	Compression Spring
204	651019	1	Screw, Torx T-10, 5-40 x 7/16"
209A	30322	2	Lock Nut
209	650139	2	Screw, 8-32 x 3/4"
238	650152	2	Screw, 8-32 x 3/8"
242	31691	1	Air Cleaner Base
245	30727	1	Air Cleaner Filter
250	31715	1	Air Cleaner Cover
275	40001	1	Muffler (W/Catalyst)
277	650988	2	Screw, 1/4-20 x 2-5/16"
370A	36261	1	Lubrication Decal
380	640130	1	Carburetor (Incl. 184)