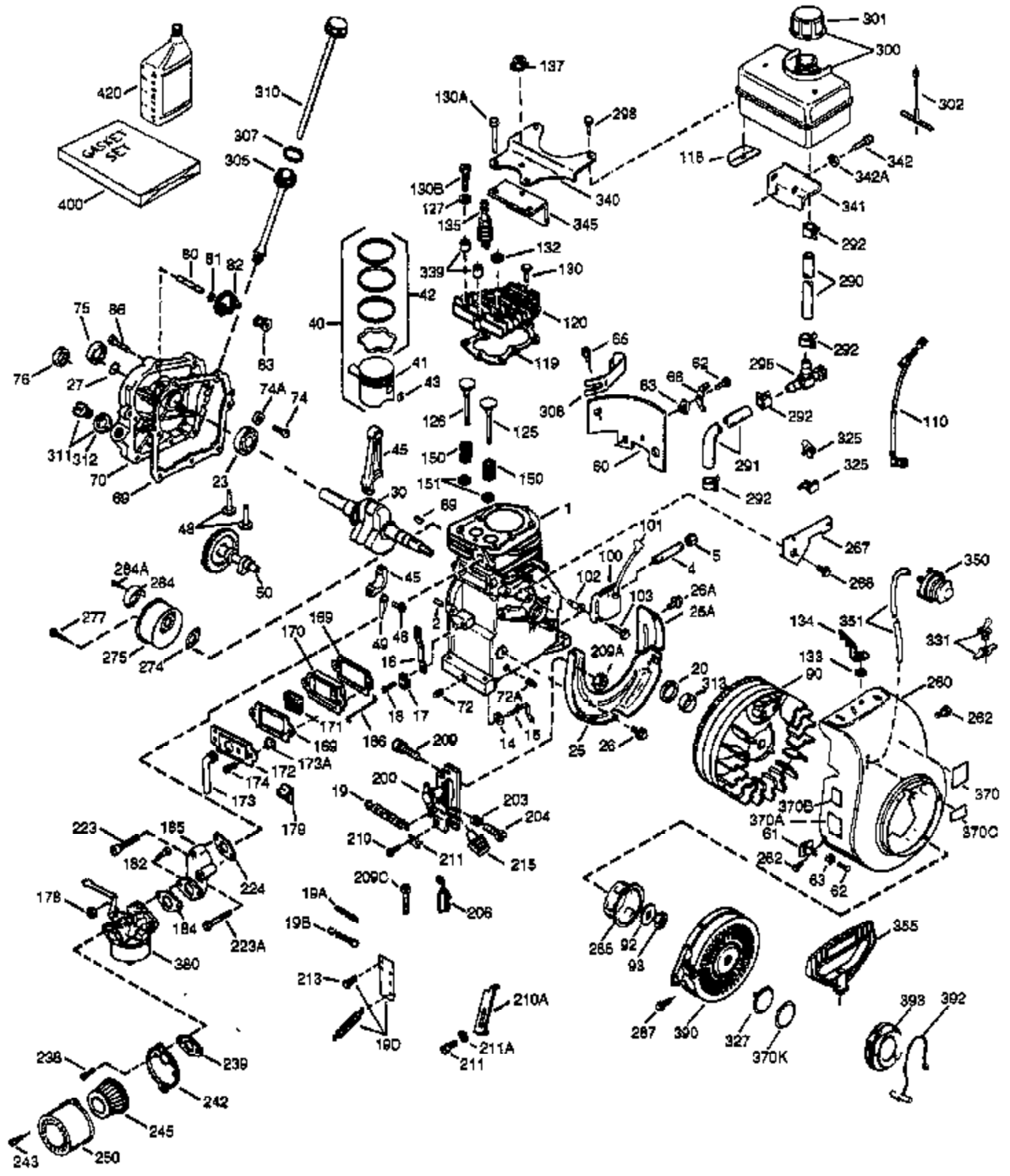

ILLUSTRATION SHOWS TYPICAL PARTS ONLY. ORDER BY PART NUMBER. PARTS NOT LISTED ARE SUPPLIED BY OEM.

VIEW 1 OF 2



| Ref # | Part Number | Qty | Description                               |
|-------|-------------|-----|---|
|       | 1 36562     | 1   | Cylinder (Incl. 2, 20, 72, 72A & 125)     |
|       | 2 26727     | 2   | Dowel Pin                                 |
|       | 14 28277    | 1   | Washer                                    |
|       | 15 31334    | 1   | Governor Rod                              |
|       | 16 37729    | 1   | Governor Lever                            |
|       | 17 29916    | 1   | Governor Lever Clamp                      |
|       | 18 651018   | 1   | Screw, T-15, 8-32 x 19/64"                |
|       | 19 31426    | 1   | Extension Spring                          |
|       | 19D 33857   | 1   | Extension Spring Ass'y. (Incl. 213)       |
|       | 20 32600    | 1   | Oil Seal                                  |
|       | 23 28458    | 1   | Ball Bearing                              |
|       | 25 36552    | 1   | Blower Housing Baffle (Incl. 262)         |
|       | 25A 35883   | 1   | Baffle Extension                          |
|       | 26A 650926  | 1   | Screw, 8-32 x 21/64"                      |
|       | 26 650802   | 2   | Screw, 1/4-20 x 5/8"                      |
|       | 27 28539    | 1   | Retainer Ring                             |
|       | 30 34735    | 1   | Crankshaft                                |
|       | 37A 30322   | 1   | Lock Nut 8-32                             |
|       | 40 40020    | 1   | Piston, Pin & Ring Set (Std.)             |
|       | 40 40021    | 1   | Piston, Pin & Ring Set (.010" OS)         |
|       | 41 40018    | 1   | Piston & Pin Ass'y. (Std.) (Incl. 43)     |
|       | 41 40019    | 1   | Piston & Pin Ass'y. (.010" OS) (Incl. 43) |
|       | 42 40022    | 1   | Ring Set (Std.)                           |
|       | 42 40023    | 1   | Ring Set (.010" OS)                       |
|       | 43 20381    | 2   | Piston Pin Retaining Ring                 |
|       | 45 32875A   | 1   | Connecting Rod Ass'y. (Incl. 46 & 49)     |
|       | 46 32610A   | 2   | Connecting Rod Bolt                       |
|       | 48 27241    | 2   | Valve Lifter                              |
|       | 49 32654    | 1   | Oil Dipper                                |
|       | 50 32197A   | 1   | Camshaft (MCR)                            |
|       | 60 29745    | 1   | Blower Housing Extension                  |
|       | 62 650760   | 1   | Screw, 8-32 x 1/2"                        |
|       | 63 28545    | 1   | Stop Grommet                              |
|       | 65 650128   | 1   | Screw, 10-24 x 1/2"                       |
|       | 69 27677A   | 1   | * Cylinder Cover Gasket                   |
|       | 70 30756C   | 1   | Cylinder Cover (Incl. 75 thru 83,311)     |
|       | 72A 28582   | 1   | Oil Drain Plug                            |
|       | 72 27642    | 2   | Oil Drain Plug                            |
|       | 74A 28537   | 1   | Washer                                    |
|       | 74 30200    | 1   | Screw, 10-24 x 9/16"                      |
|       | 75 28540    | 1   | Oil Seal                                  |
|       | 80 30574A   | 1   | Governor Shaft                            |
|       | 81 30590A   | 1   | Washer                                    |
|       | 82 30591    | 1   | Governor Gear Assembly (Incl. 81)         |
|       | 83 30588A   | 1   | Governor Spool                            |
|       | 86 650488   | 7   | Screw, 1/4-20 x 1-1/4"                    |
|       | 89 610961   | 1   | Flywheel Key                              |
|       | 90 611195   | 1   | Flywheel                                  |
|       | 92 650815   | 1   | Belleville Washer                         |
|       | 93 650816   | 1   | Flywheel Nut                              |
|       | 100 34443C  | 1   | Solid State Ignition (Incl. 101)          |
|       | 101 611289  | 1   | Spark Plug Cover                          |
|       | 102 651024  | 2   | Solid State Mounting Stud                 |
|       | 103 651007  | 2   | Screw, T-15, 10-24 x 15/16"               |
|       | 103A 650767 | 1   | Screw, 8-23 x 27/64"                      |
|       | 110A 36964  | 1   | Ground Wire                               |
|       | 110 37601   | 1   | Ground Wire                               |
|       | 110B 37602  | 1   | Ground Wire                               |

| Ref # | Part Number | Qty | Description                          |
|-------|-------------|-----|--------------------------------------|
| 111A  | 611224      | 1   | Rocker Switch                        |
| 119   | 36437       | 1   | * Cylinder Head Gasket               |
| 120   | 36438       | 1   | Cylinder Head (Incl. 130)            |
| 125   | 36471       | 1   | Exhaust Valve (Std.) (Incl. 151)     |
| 125   | 36472       | 1   | Exhaust Valve (1/32" OS) (Incl. 151) |
| 126   | 29314C      | 1   | Intake Valve (Std.) (Incl. 151)      |
| 130   | 6021A       | 2   | Screw, 5/16-18 x 1-1/2"              |
| 131   | 650694A     | 5   | Screw, 5/16-18 x 2"                  |
| 135   | 33636       | 1   | Resistor Spark Plug (RJ17LM)         |
| 150   | 31672       | 2   | Valve Spring                         |
| 151   | 31673       | 2   | Valve Spring Cap                     |
| 151A  | 40016A      | 1   | Intake Valve Seal                    |
| 169   | 27234A      | 2   | * Valve Cover Gasket                 |
| 170   | 27666       | 1   | Breather Body                        |
| 171   | 31410       | 1   | Breather Element                     |
| 172   | 34146       | 1   | Valve Cover                          |
| 173   | 32447       | 1   | Breather Tube                        |
| 173A  | 32446       | 1   | Breather Tube Grommet                |
| 174   | 650783      | 2   | Screw, 10-24 x 3/4"                  |
| 178   | 29752       | 2   | Nut & Lock Washer, 1/4-28            |
| 182   | 6201        | 2   | Screw, 1/4-28 x 7/8"                 |
| 184   | 26756       | 1   | * Carburetor-to-Intake Pipe Gasket   |
| 185   | 28416A      | 1   | Intake Pipe                          |
| 186   | 37728       | 1   | Governor Link                        |
| 200   | 730136A     | 1   | Control Bracket (Incl. 203 thru 211) |
| 203   | 31342       | 1   | Compression Spring                   |
| 204   | 651029      | 1   | Screw, T-10, 5-40 x 7/16"            |
| 210   | 27793       | 1   | Conduit Clip                         |
| 211   | 28942       | 1   | Screw, 10-32 x 3/8"                  |
| 213   | 28942       | 1   | Screw, 10-32 x 3/8"                  |
| 223   | 650664      | 1   | Screw, 1/4-20 x 1-19/32"             |
| 223A  | 650840      | 1   | Screw, 1/4-20 x 1-7/32"              |
| 224   | 26754A      | 1   | * Intake Pipe Gasket                 |
| 238   | 28820       | 2   | Screw, 10-32 x 1/2"                  |
| 239   | 27272A      | 1   | * Air Cleaner Gasket                 |
| 242   | 31691       | 1   | Air Cleaner Base                     |
| 243   | 650152      | 2   | Screw, 10-32 x 3/8"                  |
| 245   | 30727       | 1   | Air Cleaner Filter                   |
| 250   | 31715       | 1   | Air Cleaner Body                     |
| 260   | 37600       | 1   | Blower Housing                       |
| 262   | 650737      | 2   | Screw, 1/4-20 x 1/2"                 |
| 267   | 34212       | 1   | Hold Down Bracket                    |
| 268   | 30200       | 1   | Screw, 10-24 x 9/16"                 |
| 275   | 40001A      | 1   | Muffler (W/Catalyst)                 |
| 277   | 650988      | 2   | Screw, 1/4-20 x 2-9/32"              |
| 279   | 650488      | 1   | Screw, 1/4-20 x 1-1/4"               |
| 279A  | 30063       | 1   | Screw, T-30, 1/4-20 x 1/2"           |
| 280   | 37633       | 1   | Heat Shield                          |
| 285   | 36467A      | 1   | Starter Cup                          |
| 287   | 650926      | 2   | Screw, 8-32 x 21/64"                 |
| 290   | 30705       | 1   | Fuel Line                            |
| 292   | 26460       | 2   | Fuel Line Clamp                      |
| 298   | 650665      | 2   | Screw, 1/4-15 x 7/8"                 |
| 300   | 35584       | 1   | Fuel Tank (Incl. 292 & 301)          |
| 301   | 35355       | 1   | Fuel Cap                             |
| 311   | 27625       | 1   | Oil Fill Plug                        |
| 311   | 27625       | 1   | Oil Fill Plug                        |
| 312   | 29673       | 1   | Oil Fill Plug Gasket                 |

| Ref # | Part Number | Qty | Description  |
|-------|-------------|-----|--|
| 312   | 29673       | 1   | Oil Fill Plug Gasket   |
| 313   | 34080       | 1   | Spacer   |
| 325   | 27275       | 1   | Wire Clip  |
| 325   | 27275       | 1   | Wire Clip  |
| 340   | 36247       | 1   | Fuel Tank Bracket  |
| 342   | 650751      | 1   | Screw, 1/4-20 x 7/16"  |
| 345   | 33344       | 1   | Heat Baffle  |
| 370A  | 36261       | 1   | Instruction Decal  |
| 370K  | 36695       | 1   | Starter Decal  |
| 380   | 640134      | 1   | Carburetor (Incl. 184)   |
| 390   | 590738      | 1   | Recoil Starter (NOTE: This engine could have been built with 590732A starter.) |
| 400   | 36439       | 1   | * Gasket Set (Incl. items marked PK in notes)                                  |
| 420   | 730225      | 1   | SAE 30 4-Cycle Engine Oil (Quart)  |

ILLUSTRATION SHOWS TYPICAL PARTS ONLY. ORDER BY PART NUMBER. PARTS NOT LISTED ARE SUPPLIED BY OEM.

VIEW 2 OF 2

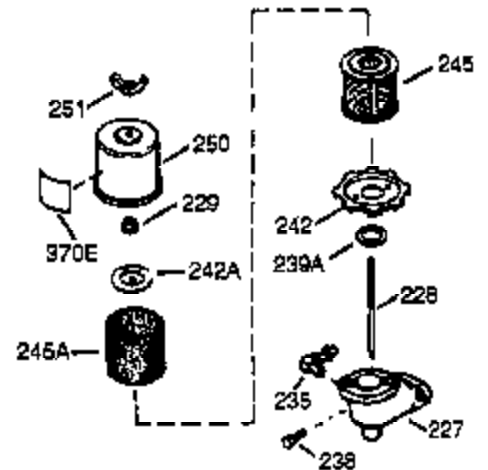
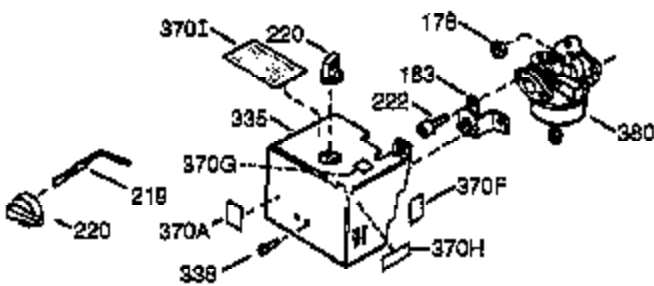
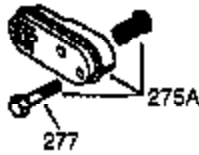
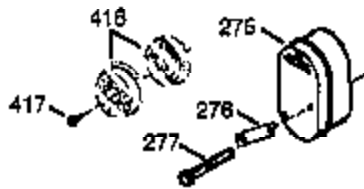
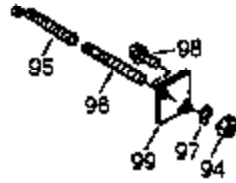

OPTIONAL 110 - 120 VOLT  
STARTER MOTOR KIT



396

| Ref # | Part Number | Qty | Description                          |
|-------|-------------|-----|--------------------------------------|
|       | 16 37729    | 1   | Governor Lever                       |
|       | 17 29916    | 1   | Governor Lever Clamp                 |
|       | 18 651018   | 1   | Screw, T-15, 8-32 x 19/64"           |
|       | 35 29826    | 1   | Screw, 10-32 x 3/4"                  |
|       | 36 29918    | 1   | Lock Washer                          |
|       | 37A 30322   | 1   | Lock Nut 8-32                        |
|       | 37 29216    | 1   | Lock Nut 10-32                       |
|       | 38 29642    | 1   | Retaining Ring                       |
|       | 103A 650767 | 1   | Screw, 8-23 x 27/64"                 |
|       | 110A 36964  | 1   | Ground Wire                          |
|       | 110B 37602  | 1   | Ground Wire                          |
|       | 111A 611224 | 1   | Rocker Switch                        |
|       | 131 650694A | 5   | Screw, 5/16-18 x 2"                  |
|       | 151A 40016A | 1   | Intake Valve Seal                    |
|       | 178 29752   | 2   | Nut & Lock Washer, 1/4-28            |
|       | 200 730136A | 1   | Control Bracket (Incl. 203 thru 211) |
|       | 203 31342   | 1   | Compression Spring                   |
|       | 204 651029  | 1   | Screw, T-10, 5-40 x 7/16"            |
|       | 238 28820   | 2   | Screw, 10-32 x 1/2"                  |
|       | 242 31691   | 1   | Air Cleaner Base                     |
|       | 245 30727   | 1   | Air Cleaner Filter                   |
|       | 245A 35974  | 1   | Air Cleaner Filter                   |
|       | 250 31715   | 1   | Air Cleaner Body                     |
|       | 275 40001A  | 1   | Muffler (W/Catalyst)                 |
|       | 277 650988  | 2   | Screw, 1/4-20 x 2-9/32"              |
|       | 279A 30063  | 1   | Screw, T-30, 1/4-20 x 1/2"           |
|       | 279 650488  | 1   | Screw, 1/4-20 x 1-1/4"               |
|       | 280 37633   | 1   | Heat Shield                          |
|       | 370A 36261  | 1   | Instruction Decal                    |
|       | 380 640134  | 1   | Carburetor (Incl. 184)               |