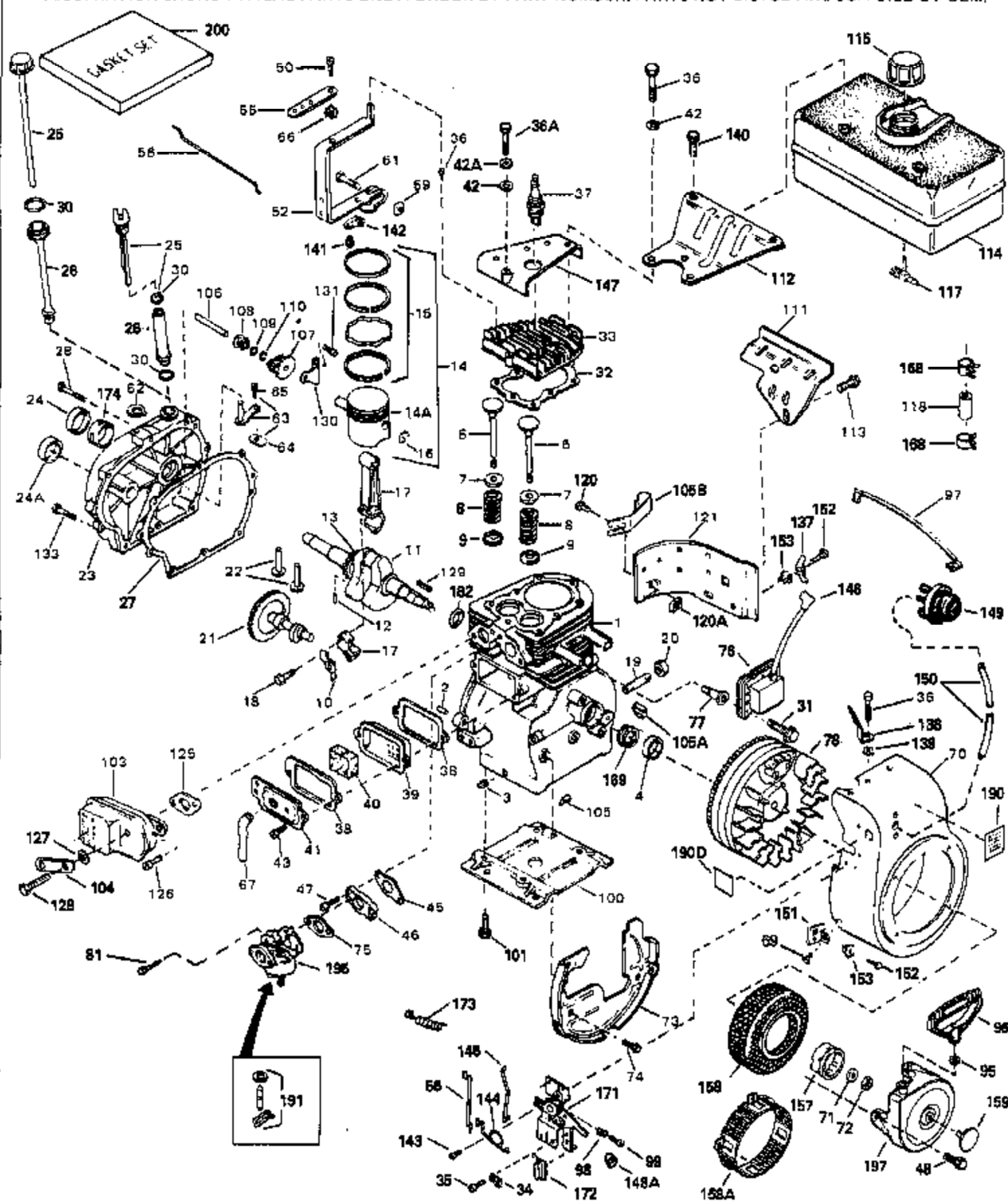

ILLUSTRATION SHOWS TYPICAL PARTS ONLY. ORDER BY PART NUMBER. PARTS NOT LISTED ARE SUPPLIED BY OEM.



| Ref # | Part Number | Qty | Description |
|-------|-------------|-----|--|
| 1 | 32586C | | Cylinder (Incl. 2, 3 & 4) (2-3/4" Bore) |
| 2 | 27652 | | Pin, Dowel |
| 3 | 27642 | | Plug, Oil drain |
| 4 | 32630 | | Seal, Oil |
| 5 | 32783 | | Intake Valve (Std.) (Incl. 9) |
| 5 | 32784 | | Intake Valve (1/32" OS) (Incl. 9) |
| 6 | 27878A | | Exhaust Valve (Std.) (Incl. 9) |
| 6 | 27880A | | Exhaust Valve (1/32" OS) (Incl. 9) |
| 7 | 27882 | | Cap, Upper valve spring |
| 8 | 27881 | | Spring, Valve |
| 9 | 32581 | | Cap, Lower valve spring |
| 10 | 34242 | | Dipper, Oil |
| 11 | 34894 | | Crankshaft |
| 12 | 29783 | | Crankshaft Gear Pin (Used on early prod.) |
| 13 | 27884 | | Gear, Crankshaft (Used on early production) |
| 14 | 34517 | | Piston, Pin & Ring Set (Std.) (2-3/4" Bore) |
| 14 | 34518 | | Piston, Pin & Ring Set (.010" OS) |
| 14 | 34519 | | Piston, Pin & Ring Set (.020" OS) |
| 14A | 32592B | | Piston & Pin Ass'y. (Std.) (2-3/4") (Incl. 16) |
| 14A | 32593B | | Piston & Pin Ass'y. (.010" OS) (Incl. 16) |
| 14A | 32594B | | Piston & Pin Ass'y. (.020" OS) (Incl. 16) |
| 15 | 32595 | | Ring Set (Std.) (2-3/4" Bore) |
| 15 | 32596 | | Ring Set (.010" OS) |
| 15 | 32597 | | Ring Set (.020" OS) |
| 16 | 27888 | | Ring, Piston pin retaining |
| 17 | 32591C | | Rod Assy., Connecting (Incl. 10 & 18) |
| 18 | 650662C | | Bolt, Connecting rod (2 each) |
| 19 | 32678 | | Nipple, Pipe |
| 20 | 30969 | | Cap, Oil drain |
| 21 | 32115 | | Camshaft (MCR) |
| 22 | 34034 | | Lifter, Valve |
| 23 | 31303B | | Cover, Cylinder (Incl. 24 & 106) |
| 24 | 28427 | | Seal, Oil |
| 25 | 34011A | | Dipstick (Incl. 30) |
| 26 | 33893A | | Tube, Oil filler |
| 27 | 30684 | | * Gasket, Cylinder cover |
| 28 | 650488 | | Screw, 1/4-20 x 1-1/4" |
| 30 | 33590 | | "O" Ring |
| 31 | 650489 | | Screw, 1/4-20 x 5/8" |
| 32 | 32631A | | * Gasket, Cylinder head |
| 33 | 30938A | | Head, Cylinder |
| 34 | 27793 | | Clip, Conduit (Use as required) |
| 35 | 28942 | | Screw, 10-32 x 3/8" (Use as required) |
| 36 | 650697A | | Screw, 5/16-18 x 2-1/2" (Use as required) |
| 36 | 650695A | | Screw, 5/16-18 x 2-1/4" (Use as required) |
| 36 | 650694A | | Screw, 5/16-18 x 2" (Use as required) |
| 37 | 33636 | | Resistor Spark Plug (RJ-8C) |
| 38 | 27896A | | * Gasket, Breather |
| 39 | 28423 | | Body, Breather |
| 40 | 28424 | | Element, Breather |
| 41 | 28425 | | Cover, Valve spring |
| 42A | 650690 | | Washer, Belleville (Use as required) |
| 42 | 650691 | | Washer, Flat (Use as required) |
| 43 | 650128 | | Screw, 10-24 x 1/2" |
| 45 | 27915A | | * Gasket, Intake |
| 46 | 34712 | | Flange, Carburetor |
| 47 | 30196 | | Screw, 5/16-18 x 3/4" |
| 48 | 29716 | | Screw, 1/4-28 x 7/16" |

| Ref # | Part Number | Qty | Description |
|-------|-------------|-----|--|
| 50 | 650548 | | Screw, 8-32 x 5/16" |
| 52 | 33454 | | Lever Assy., Governor |
| 56 | 34662 | | Link, Throttle |
| 57 | 730130 | | Exhaust Adaptor Kit (Incl.58,125) (As req.) |
| 58 | 30196 | | Screw, 5/16-18 x 3/4" (Use as require d) |
| 59 | 29216 | | Locknut, 10-32 |
| 61 | 29826 | | Screw, 10-32 x 3/4" |
| 62 | 29642 | | Ring, Retaining |
| 63 | 30699C | | Rod, Governor (Incl. 64 & 65) |
| 64 | 30700 | | Yoke, Governor |
| 65 | 650494 | | Screw, 6-40 x 5/16" |
| 66 | 29918 | | Washer, Lock #8 E.T. |
| 67 | 35350 | | Tube, Breather |
| 69 | 29747B | | Screw, 5/16-24 x 21/32" |
| 70 | 35260 | | Blower Housing (For elec.strt.)(Incl. 134,135) |
| 71 | 650815 | | Washer, Belleville |
| 72 | 8116 | | Nut, Hex |
| 73 | 29536 | | Blower Housing Baffle (Without electric starter knock-out) (Use as required) |
| 73 | 35256A | | Blower Housing Baffle (With electric starter knock-out) (Use as required) |
| 74 | 650561 | | Screw, 1/4-20 x 5/8" |
| 75 | 31688A | | * Gasket, Carburetor |
| 81 | 650517 | | Screw, 1/4-20 x 27/32" |
| 82 | 730561 | | Air Cleaner Kit (Incl. 38, 67A, 68, 83, 84A,85, 87, 88, 89, 156 & 190A) (Use only on engines with an externally vented fully adjustable carburetor) |
| 84A | 34819 | | Elbow Assy., Air cleaner (Incl. 84, 90, 91, 92 & 92A)(Use in 730561 assy. only) |
| 95 | 650168 | | Washer, Flat |
| 96 | 590574 | | Handle, Mitten grip |
| 97 | 34240 | | Wire Assy., Ground |
| 98 | 31342 | | Spring, Compression |
| 99 | 650549 | | Screw, 5-40 x 7/16" |
| 100 | 29538 | | Base, Engine mounting |
| 101 | 650542 | | Screw, 5/16-18 x 3/4" |
| 103A | 391026 | | Muffler (Incl. 183, 184 & 185) (Thisspark arrester muffler can be used on any model) |
| 103 | 32401 | | Muffler |
| 105 | 34246 | | Clip, Ground wire (Use as required) |
| 106 | 31845 | | Shaft, Mechanical governor |
| 107 | 30591 | | Gear Assy., Governor |
| 108 | 30588A | | Spool, Governor |
| 109 | 35479 | | Washer, Flat |
| 110 | 29193 | | Ring, Retaining |
| 111 | 34158 | | Bracket, Fuel tank mounting |
| 112 | 34159 | | Plate, Fuel tank mounting |
| 113 | 650561 | | Screw, 1/4-20 x 5/8" |
| 114 | 34186A | | Fuel Tank (Incl. 115 & 168) NOTE: These tanks were built with different size fuel inlet openings. Tanks with the 1-3/16" I.D. opening use fuel cap 33032 or 34210. Tanks with the 1-1/2" I.D. opening use fuel cap 35355. |
| 115 | 410144B | | Fuel Cap (White Plastic) (Std)(Use as req.) |

| Ref # | Part Number | Qty | Description |
|-------|-------------|-----|--|
| 115 | 33032 | | Fuel Cap (Red Plastic) (Spurt Resistant, Low Profile) (Use as required) |
| 115 | 34210 | | Fuel Cap (Red Plastic) (Spurt Resistant, High Profile) (Use as required) |
| 115 | 35355 | | Fuel Cap (Red Plastic) (Use as required) |
| 118 | 29774 | | Fuel Line (Braided 8-1/4")(21 cm)(As req.) |
| 118 | 30962 | | Fuel Line (Braided 32")(81 cm)(Use as req.) |
| 120 | 650128 | | Screw, 10-24 x 1/2" |
| 121 | 30622A | | Extension, Blower housing |
| 125 | 27930A | | * Gasket, Exhaust |
| 126 | 30196 | | Screw, 5/16-18 x 3/4" |
| 127 | 26073 | | Washer, Flat |
| 128 | 650694A | | Screw, 5/16-18 x 2" |
| 129 | 32589 | | Key, Flywheel |
| 130 | 31843A | | Bracket, Governor gear |
| 131 | 650836 | | Screw, 10-24 x 1/2" |
| 133 | 650493 | | Screw, 1/4-20 x 1-3/4" |
| 134 | 33013 | | Cover, Starter bubble |
| 135 | 650760 | | Screw, 8-32 x 3/8" |
| 140 | 650665 | | Screw, 1/4-15 x 7/8" |
| 141 | 30322 | | Locknut, 8-32 |
| 142 | 29916 | | Clamp, Governor lever |
| 143 | 650821 | | Screw, 10-32 x 1/2" |
| 144 | 34663 | | Spring, Speed control |
| 145 | 34661 | | Link, Governor |
| 146 | 610118 | | Cover, Spark plug (Use as required) |
| 147 | 30939A | | Cover Assy., Cylinder |
| 148 | 35439 | | Knob, Control |
| 148A | 32410 | | Knob, Control |
| 149 | 34814 | | Primer Assy. |
| 150 | 32180C | | Line, Primer |
| 151 | 34126 | | Bracket, Grommet mounting |
| 152 | 650760 | | Screw, 8-32 x 3/8" |
| 153 | 28545 | | Grommet, Plastic |
| 154 | 650257 | | Screw, 8-32 x 5/16" |
| 155 | 34672 | | Cover, Carburetor |
| 157 | 32125 | | Cup, Starter |
| 158 | 35009 | | Screen, Starter |
| 163 | 32398 | | Bracket, Choke |
| 164 | 28820 | | Screw, 10-32 x 1/2" |
| 165 | 650760 | | Screw, 8-32 x 3/8" |
| 166 | 650765 | | Screw, 10-32 x 1/2" |
| 167 | 650764 | | Nut, "U" Type |
| 168 | 26460 | | Clamp, Fuel line (Use as required) |
| 170 | 33876 | | Gasket, Stator |
| 171 | 34677 | | Control Bracket (Incl. 98, 99, 144 & 172) |
| 172 | 610973 | | Terminal Assy. (Use as required) |
| 174 | 31546 | | Bushing, Crankshaft |
| 175 | 34127 | | Guard, Starter |
| 176 | 32576 | | Seal, Snow guard |
| 183 | 33323 | | Screen, Muffler (Use as required) |
| 184 | 650578 | | Screw, 8-18 x 3/8" (Use as required) |
| 185 | 33700 | | Cover & Tube, Muffler (Use as required) |
| 188B | 32204 | | Bracket, Starter air cleaner Can be used on H70 with stamped steel starter |

| Ref # | Part Number | Qty | Description |
|-------|-------------|-----|---|
| 188C | 34870 | | Decal, Instruction Can be used on H70 with stamped steel starter |
| 188 | 730571 | | Starter Muff Kit (Incl.188A,188B & 18 8C) Can be used on H70 with stamped steel starter |
| 188A | 32203 | | Air Cleaner, Starter Can be used on H70 with stamped steel starter |
| 190D | 34346 | | Decal, Instruction |
| 190 | 34144 | | Decal, Primer |
| 190 | 34170 | | Decal, Instruction |
| 190B | 35344 | | Decal, Throttle |
| 190C | 34418 | | Decal, Choke |
| 190C | 34414 | | Decal, Warning |
| 191 | 631021 | | Inlet Needle, Seat & Clip Assy. |
| 192 | 30547A | | Contact Assy., Breaker |
| 193 | 30548B | | Condenser |
| 195 | 632371 | | Carburetor (Incl. 75) (Refer to Division 5, Section A, page 198 for breakdown) |
| 196 | 611043 | | Magneto NOTE: The complete magneto is not available as an assembly. The magneto number is shown for reference purposes only. Order component parts individually, as shown in partslist. (Refer to Division 5, Section B, page 39 for breakdown) |
| 197 | 590576 | | Rewind Starter (Refer to Division 5, Section C, page 29 for breakdown) |
| 199 | 611042 | | Flywheel (Ring gear flywheel required on engines using 110-120 volt starter kits listed above) (For use with Std. point ignition) |
| 199 | 611085 | | Flywheel (Ring gear flywheel required on engines using 110-120 volt starter kits listed above) (For use with solid state ignition) |
| 200 | 33239A | | Gasket Set (Incl. items marked*) |