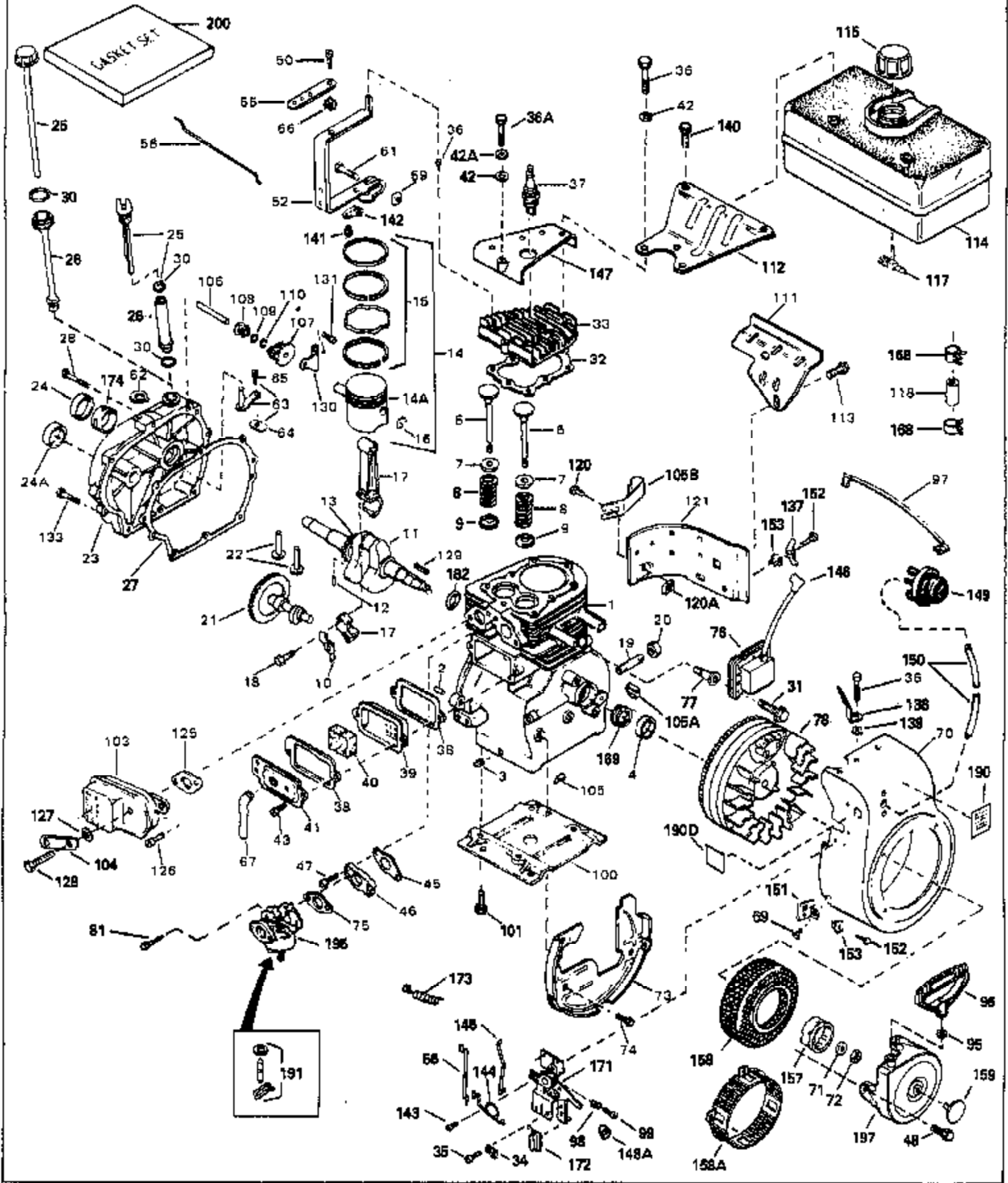

ILLUSTRATION SHOWS TYPICAL PARTS ONLY. ORDER BY PART NUMBER. PARTS NOT LISTED ARE SUPPLIED BY OEM.



| Ref # | Part Number | Qty | Description                                    |
|-------|-------------|-----|--|
| 1     | 32769B      |     | Cylinder (Incl. 2, 3 & 4) (2-3/4" Bore)        |
| 2     | 27652       |     | Pin, Dowel                                     |
| 3     | 27642       |     | Plug, Oil drain                                |
| 4     | 32630       |     | Seal, Oil                                      |
| 5     | 32783       |     | Intake Valve (Std.) (Incl. 9)                  |
| 5     | 32784       |     | Intake Valve (1/32" OS) (Incl. 9)              |
| 6     | 27878A      |     | Exhaust Valve (Std.) (Incl. 9)                 |
| 6     | 27880A      |     | Exhaust Valve (1/32" OS) (Incl. 9)             |
| 7     | 27882       |     | Cap, Upper valve spring                        |
| 8     | 27881       |     | Spring, Valve                                  |
| 9     | 32581       |     | Cap, Lower valve spring                        |
| 10    | 34242       |     | Dipper, Oil                                    |
| 11    | 35215       |     | Crankshaft                                     |
| 12    | 29783       |     | Crankshaft Gear Pin (Used on early prod.)      |
| 13    | 27884       |     | Gear, Crankshaft (Used on early production)    |
| 14A   | 32770B      |     | Piston & Pin Ass'y. (Std.) (2-3/4") (Incl. 16) |
| 14A   | 32771B      |     | Piston & Pin Ass'y. (.010" OS) (Incl. 16)      |
| 14A   | 32772B      |     | Piston & Pin Ass'y. (.020" OS) (Incl. 16)      |
| 14    | 34528       |     | Piston, Pin & Ring Set (Std.) (2-3/4" Bore)    |
| 14    | 34529       |     | Piston, Pin & Ring Set (.010" OS)              |
| 14    | 34530       |     | Piston, Pin & Ring Set (.020" OS)              |
| 15    | 32595       |     | Ring Set (Std.) (2-3/4" Bore)                  |
| 15    | 32596       |     | Ring Set (.010" OS)                            |
| 15    | 32597       |     | Ring Set (.020" OS)                            |
| 16    | 27888       |     | Ring, Piston pin retaining                     |
| 17    | 32591C      |     | Rod Assy., Connecting (Incl. 10 & 18)          |
| 18    | 650662C     |     | Bolt, Connecting rod (2 each)                  |
| 21    | 32115       |     | Camshaft (MCR)                                 |
| 22    | 34034       |     | Lifter, Valve                                  |
| 23    | 31451A      |     | Cylinder Cover (Incl. 24, 106, 178, 179 & 180) |
| 24    | 28460       |     | Seal, Oil                                      |
| 25    | 31297       |     | Dipstick (Incl. 30)                            |
| 27    | 30684       |     | * Gasket, Cylinder cover                       |
| 28    | 650451      |     | Screw, 1/4-20 x 1"                             |
| 30    | 29673       |     | * Gasket, Oil fill                             |
| 32    | 32631A      |     | * Gasket, Cylinder head                        |
| 33    | 30938A      |     | Head, Cylinder                                 |
| 34    | 27793       |     | Clip, Conduit (Use as required)                |
| 35    | 28942       |     | Screw, 10-32 x 3/8" (Use as required)          |
| 36    | 650697A     |     | Screw, 5/16-18 x 2-1/2" (Use as required)      |
| 36    | 650695A     |     | Screw, 5/16-18 x 2-1/4" (Use as required)      |
| 36    | 650694A     |     | Screw, 5/16-18 x 2" (Use as required)          |
| 37    | 33636       |     | Resistor Spark Plug (RJ-8C)                    |
| 38    | 27896A      |     | * Gasket, Breather                             |
| 39    | 28423       |     | Body, Breather                                 |
| 40    | 28424       |     | Element, Breather                              |
| 41    | 28425       |     | Cover, Valve spring                            |
| 42    | 650691      |     | Washer, Flat (Use as required)                 |
| 42A   | 650690      |     | Washer, Belleville (Use as required)           |
| 43    | 650128      |     | Screw, 10-24 x 1/2"                            |
| 45    | 27915A      |     | * Gasket, Intake                               |
| 46    | 34712       |     | Flange, Carburetor                             |
| 47    | 30196       |     | Screw, 5/16-18 x 3/4"                          |
| 48    | 29716       |     | Screw, 1/4-28 x 7/16"                          |
| 50    | 650548      |     | Screw, 8-32 x 5/16"                            |
| 52    | 33454       |     | Lever Assy., Governor                          |
| 56    | 34662       |     | Link, Throttle                                 |
| 57    | 730130      |     | Exhaust Adaptor Kit (Incl. 58, 125) (As req.)  |

| Ref # | Part Number | Qty | Description   |
|-------|-------------|-----|---|
| 58    | 30196       |     | Screw, 5/16-18 x 3/4" (Use as require d)  |
| 59    | 29216       |     | Locknut, 10-32  |
| 61    | 29826       |     | Screw, 10-32 x 3/4"   |
| 62    | 29642       |     | Ring, Retaining   |
| 63    | 30699C      |     | Rod, Governor (Incl. 64 & 65)   |
| 64    | 30700       |     | Yoke, Governor  |
| 65    | 650494      |     | Screw, 6-40 x 5/16"   |
| 66    | 29918       |     | Washer, Lock #8 E.T.  |
| 67A   | 32447       |     | Tube, Breather  |
| 68    | 32446       |     | Grommet, Breather tube  |
| 69    | 29747B      |     | Screw, 5/16-24 x 21/32"   |
| 70    | 32158E      |     | Blower Housing (For elec.strt.)(Incl. 134,135)  |
| 71    | 650815      |     | Washer, Belleville  |
| 72    | 8116        |     | Nut, Hex  |
| 73    | 29536       |     | Blower Housing Baffle (Without electric starter knock-out)<br>(Use as required)   |
| 73    | 35256A      |     | Blower Housing Baffle (With electric starter knock-out) (Use<br>as required)  |
| 73    | 35326       |     | Baffle, Blower housing  |
| 74    | 650561      |     | Screw, 1/4-20 x 5/8"  |
| 75    | 31688A      |     | * Gasket, Carburetor  |
| 76    | 34443A      |     | Solid State Assy. (Incl. 146)   |
| 77    | 650872      |     | Stud, Solid state mounting  |
| 78    | 611089      |     | Flywheel (7 amp, w/ring gear)   |
| 79    | 611097      |     | Alternator Coil (7 amp DC)(Incl.122,1 23,123A)  |
| 80    | 650873      |     | Screw, 1/4-20 x 3/4"  |
| 81    | 650517      |     | Screw, 1/4-20 x 27/32"  |
| 82    | 730561      |     | Air Cleaner Kit (Incl. 38, 67A, 68, 83, 84A,85, 87, 88, 89, 156<br>& 190A) (Use only on engines with an externally vented fully<br>adjustable carburetor) |
| 83    | 27272A      |     | * Gasket, Air cleaner   |
| 84A   | 34819       |     | Elbow Assy., Air cleaner (Incl. 84, 90, 91, 92 & 92A)(Use in<br>730561 assy. only)  |
| 84    | 34780       |     | Elbow, Air cleaner  |
| 85    | 650163      |     | Screw, 10-32 x 7/8"   |
| 86    | 30675       |     | Fitting, Breather   |
| 87    | 34782       |     | Filter, Air cleaner (Incl. 93)  |
| 88    | 34783       |     | Filter, Pre-air   |
| 89    | 34781       |     | Cover, Air cleaner  |
| 90    | 34699       |     | Bracket, Air cleaner  |
| 91    | 34698A      |     | Gasket  |
| 92A   |             |     | Pop Rivet (1/8" dia.) (Can be bought locally)   |
| 92    | 650826      |     | Stud, 1/4-20 x 6.20 threaded  |
| 93    | 650825      |     | Nut & Lockwasher, 1/4-20  |
| 98    | 31342       |     | Spring, Compression   |
| 99    | 650549      |     | Screw, 5-40 x 7/16"   |
| 100   | 29538       |     | Base, Engine mounting   |
| 101   | 650542      |     | Screw, 5/16-18 x 3/4"   |
| 103A  | 391026      |     | Muffler (Incl. 183, 184 & 185) (Thisspark arrester muffler can<br>be used on any model)   |
| 103   | 32401       |     | Muffler   |
| 105   | 34246       |     | Clip, Ground wire (Use as required)   |
| 106   | 31845       |     | Shaft, Mechanical governor  |
| 107   | 30591       |     | Gear Assy., Governor  |
| 108   | 30588A      |     | Spool, Governor   |

| Ref # | Part Number | Qty | Description   |
|-------|-------------|-----|---|
| 109   | 35479       |     | Washer, Flat  |
| 110   | 29193       |     | Ring, Retaining   |
| 111   | 34158       |     | Bracket, Fuel tank mounting   |
| 112   | 34159       |     | Plate, Fuel tank mounting   |
| 113   | 650561      |     | Screw, 1/4-20 x 5/8"  |
| 114   | 34186A      |     | Fuel Tank (Incl. 115 & 168) NOTE: These tanks were built with different size fuel inlet openings. Tanks with the 1-3/16" I.D. opening use fuel cap 33032 or 34210. Tanks with the 1-1/2" I.D. opening use fuel cap 35355. |
| 115   | 410144B     |     | Fuel Cap (White Plastic) (Std)(Use as req.)   |
| 115   | 33032       |     | Fuel Cap (Red Plastic) (Spurt Resistant, Low Profile) (Use as required)   |
| 115   | 34210       |     | Fuel Cap (Red Plastic) (Spurt Resistant, High Profile) (Use as required)  |
| 115   | 35355       |     | Fuel Cap (Red Plastic) (Use as required)  |
| 118   | 29774       |     | Fuel Line (Braided 8-1/4")(21 cm)(As req.)  |
| 118   | 30962       |     | Fuel Line (Braided 32")(81 cm)(Use as req.)   |
| 119A  | 650874      |     | Screw, 10-32 x 15/32"   |
| 119   | 611098      |     | Regulator (7 amp D.C.)  |
| 120   | 650128      |     | Screw, 10-24 x 1/2"   |
| 121   | 30622A      |     | Extension, Blower housing   |
| 122   | 610922      |     | Terminal  |
| 123A  | 610824      |     | Connector Body  |
| 123   | 610921      |     | Connector Body  |
| 124   | 35189       |     | Spacer, Coil Assy.  |
| 125   | 27930A      |     | * Gasket, Exhaust   |
| 126   | 30196       |     | Screw, 5/16-18 x 3/4"   |
| 127   | 26073       |     | Washer, Flat  |
| 128   | 650694A     |     | Screw, 5/16-18 x 2"   |
| 129   | 32589       |     | Key, Flywheel   |
| 130   | 31843A      |     | Bracket, Governor gear  |
| 131   | 650836      |     | Screw, 10-24 x 1/2"   |
| 133   | 650599      |     | Screw, 1/4-20 x 1-1/2"  |
| 140   | 650665      |     | Screw, 1/4-15 x 7/8"  |
| 141   | 30322       |     | Locknut, 8-32   |
| 142   | 29916       |     | Clamp, Governor lever   |
| 143   | 650821      |     | Screw, 10-32 x 1/2"   |
| 144   | 34663       |     | Spring, Speed control   |
| 145   | 34661       |     | Link, Governor  |
| 146   | 610118      |     | Cover, Spark plug (Use as required)   |
| 147   | 30939A      |     | Cover Assy., Cylinder   |
| 156   | 650513      |     | Nut, Wing   |
| 157   | 32125       |     | Cup, Starter  |
| 158   | 35009       |     | Screen, Starter   |
| 168   | 26460       |     | Clamp, Fuel line (Use as required)  |
| 169   | 31461       |     | Bushing, Crankshaft   |
| 171   | 34664       |     | Control Bracket (Incl. 98, 99, 144 & 172)   |
| 172   | 610973      |     | Terminal Assy. (Use as required)  |
| 177   | 31793       |     | Bearing, Ball   |
| 178   | 31855       |     | Retainer, Bearing   |
| 179   | 650778      |     | Washer, E.T. w/sealing compound   |
| 180   | 650580      |     | Locknut   |
| 181   | 31792       |     | Washer, Thrust  |
| 182   | 650625      |     | Washer, Thrust  |
| 183   | 33323       |     | Screen, Muffler (Use as required)   |
| 184   | 650578      |     | Screw, 8-18 x 3/8" (Use as required)  |

| Ref # | Part Number | Qty | Description   |
|-------|-------------|-----|---|
| 185   | 33700       |     | Cover & Tube, Muffler (Use as require d)  |
| 186   | 30063       |     | Screw, 1/4-20 x 1/2"  |
| 188B  | 32204       |     | Bracket, Starter air cleaner Can be used on H70 with stamped steel starter  |
| 188C  | 34870       |     | Decal, Instruction Can be used on H70 with stamped steel starter  |
| 188A  | 32203       |     | Air Cleaner, Starter Can be used on H70 with stamped steel starter  |
| 188   | 730571      |     | Starter Muff Kit (Incl.188A,188B & 18 8C) Can be used on H70 with stamped steel starter   |
| 190A  | 34704       |     | Decal, Air cleaner  |
| 190   | 35532       |     | Decal, Name   |
| 190D  | 34346       |     | Decal, Instruction  |
| 191   | 631021      |     | Inlet Needle, Seat & Clip Assy.   |
| 195   | 632201      |     | Carburetor (Incl. 75) (Refer to Division 5, Section A, page 176 for breakdown)  |
| 197   | 590420A     |     | Rewind Starter (Refer to Division 5, Section C, page 25 for breakdown)  |
| 198   | 33606       |     | Electric Starter Motor (12 Volt) (Refer to Division 5, Section C, page 20 for breakdown)  |
| 199   | 611042      |     | Flywheel (Ring gear flywheel requiredon engines using 110-120 volt starter kits listed above) (For use with Std. point ignition)  |
| 199   | 611085      |     | Flywheel (Ring gear flywheel requiredon engines using 110-120 volt starter kits listed above) (For use with solid state ignition) |
| 200   | 33239A      |     | Gasket Set (Incl. items marked*)  |