

| Ref # | Part Number | Qty | Description |
|-------|-------------|-----|---|
| 1 | 36469A | 1 | Cylinder (Incl. 2,20,72 & 125) |
| 2 | 26727 | 2 | Dowel Pin |
| 14 | 28277 | 1 | Washer |
| 15 | 31334 | 1 | Governor Rod |
| 16 | 31510 | 1 | Governor Lever |
| 17 | 31335 | 1 | Governor Lever Clamp |
| 18 | 650548 | 1 | Screw, 8-32 x 5/16" |
| 19 | 31426 | 1 | Extension Spring |
| 20 | 32600 | 1 | Oil Seal |
| 25 | 36552 | 1 | Blower Housing Baffle (Incl. 262) |
| 25A | 35883 | 1 | Baffle Extension |
| 26A | 650926 | 1 | Screw, 8-32 x 21/64" |
| 26 | 650802 | 2 | Screw, 1/4-20 x 5/8" |
| 30 | 34747 | 1 | Crankshaft |
| 40 | 36073 | 1 | Piston, Pin & Ring Set (Std.) |
| 40 | 36074 | 1 | Piston, Pin & Ring Set (.010" OS) |
| 40 | 36075 | 1 | Piston, Pin & Ring Set (.020" OS) |
| 41 | 36070 | 1 | Piston & Pin Ass'y. (Std.) (Incl. 43) |
| 41 | 36071 | 1 | Piston & Pin Ass'y. (.010" OS) (Incl. 43) |
| 41 | 36072 | 1 | Piston & Pin Ass'y. (.020" OS) (Incl. 43) |
| 42 | 36076 | 1 | Ring Set (Std.) |
| 42 | 36077 | 1 | Ring Set (.010" OS) |
| 42 | 36078 | 1 | Ring Set (.020" OS) |
| 43 | 20381 | 2 | Piston Pin Retaining Ring |
| 45 | 32875A | 1 | Connecting Rod Ass'y. (Incl. 46 & 49) |
| 46 | 32610A | 2 | Connecting Rod Bolt |
| 48 | 27241 | 2 | Valve Lifter |
| 49 | 32654 | 1 | Oil Dipper |
| 50 | 33158 | 1 | Camshaft (BCR) |
| 60 | 29745 | 1 | Blower Housing Extension |
| 64A | 8345 | 1 | Washer |
| 64 | 30063 | 1 | Screw, Torx T-30, 1/4-20 x 1/2" |
| 65 | 650128 | 1 | Screw, 10-24 x 1/2" |
| 69 | 27677A | 1 | * Cylinder Cover Gasket |
| 70 | 30756C | 1 | Cylinder Cover (Incl. 75 thru 86,311) |
| 72 | 27642 | 2 | Oil Drain Plug |
| 72A | 28582 | 1 | Oil Drain Plug |
| 75 | 28540 | 1 | Oil Seal |
| 80 | 30574A | 1 | Governor Shaft |
| 81 | 30590A | 1 | Washer |
| 82 | 30591 | 1 | Governor Gear Ass'y. (Incl. 81) |
| 83 | 30588A | 1 | Governor Spool |
| 86 | 650488 | 7 | Screw, 1/4-20 x 1-1/4" |
| 89 | 610961 | 1 | Flywheel Key |
| 90 | 611195 | 1 | Flywheel |
| 92 | 650815 | 1 | Belleville Washer |
| 93 | 650816 | 1 | Flywheel Nut |
| 100 | 34443A | 1 | Solid State Ignition |
| 102 | 650872 | 2 | Solid State Mounting Stud |
| 103 | 651007 | 2 | Screw, Torx T-15, 10-24 x 15/16" |
| 110 | 35182 | 1 | Ground Wire |
| 119 | 36443 | 1 | * Cylinder Head Gasket |
| 120 | 36441 | 1 | Cylinder Head (Incl. 131) |
| 125 | 36471 | 1 | Exhaust Valve (Std.) (Incl. 151) |
| 125 | 36472 | 1 | Exhaust Valve (1/32" OS) (Incl. 151) |
| 126 | 32644A | 1 | Intake Valve (Std.) (Incl. 151) |
| 126 | 32645A | 1 | Intake Valve (1/32" OS) (Incl. 151) |
| 127 | 650691 | 1 | Washer |

| Ref # | Part Number | Qty | Description |
|-------|-------------|-----|---|
| 130A | 6021A | 2 | Screw, 5/16-18 x 1-1/2" |
| 130 | 650694A | 5 | Screw, 5/16-18 x 2" |
| 130B | 650818 | 1 | Screw, 5/16-18 x 1-1/2" |
| 135 | 33636 | 1 | Resistor Spark Plug (RJ17LM) |
| 150 | 31672 | 2 | Valve Spring |
| 151 | 31673 | 2 | Valve Spring Cap |
| 169 | 27234A | 2 | * Valve Cover Gasket |
| 170 | 27666 | 1 | Breather Body |
| 171 | 31410 | 1 | Breather Element |
| 172 | 34146 | 1 | Valve Cover |
| 173 | 35350 | 1 | Breather Tube |
| 174 | 30200 | 2 | Screw, 10-24 x 9/16" |
| 178 | 29752 | 2 | Nut & Lock Washer, 1/4-28 |
| 181 | 650870 | 1 | Screw, 1/4-28 x 1-11/16" |
| 182 | 6201 | 1 | Screw, 1/4-28 x 7/8" |
| 184 | 26756 | 1 | * Carburetor To Intake Pipe Gasket |
| 185 | 33666 | 1 | Intake Pipe |
| 186 | 32698 | 1 | Governor Link |
| 200 | 36677 | 1 | Control Bracket (Incl. 203 thru 211) |
| 203 | 31342 | 1 | Compression Spring |
| 204 | 650549 | 1 | Screw, 5-40 x 7/16" |
| 206 | 610973 | 1 | Terminal |
| 209A | 30322 | 2 | Lock Nut, 8-32 |
| 209 | 650139 | 2 | Screw, 8-32 x 3/4" |
| 215 | 32410 | 1 | Control Knob |
| 223 | 30646 | 1 | Screw, 1/4-20 x 1-3/8" |
| 223A | 650664 | 1 | Screw, 1/4-20 x 1-19/32" |
| 224 | 33673A | 1 | * Intake Pipe Gasket |
| 260 | 35585 | 1 | Blower Housing |
| 262 | 650737 | 2 | Screw, 1/4-20 x 1/2" |
| 267 | 34212 | 1 | Hold Down Bracket |
| 268 | 30200 | 1 | Screw, 10-24 x 9/16" |
| 274 | 33670A | 1 | * Exhaust Gasket |
| 275 | 35771 | 1 | Muffler (Incl. 274) |
| 277 | 650327 | 2 | Screw, 1/4-20 x 2-1/2" |
| 285 | 36467A | 1 | Starter Cup |
| 287 | 650926 | 2 | Screw, 8-32 x 21/64" |
| 290 | 30705 | 1 | Fuel Line |
| 292 | 26460 | 2 | Fuel Line Clamp |
| 298 | 650665 | 2 | Screw, 1/4-15 x 7/8" |
| 300 | 35584 | 1 | Fuel Tank (Incl. 292 & 301) |
| 301 | 35355 | 1 | Fuel Cap |
| 313 | 34080 | 1 | Spacer |
| 340 | 36247 | 1 | Fuel Tank Bracket |
| 342A | 650675 | 1 | Washer |
| 342 | 650561 | 1 | Screw, 1/4-20 x 5/8" |
| 345 | 33344 | 1 | Heat Baffle |
| 370A | 36261 | 1 | Lubrication Decal |
| 370K | 36695 | 1 | Starter Decal |
| 370B | 35703 | 1 | Control Decal |
| 380 | 631923 | 1 | Carburetor (Incl. 184) |
| 390 | 590732 | 1 | Rewind Starter (NOTE: This engine could have been built with 590738 starter. Refer to the design of the rope pulley strength ribs for part identification. Individual starter parts do not interchange. Refer to service bulletin 116). |

| Ref # | Part Number | Qty | Description |
|-------|-------------|-----|---|
| 400 | 36444 | 1 | * Gasket Set (Incl. items marked PK i n notes) Incl. part #'s 26756 (1), 27234A (2), 27272A (1), 27677A (1), 29673 (1), 33670A (1), 33673A (1), 36443 (1) |
| 420 | 730225 | 1 | SAE 30 4-Cycle Engine Oil (Quart) |

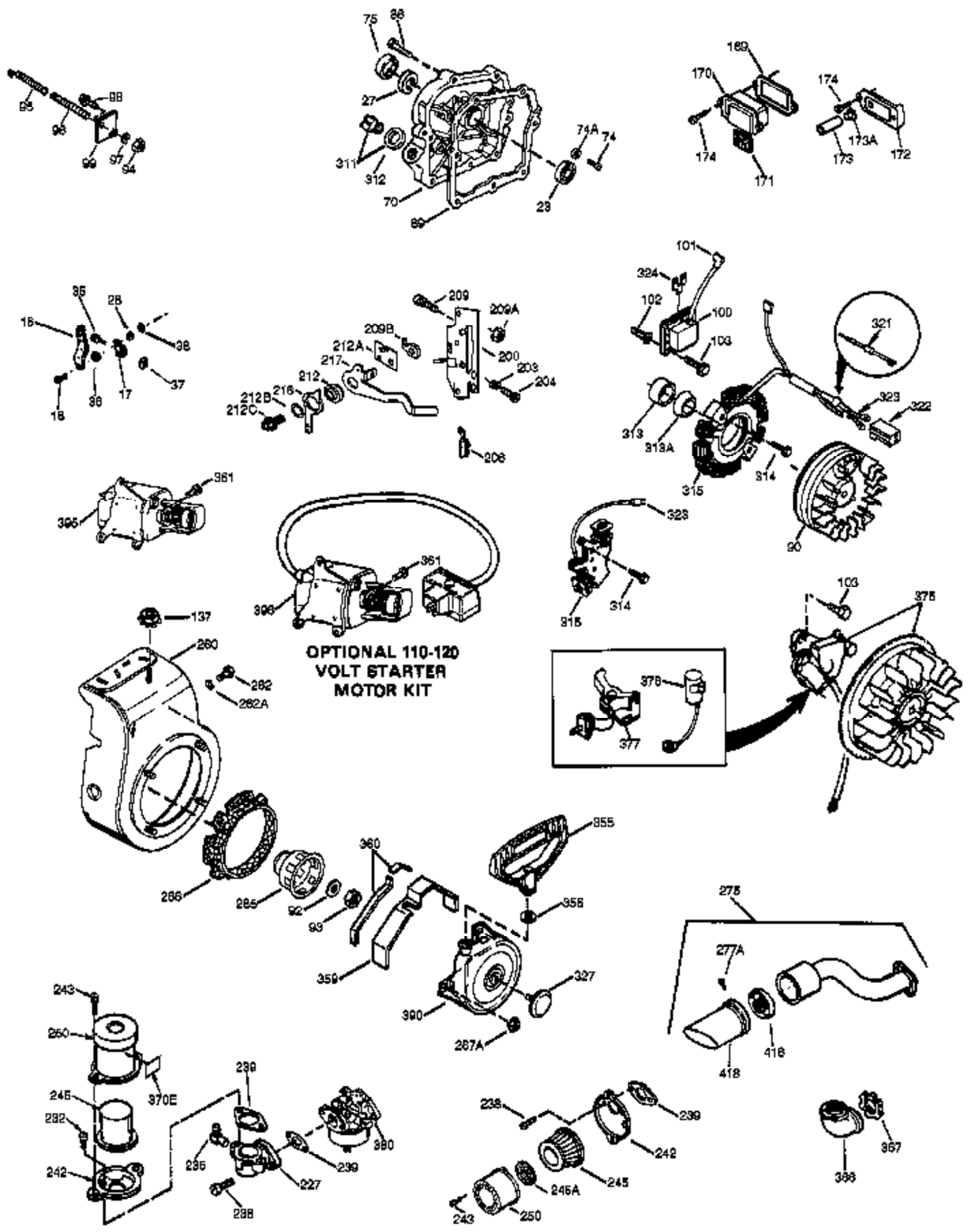

| Ref # | Part Number | Qty | Description |
|-------|-------------|-----|---|
| 16 | 31510 | 1 | Governor Lever |
| 17 | 31335 | 1 | Governor Lever Clamp |
| 18 | 650548 | 1 | Screw, 8-32 x 5/16" |
| 23 | 28458 | 1 | Ball Bearing |
| 27 | 28539 | 1 | Bearing Retainer |
| 69 | 27677A | 1 | * Cylinder Cover Gasket |
| 70 | 30756C | 1 | Cylinder Cover (Incl. 75 thru 86,311) |
| 74 | 30200 | 2 | Screw, 10-24 x 9/16" |
| 74A | 28537 | 2 | Washer |
| 75 | 28540 | 1 | Oil Seal |
| 86 | 650488 | 7 | Screw, 1/4-20 x 1-1/4" |
| 90 | 611195 | 1 | Flywheel |
| 92 | 650815 | 1 | Belleville Washer |
| 93 | 650816 | 1 | Flywheel Nut |
| 100 | 34443A | 1 | Solid State Ignition |
| 102 | 650872 | 2 | Solid State Mounting Stud |
| 103 | 651007 | 2 | Screw, Torx T-15, 10-24 x 15/16" |
| 169 | 27234A | 2 | * Valve Cover Gasket |
| 170 | 27666 | 1 | Breather Body |
| 171 | 31410 | 1 | Breather Element |
| 172 | 34146 | 1 | Valve Cover |
| 173 | 35350 | 1 | Breather Tube |
| 174 | 30200 | 2 | Screw, 10-24 x 9/16" |
| 200 | 36677 | 1 | Control Bracket (Incl. 203 thru 211) |
| 203 | 31342 | 1 | Compression Spring |
| 204 | 650549 | 1 | Screw, 5-40 x 7/16" |
| 206 | 610973 | 1 | Terminal |
| 209A | 30322 | 2 | Lock Nut, 8-32 |
| 209 | 650139 | 2 | Screw, 8-32 x 3/4" |
| 238 | 650152 | 2 | Screw, 8-32 x 3/8" |
| 239 | 27272A | 1 | * Air Cleaner Gasket |
| 242 | 31914 | 1 | Air Cleaner Base |
| 243 | 28820 | 2 | Screw, 10-32 x 1/2" |
| 245 | 30727 | 1 | Air Cleaner Filter |
| 250 | 31715 | 1 | Air Cleaner Cover |
| 262 | 650737 | 2 | Screw, 1/4-20 x 1/2" |
| 275 | 35771 | 1 | Muffler (Incl. 274) |
| 285 | 36467A | 1 | Starter Cup |
| 290 | 30705 | 1 | Fuel Line |
| 298 | 650665 | 2 | Screw, 1/4-15 x 7/8" |
| 311 | 27625 | 2 | Oil Fill Plug |
| 313 | 34080 | 1 | Spacer |
| 380 | 631923 | 1 | Carburetor (Incl. 184) |
| 390 | 590732 | 1 | Rewind Starter (NOTE: This engine could have been built with 590738 starter. Refer to the design of the rope pulley strength ribs for part identification. Individual starter parts do not interchange. Refer to service bulletin 116). |