

| Ref # | Part Number | Qty | Description                                  |
|-------|-------------|-----|--|
| 1     | 36469A      | 1   | Cylinder (Incl. 2,20,72 & 125)               |
| 2     | 26727       | 2   | Dowel Pin                                    |
| 14    | 28277       | 1   | Washer                                       |
| 15    | 31334       | 1   | Governor Rod                                 |
| 16    | 31510       | 1   | Governor Lever                               |
| 17    | 29916       | 1   | Governor Lever Clamp                         |
| 18    | 650548      | 1   | Screw, 8-32 x 5/16"                          |
| 19D   | 33857       | 1   | Extension Spring Ass'y. (Incl. 213)          |
| 19    | 31426       | 1   | Extension Spring                             |
| 20    | 32600       | 1   | Oil Seal                                     |
| 25A   | 35883       | 1   | Baffle Extension                             |
| 25    | 36552       | 1   | Blower Housing Baffle (Incl. 262)            |
| 26A   | 650926      | 1   | Screw, 8-32 x 21/64"                         |
| 26    | 650802      | 2   | Screw, 1/4-20 x 5/8"                         |
| 30    | 34728       | 1   | Crankshaft                                   |
| 40    | 36073       | 1   | Piston, Pin & Ring Set (Std.)                |
| 40    | 36074       | 1   | Piston, Pin & Ring Set (.010" OS)            |
| 40    | 36075       | 1   | Piston, Pin & Ring Set (.020" OS)            |
| 41    | 36070       | 1   | Piston & Pin Ass'y. (Std.) (Incl. 43)        |
| 41    | 36071       | 1   | Piston & Pin Ass'y. (.010" OS) (Incl. 43)    |
| 41    | 36072       | 1   | Piston & Pin Ass'y. (.020" OS) (Incl. 43)    |
| 42    | 36076       | 1   | Ring Set (Std.)                              |
| 42    | 36077       | 1   | Ring Set (.010" OS)                          |
| 42    | 36078       | 1   | Ring Set (.020" OS)                          |
| 43    | 20381       | 2   | Piston Pin Retaining Ring                    |
| 45    | 32875       | 1   | Connecting Rod Ass'y. (Incl. 46 & 49)        |
| 46    | 32610A      | 2   | Connecting Rod Bolt                          |
| 48    | 27241       | 2   | Valve Lifter                                 |
| 49    | 32654       | 1   | Oil Dipper                                   |
| 50    | 33158       | 1   | Camshaft (BCR)                               |
| 60    | 29745       | 1   | Blower Housing Extension                     |
| 62    | 650760      | 1   | Screw, 8-32 x 3/8"                           |
| 63    | 28545       | 1   | Grommet                                      |
| 64A   | 8345        | 1   | Washer                                       |
| 64    | 30063       | 1   | Screw, Torx T-30, 1/4-20 x 1/2"              |
| 65    | 650128      | 1   | Screw, 10-24 x 1/2"                          |
| 68    | 33356       | 1   | Ground Terminal                              |
| 69    | 27677A      | 1   | * Cylinder Cover Gasket                      |
| 70    | 30756C      | 1   | Cylinder Cover (Incl. 72 thru 83, 311 & 312) |
| 72    | 27642       | 2   | Oil Drain Plug                               |
| 75    | 28540       | 1   | Oil Seal                                     |
| 80    | 30574A      | 1   | Governor Shaft                               |
| 81    | 30590A      | 1   | Washer                                       |
| 82    | 30591       | 1   | Governor Gear Ass'y. (Incl. 81)              |
| 83    | 30588A      | 1   | Governor Spool                               |
| 86    | 650488      | 7   | Screw, 1/4-20 x 1-1/4"                       |
| 89    | 610961      | 1   | Flywheel Key                                 |
| 90    | 611195      | 1   | Flywheel                                     |
| 92    | 650815      | 1   | Belleville Washer                            |
| 93    | 650816      | 1   | Flywheel Nut                                 |
| 100   | 34443A      | 1   | Solid State Ignition                         |
| 101   | 27276       | 1   | Spark Plug Cover                             |
| 102   | 650872      | 2   | Solid State Mounting Stud                    |
| 103   | 650814      | 2   | Screw, Torx T-15, 10-24 x 1"                 |
| 110   | 30831       | 1   | Ground Wire                                  |
| 118   | 35515       | 1   | Rope Guard                                   |
| 119   | 36443       | 1   | * Cylinder Head Gasket                       |
| 120   | 36441       | 1   | Cylinder Head (Incl. 131)                    |

| Ref # | Part Number | Qty | Description                          |
|-------|-------------|-----|--------------------------------------|
| 125   | 36471       | 1   | Exhaust Valve (Std.) (Incl. 151)     |
| 125   | 36472       | 1   | Exhaust Valve (1/32" OS) (Incl. 151) |
| 126   | 32644A      | 1   | Intake Valve (Std.) (Incl. 151)      |
| 126   | 32645A      | 1   | Intake Valve (1/32" OS) (Incl. 151)  |
| 127   | 650691      | 1   | Washer                               |
| 129   | 650818      | 1   | Screw, 5/16-18 x 1-1/2"              |
| 130   | 6021A       | 2   | Screw, 5/16-18 x 1-1/2"              |
| 131   | 650694A     | 5   | Screw, 5/16-18 x 2"                  |
| 133   | 650890      | 1   | Lock Washer, 5/16                    |
| 134   | 30747       | 1   | Shorting Clip                        |
| 135   | 33636       | 1   | Resistor Spark Plug (RJ17LM)         |
| 150   | 31672       | 2   | Valve Spring                         |
| 151   | 31673       | 2   | Valve Spring Cap                     |
| 169   | 27234A      | 2   | * Valve Cover Gasket                 |
| 170   | 27666       | 1   | Breather Body                        |
| 171   | 31410       | 1   | Breather Element                     |
| 172   | 34146       | 1   | Valve Cover                          |
| 173   | 35350       | 1   | Breather Tube                        |
| 174   | 30200       | 2   | Screw, 10-24 x 9/16"                 |
| 178   | 29752       | 2   | Nut & Lock Washer, 1/4-28            |
| 181   | 650870      | 1   | Screw, 1/4-28 x 1-11/16"             |
| 182   | 6201        | 1   | Screw, 1/4-28 x 7/8"                 |
| 184   | 26756       | 1   | * Carburetor To Intake Pipe Gasket   |
| 185   | 33666       | 1   | Intake Pipe                          |
| 186   | 32698       | 1   | Governor Link                        |
| 200   | 730136A     | 1   | Control Bracket (Incl. 203 thru 211) |
| 203   | 31342       | 1   | Compression Spring                   |
| 204   | 650549      | 1   | Screw, 5-40 x 7/16"                  |
| 209   | 650139      | 2   | Screw, 8-32 x 1/2"                   |
| 209A  | 30322       | 2   | Lock Nut, 8-32                       |
| 210   | 27793       | 1   | Conduit Clip                         |
| 211   | 28942       | 1   | Screw, 10-32 x 3/8"                  |
| 213   | 28942       | 1   | Screw, 10-32 x 3/8"                  |
| 223A  | 650664      | 1   | Screw, 1/4-20 x 1-19/32"             |
| 223   | 30646       | 1   | Screw, 1/4-20 x 1-3/8"               |
| 224   | 33673A      | 1   | * Intake Pipe Gasket                 |
| 260   | 35657       | 1   | Blower Housing                       |
| 262   | 650737      | 2   | Screw, 1/4-20 x 1/2"                 |
| 267   | 34212       | 1   | Hold Down Bracket                    |
| 268   | 30200       | 1   | Screw, 10-24 x 9/16"                 |
| 274   | 33670A      | 1   | * Exhaust Gasket                     |
| 275   | 35771       | 1   | Muffler (Incl. 274)                  |
| 277   | 650327      | 2   | Screw, 1/4-20 x 2-1/2"               |
| 285   | 36467A      | 1   | Starter Cup                          |
| 287   | 650926      | 2   | Screw, 8-32 x 21/64"                 |
| 290   | 30962       | 1   | Fuel Line                            |
| 292   | 26460       | 2   | Fuel Line Clamp                      |
| 298   | 650665      | 2   | Screw, 1/4-15 x 7/8"                 |
| 300   | 35591       | 1   | Fuel Tank (Incl. 292 & 301)          |
| 301   | 35355       | 1   | Fuel Cap                             |
| 305   | 35554       | 1   | Oil Fill Tube                        |
| 307   | 35499       | 1   | "O"-Ring                             |
| 310   | 35582       | 1   | Dipstick                             |
| 313   | 34080       | 1   | Spacer                               |
| 327   | 35392       | 1   | Starter Plug                         |
| 340   | 35230       | 1   | Fuel Tank Bracket                    |
| 342   | 650751      | 1   | Screw, 1/4-20 x 7/16"                |
| 370A  | 36261       | 1   | Lubrication Decal                    |

| Ref # | Part Number | Qty | Description   |
|-------|-------------|-----|---|
| 380   | 631923      | 1   | Carburetor (Incl. 184)  |
| 390   | 590732      | 1   | Rewind Starter (NOTE: This engine could have been built with 590688 starter. Refer to the design of the air intake louvers for part identification. Individual starter parts do not interchange.) |
| 400   | 36444       | 1   | * Gasket Set (Incl. items marked PK i n notes) Incl. part #'s 26756 (1), 27234A (2), 27272A (1), 27677A (1), 29673 (1), 33670A (1), 33673A (1), 36443 (1)   |
| 420   | 730225      | 1   | SAE 30 4-Cycle Engine Oil (Quart)   |

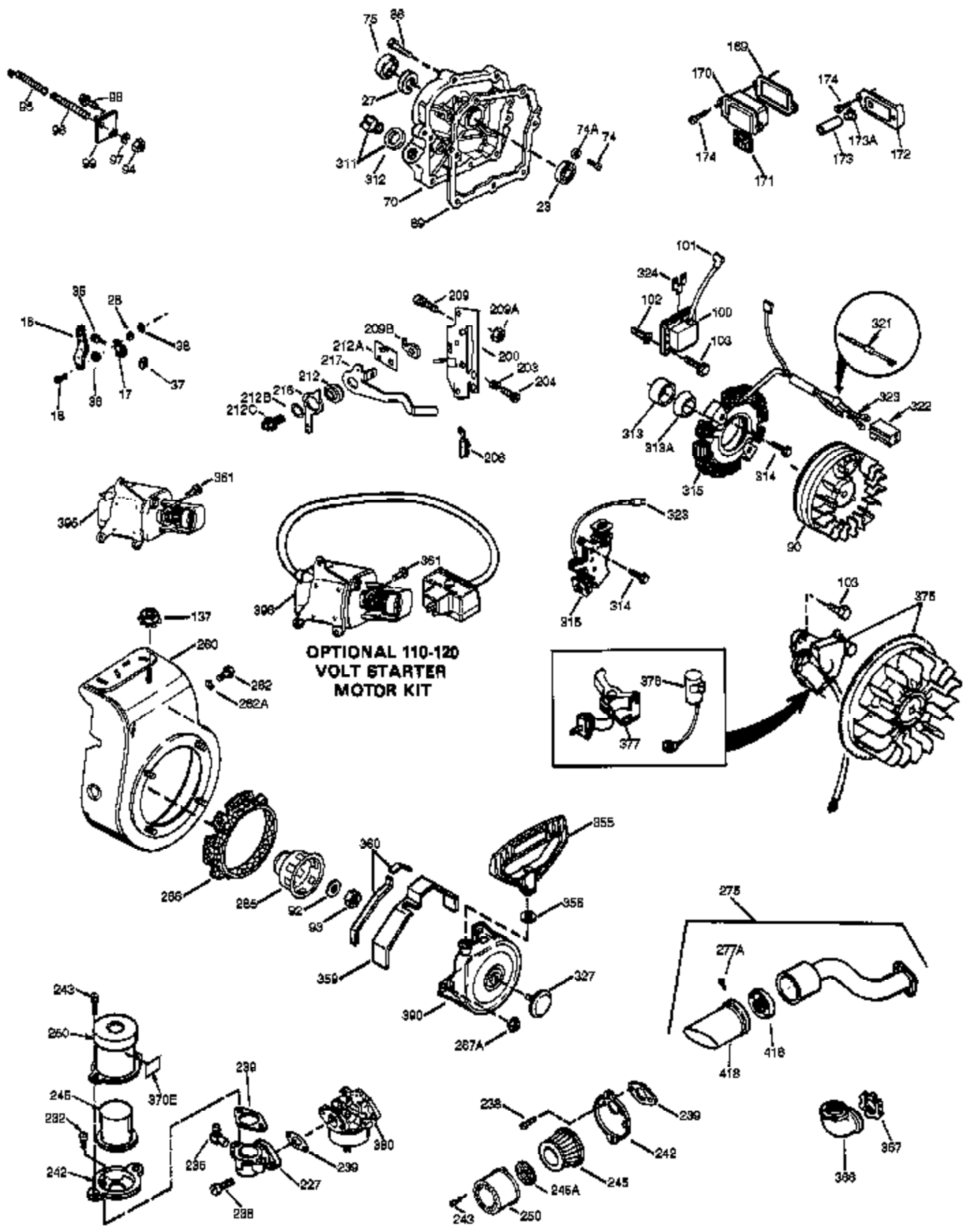

| Ref # | Part Number | Qty | Description   |
|-------|-------------|-----|---|
| 16    | 31510       | 1   | Governor Lever  |
| 17    | 29916       | 1   | Governor Lever Clamp  |
| 18    | 650548      | 1   | Screw, 8-32 x 5/16"   |
| 23    | 28458       | 1   | Ball Bearing  |
| 27    | 28539       | 1   | Bearing Retainer  |
| 28    | 30322       | 1   | Lock Nut  |
| 35    | 29826       | 1   | Screw, 10-32 x 3/4"   |
| 36    | 29918       | 1   | Lock Washer   |
| 37    | 29216       | 1   | Lock Nut  |
| 38    | 29642       | 1   | Retaining Ring  |
| 69    | 27677A      | 1   | * Cylinder Cover Gasket   |
| 70    | 30756C      | 1   | Cylinder Cover (Incl. 72 thru 83, 311 & 312)  |
| 74A   | 28537       | 2   | Washer  |
| 74    | 30200       | 2   | Screw, 10-24 x 9/16"  |
| 75    | 28540       | 1   | Oil Seal  |
| 86    | 650488      | 7   | Screw, 1/4-20 x 1-1/4"  |
| 90    | 611195      | 1   | Flywheel  |
| 92    | 650815      | 1   | Belleville Washer   |
| 93    | 650816      | 1   | Flywheel Nut  |
| 100   | 34443A      | 1   | Solid State Ignition  |
| 101   | 27276       | 1   | Spark Plug Cover  |
| 102   | 650872      | 2   | Solid State Mounting Stud   |
| 103   | 650814      | 2   | Screw, Torx T-15, 10-24 x 1"  |
| 129   | 650818      | 1   | Screw, 5/16-18 x 1-1/2"   |
| 131   | 650694A     | 5   | Screw, 5/16-18 x 2"   |
| 137   | 29752       | 1   | Lock Nut  |
| 169   | 27234A      | 2   | * Valve Cover Gasket  |
| 170   | 27666       | 1   | Breather Body   |
| 171   | 31410       | 1   | Breather Element  |
| 172   | 34146       | 1   | Valve Cover   |
| 173   | 35350       | 1   | Breather Tube   |
| 174   | 30200       | 2   | Screw, 10-24 x 9/16"  |
| 200   | 730136A     | 1   | Control Bracket (Incl. 203 thru 211)  |
| 203   | 31342       | 1   | Compression Spring  |
| 204   | 650549      | 1   | Screw, 5-40 x 7/16"   |
| 209   | 650139      | 2   | Screw, 8-32 x 1/2"  |
| 209A  | 30322       | 2   | Lock Nut, 8-32  |
| 238   | 650152      | 2   | Screw, 8-32 x 3/8"  |
| 239   | 27272A      | 1   | * Air Cleaner Gasket  |
| 242   | 31914       | 1   | Air Cleaner Base  |
| 243   | 28820       | 2   | Screw, 10-32 x 1/2"   |
| 245   | 30727       | 1   | Air Cleaner Filter  |
| 250   | 31715       | 1   | Air Cleaner Cover   |
| 262   | 650737      | 2   | Screw, 1/4-20 x 1/2"  |
| 275   | 35771       | 1   | Muffler (Incl. 274)   |
| 285   | 36467A      | 1   | Starter Cup   |
| 290   | 30962       | 1   | Fuel Line   |
| 298   | 650665      | 2   | Screw, 1/4-15 x 7/8"  |
| 311   | 27625       | 1   | Oil Fill Plug (Incl. 312)   |
| 312   | 29673       | 1   | * Oil Fill Plug Gasket  |
| 313   | 34080       | 1   | Spacer  |
| 327   | 35392       | 1   | Starter Plug  |
| 380   | 631923      | 1   | Carburetor (Incl. 184)  |
| 390   | 590732      | 1   | Rewind Starter (NOTE: This engine could have been built with 590688 starter. Refer to the design of the air intake louvers for part identification. Individual starter parts do not interchange.) |