

| Ref # | Part Number | Qty | Description |
|-------|-------------|-----|--|
| 1 | 33389 | 0 | Cylinder Assy. (2-5/16" Bore) |
| 2 | 26727 | 0 | Pin, Dowel |
| 3A | 30979 | 0 | Bushing, Crankshaft |
| 3 | 30981 | 0 | Bushing, Crankshaft |
| 4 | 29183 | 0 | Seal, Oil |
| 5 | 29314A | 0 | Valve, Intake (Standard) |
| 5 | 29315B | 0 | Valve, Intake (1/32" oversize) |
| 6 | 29313B | 0 | Valve, Exhaust (Standard) |
| 6 | 29315B | 0 | Valve, Intake (1/32" oversize) |
| 8 | 31671 | 0 | Cap, Upper valve spring |
| 9 | 31672 | 0 | Spring, Valve |
| 10 | 31673 | 0 | Cap, Lower valve spring |
| 11 | 29385A | 0 | Crankshaft Assy. |
| 11 | 31534 | 0 | Crankshaft Assy. Spec. No. 40475H |
| 12 | 29783 | 0 | Pin, Crankshaft gear |
| 13 | 27613 | 0 | Gear, Crankshaft |
| 14 | 31761 | 0 | Piston & Pin Assy. (Standard) (2-5/16") |
| 14 | 32662 | 0 | Piston & Pin Assy. (.010 oversize) |
| 14 | 32663 | 0 | Piston & Pin Assy. (.020 oversize) |
| 15 | 27565 | 0 | Ring Set, Piston (Standard) (2-5/16") |
| 15 | 27566 | 0 | Ring Set, Piston (.010 oversize) |
| 15 | 27567 | 0 | Ring Set, Piston (.020 oversize) |
| 15 | 29903 | 0 | Re-Ringing Set, Piston |
| 16 | 20381 | 0 | Ring, Piston pin retaining |
| 17 | 30963B | 0 | Rod Assy., Connecting |
| 18 | 26706 | 0 | Bolt, Connecting rod |
| 19 | 20747 | 0 | Washer, Connecting rod bolt |
| 20 | 27573 | 0 | Nut, Connecting rod bolt |
| 21 | 27241 | 0 | Lifter, Valve |
| 22 | 31316 | 0 | Camshaft |
| 23 | 29914 | 0 | Pump Assy., Oil |
| 24 | 26750A | 0 | Gasket, Mounting flange |
| 25 | 30784B | 0 | Flange Assy., Mounting |
| 26 | 26208 | 0 | Seal, Oil |
| 26A | 30318 | 0 | Seal, Oil (Camshaft) |
| 27 | 28833 | 0 | Gasket, Oil drain |
| 28 | 30572 | 0 | Plug, Drain (Hex hd. 3/8-18) |
| 29 | 15832 | 0 | Screw, Rd. slotted hd., 1/4-20 x 3/8 |
| 29 | 650488 | 0 | Screw |
| 29 | 650599 | 0 | Screw, Hex hd. cap, Sems, 1/4-20 x 1-1/2 |
| 30 | 29673 | 0 | Gasket, Filler plug |
| 31 | 27625 | 0 | Plug, Oil filler |
| 32 | 30574 | 0 | Shaft, Mechanical governor |
| 33A | 30590A | 0 | Washer, Flat |
| 33 | 30591 | 0 | Gear Assy., Governor |
| 34 | 29193 | 0 | Ring, Retaining |
| 35 | 30588A | 0 | Spool, Governor |
| 36 | 31335 | 0 | Clamp, Governor lever |
| 37A | 650548 | 0 | Screw, Hex washer hd., 8-32 x 5/16 |
| 37 | 28277 | 0 | Washer, Flat |
| 38 | 30589 | 0 | Rod, Governor |
| 39 | 31383 | 0 | Lever, Governor |
| 40 | 26460 | 0 | Clamp, Fuel line |
| 42 | 610949 | 0 | Key, Flywheel |
| 45 | 650489 | 0 | Screw |
| 46 | 29953B | 0 | Gasket, Cylinder head |
| 47 | 30579 | 0 | Head, Cylinder |
| 48 | 26073 | 0 | Washer, Connecting rod bolt |

| Ref # | Part Number | Qty | Description |
|-------|-------------|-----|--|
| 49 | 6201 | 0 | Screw |
| 49 | 650628A | 0 | Screw, Hex hd. cap, 5/16-18 x 2-3/8 |
| 49 | 650694 | 0 | Screw, Hex hd. cap, 5/16-18 x 2 |
| 49 | 650697 | 0 | Screw, Hex hd. cap, 5/16-18 x 2-1/2 |
| 51 | 33636 | 0 | Plug, Spark (Champion J-8 or equivalent) |
| 51 | 34251 | 0 | Resistor Spark Plug |
| 52 | 31619 | 0 | Gasket, Breather cover |
| 53 | 31337 | 0 | Breather Assy. |
| 54A | 31410 | 0 | Element, Breather |
| 57 | 650128 | 0 | Screw |
| 57A | 650128 | 0 | Screw |
| 59 | 30188 | 0 | Gasket, Intake pipe |
| 60 | 31384 | 0 | Pipe, Intake |
| 62 | 650451 | 0 | Screw |
| 64A | 27275 | 0 | Clip, Hi-tension wire |
| 64 | 30593 | 0 | Clip, Magneto wire |
| 66 | 31386 | 0 | Spring, Governor |
| 66 | 33578 | 0 | Spring Governor Spec. No. 40933K |
| 68A | 31342 | 0 | Spring, Compression |
| 68 | 33802 | 0 | Spring Compression |
| 69A | 650777 | 0 | Screw, Slotted fil. hd. mach., 6-32 x 7/16 |
| 69 | 650549 | 0 | Screw |
| 70A | 32652 | 0 | Link, Throttle |
| 70 | 32653 | 0 | Link, Governor spring |
| 71 | 28942 | 0 | Screw |
| 72 | 27793 | 0 | Clip, Conduit |
| 73 | 27181A | 0 | Muffler |
| 74A | 26754 | 0 | Gasket, Exhaust |
| 75 | 27182 | 0 | Screw, Hex hd. cap, 1/4-20 x 3-3/8 |
| 75 | 30298 | 0 | Screw, Hex hd. cap, 1/4-20 x 2-1/2 |
| 75 | 650234 | 0 | Screw, Hex hd. cap, 1/4-20 x 3 |
| 75 | 650243 | 0 | Screw, Hex hd. cap, 1/4-20 x 2-3/4 |
| 75 | 650253 | 0 | Screw, Hex hd. cap, 1/4-20 x 2-1/4 |
| 75 | 650493 | 0 | Screw, Hex hd. Sems, 1/4-20 x 1-3/4 |
| 75 | 650795 | 0 | Screw, Hex hd. cap, Sems, 1/4-20 x 2-5/16 |
| 80 | 31388 | 0 | Wire, Ground (Female fitting both ends) |
| 83 | 26756 | 0 | Gasket, Carburetor |
| 83 | 31688 | 0 | Gasket, Carburetor (1/8 thick) |
| 85 | 30564 | 0 | Screw |
| 85 | 6201 | 0 | Screw |
| 85 | 6202 | 0 | Screw |
| 87 | 29752 | 0 | Nut |
| 88 | 27272 | 0 | Gasket, Air cleaner |
| 95 | 30200 | 0 | Screw |
| 96 | 32181A | 0 | Control Assy., Speed |
| 98 | 32455B | 0 | Housing, Blower |
| 99 | 14981 | 0 | Screw, Fil. slotted hd., 1/4-28 x 5/8 |
| 99 | 29213 | 0 | Screw, Phil. oval hd. w/lockwasher, 1/4-28 x |
| 99 | 29716 | 0 | Screw |
| 99 | 30171 | 0 | Screw, Phil. oval hd. Sems, 1/4-28 x 2-3/8 |
| 99 | 30513 | 0 | Screw |
| 99 | 30688 | 0 | Screw, Hex hd. Sems, 1/4-20 x 1/2 |
| 99 | 650737 | 0 | Screw, Hex washer hd. taptite, 1/4-20 x 1/2 |
| 99A | 650561 | 0 | Screw |
| 100 | 31403 | 0 | Clip, Fuel line |
| 101 | 32170A | 0 | Tank Assy., Fuel (White Poly) (1 qt.) |
| 102 | 30998B | 0 | Cap, Fuel filler (Red Plastic) (Sno Proof) |
| 102 | 32387A | 0 | Cap, Fuel filler (Charcoal Plastic) (Spurt |

| Ref # | Part Number | Qty | Description |
|-------|-------------|-----|---|
| 102 | 410144B | 0 | Cap, Fuel filler (White Plastic) (Std.) |
| 102 | 410224 | 0 | Cap, Fuel filler (Metal w/chain) |
| 105A | 28684 | 0 | Line, Fuel (Braided hose) (14-5/8") |
| 105A | 29774 | 0 | Line, Fuel (Braided 8.25") |
| 105A | 30705 | 0 | Line, Fuel (Braided 16") |
| 105A | 30962 | 0 | Line, Fuel (Braided 32") |
| 105 | 30235 | 0 | Line, Fuel (7-3/8" Metal) |
| 105 | 31400 | 0 | Line, Fuel (3-3/8" Metal) |
| 106 | 650490 | 0 | Washer, Belleville |
| 107 | 650491 | 0 | Nut, Flywheel |
| 112 | 9556 | 0 | Plug, Oil drain (Sq. hd. pipe, 1/8-27) |
| 116 | 30747 | 0 | Clip, Shorting |
| 117 | 16645 | 0 | Lockwasher |
| 132 | 30688 | 0 | Screw, Hex hd. Sems, 1/4-20 x 1/2 |
| 163 | 28763 | 0 | Screw, Hex washer hd. thread-forming, 10-24 |
| 165 | 26091 | 0 | Cap, Oil seal protector |
| 173 | 29375 | 0 | Extension, Oil drain |
| 181B | 650639 | 0 | Rivet, Open end |
| 206 | 29985 | 0 | "O" Ring |
| 207 | 650147 | 0 | Washer, Flat |
| 208 | 650562 | 0 | Screw |
| 210 | 30139 | 0 | "O" Ring |
| 210 | 34282 | 0 | "O" Ring (.612 I.D. x .812 O.D. x .103 |
| 249 | 31398 | 0 | Decal, Name & Instructions |
| 249C | 31495 | 0 | Decal, Speed control |
| 249E | 30033 | 0 | Decal, Starter |
| 249E | 30595 | 0 | Decal, Ezee-start |
| 249E | 31516 | 0 | Decal, Starter |
| 249E | 32187 | 0 | Decal, Super-start |
| 249G | 31268 | 0 | Decal, Choke |
| 249A | 28250 | 0 | Decal, H.P. (3 H.P.) |
| 249A | 30077 | 0 | Decal, H.P. (3-1/2 H.P.) |
| 249A | 30597 | 0 | Decal, Name & H.P. (3 H.P.) |
| 249A | 30612 | 0 | Decal, Name & H.P. (3-1/2 H.P.) |
| 250 | 30547A | 0 | Contact Assy., Breaker |
| 251 | 30548A | 0 | Condenser |
| 256 | 610690A | 0 | Magneto, Tecumseh |
| 260 | 33236 | 0 | Gasket Set |

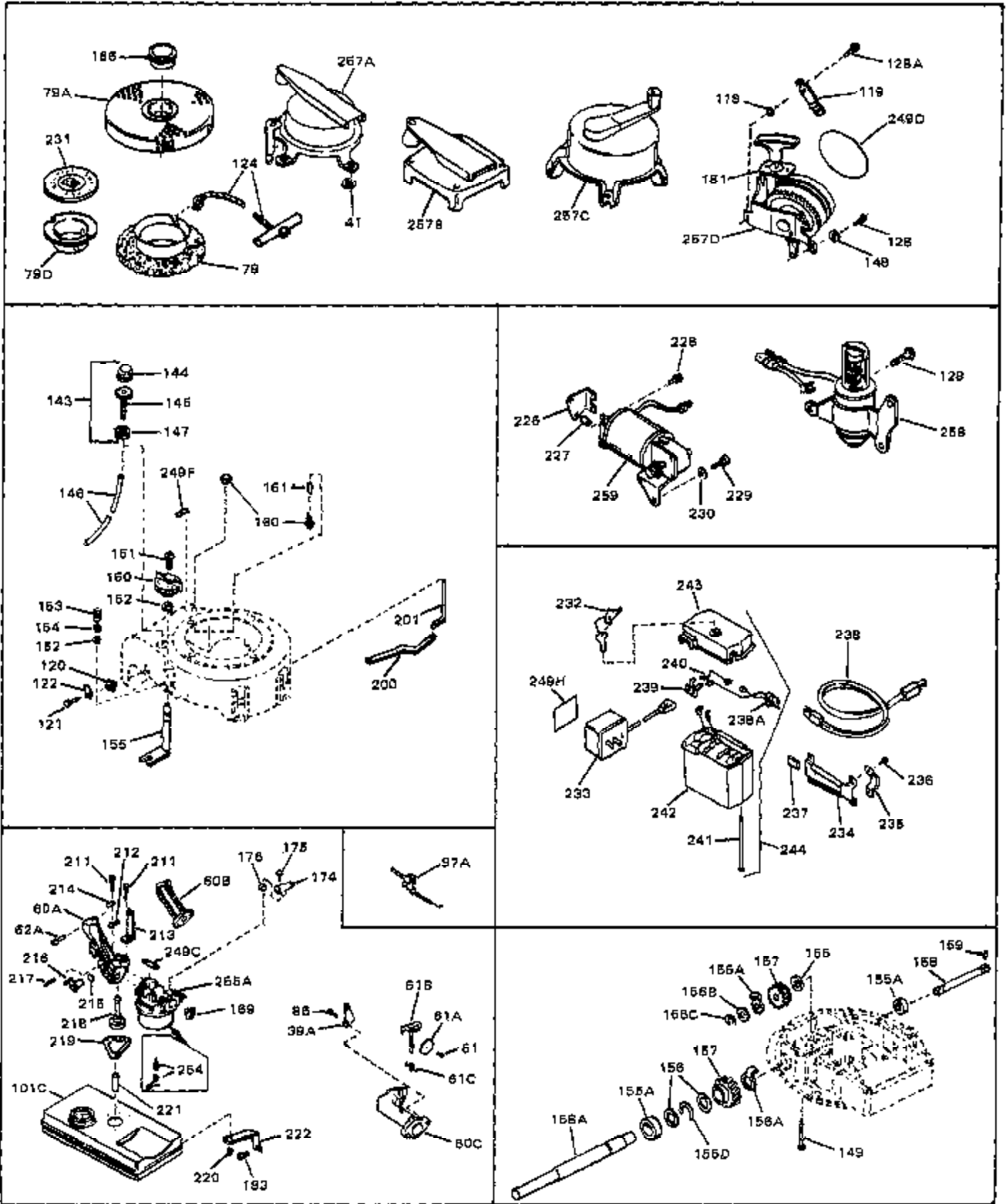

| Ref # | Part Number | Qty | Description |
|-------|-------------|-----|--|
| 41 | 27070 | 0 | Lockwasher |
| 41 | 27656 | 0 | Washer, Flat |
| 41 | 650168 | 0 | Washer, Flat |
| 79 | 30892 | 0 | Pulley, Rope starter |
| 79 | 31284 | 0 | Hub & Screen Assy. |
| 85 | 30564 | 0 | Screw |
| 85 | 6201 | 0 | Screw |
| 85 | 6202 | 0 | Screw |
| 97A | 24522 | 0 | Control, Throttle |
| 124 | 590343 | 0 | Rope & Handle Assy., Starter |
| 128 | 650737 | 0 | Screw, Hex washer hd. taptite, 1/4-20 x 1/2 |
| 148 | 8345 | 0 | Washer, 1/4 |
| 149 | 650492 | 0 | Screw |
| 166 | 32119 | 0 | Plug, Screen |
| 166 | 32236 | 0 | Plug, Screen |
| 181 | 590441 | 0 | Rope Guide Assy. |
| 181 | 590516 | 0 | Bracket Assy. |
| 183 | 29511 | 0 | Screw, Slotted hex washer hd., 1/4-20 x 7/16 |
| 249C | 31495 | 0 | Decal, Speed control |
| 254 | 631021 | 0 | Inlet Needle, Seat & Clip Assy. |
| 255A | 631242 | 0 | Carburetor |
| 257A | 590378 | 0 | Starter, "Impulse" |

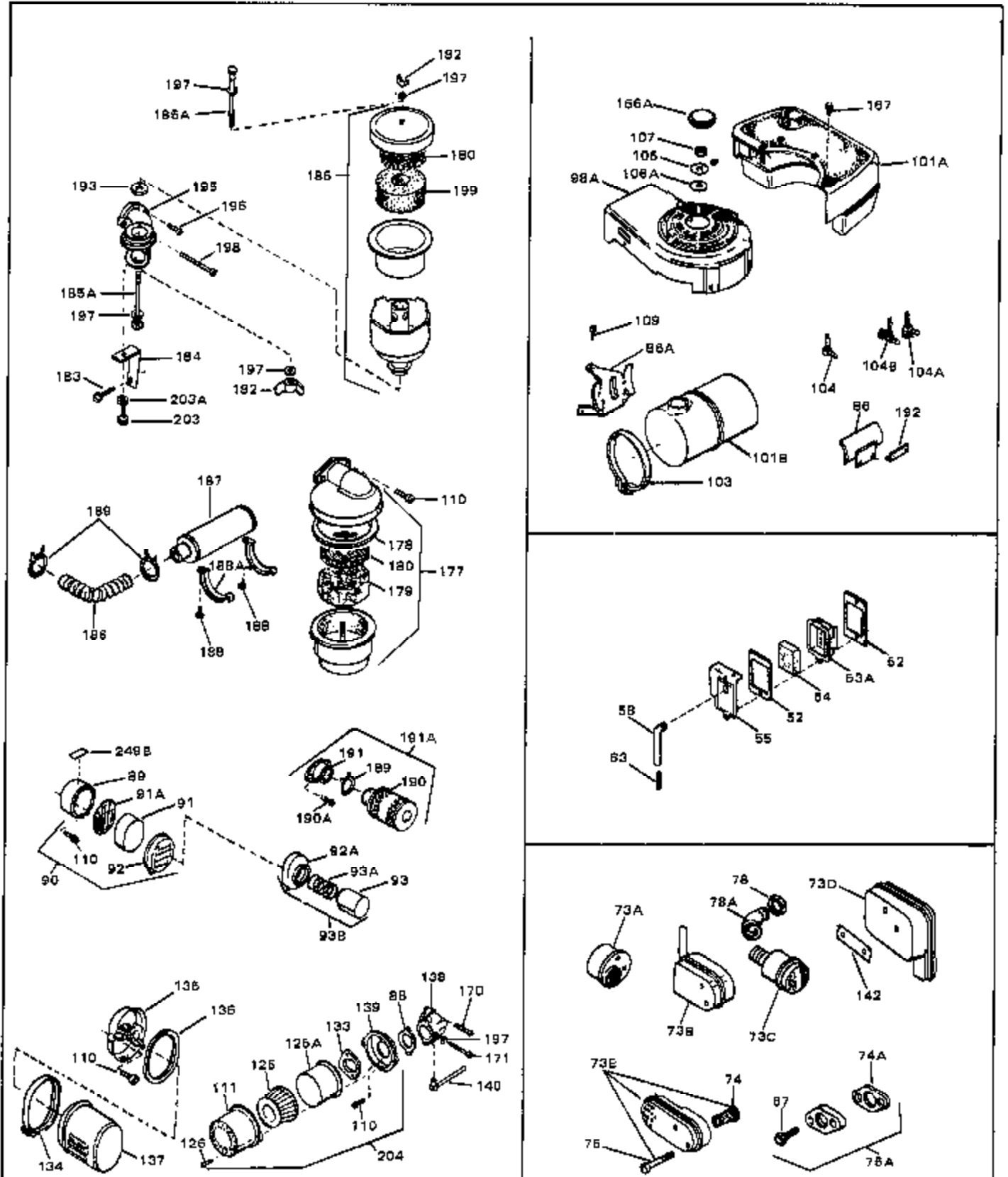

| Ref # | Part Number | Qty | Description |
|-------|-------------|-----|--|
| 52 | 31619 | 0 | Gasket, Breather cover |
| 63 | 31778 | 0 | Spring, Coil |
| 67 | 30063 | 0 | Screw |
| 74A | 26754 | 0 | Gasket, Exhaust |
| 75A | 730162 | 0 | Kit, Muffler Adapter |
| 75 | 27182 | 0 | Screw, Hex hd. cap, 1/4-20 x 3-3/8 |
| 75 | 30298 | 0 | Screw, Hex hd. cap, 1/4-20 x 2-1/2 |
| 75 | 650234 | 0 | Screw, Hex hd. cap, 1/4-20 x 3 |
| 75 | 650243 | 0 | Screw, Hex hd. cap, 1/4-20 x 2-3/4 |
| 75 | 650253 | 0 | Screw, Hex hd. cap, 1/4-20 x 2-1/4 |
| 75 | 650493 | 0 | Screw, Hex hd. Sems, 1/4-20 x 1-3/4 |
| 75 | 650795 | 0 | Screw, Hex hd. cap, Sems, 1/4-20 x 2-5/16 |
| 78 | 27675 | 0 | Nut, Conduit |
| 78A | 28885 | 0 | Elbow, Exhaust (90°) |
| 78A | 30617 | 0 | Elbow, Exhaust (45°) |
| 88 | 27272 | 0 | Gasket, Air cleaner |
| 91A | 29962 | 0 | Screen, Air cleaner |
| 93B | 730510 | 0 | Kit, Pre-cleaner |
| 93A | 450150 | 0 | Spring, Pre-cleaner |
| 93 | 450124 | 0 | Bag, Pre-cleaner |
| 104B | 30863 | 0 | Valve, Fuel shut-off |
| 104 | 28584 | 0 | Strainer & Elbow |
| 104A | 29683 | 0 | Strainer & Shut-off |
| 106 | 650490 | 0 | Washer, Belleville |
| 107 | 650491 | 0 | Nut, Flywheel |
| 109 | 650561 | 0 | Screw |
| 110 | 28820 | 0 | Screw |
| 110 | 29786 | 0 | Screw |
| 110 | 650399 | 0 | Screw, Phil. fil. hd. Sems, 10-32 x 5/8 |
| 126 | 650152 | 0 | Screw |
| 133 | 30767 | 0 | Spacer, Air cleaner |
| 140 | 30635 | 0 | Fitting, Breather |
| 170 | 650163 | 0 | Screw, Fil. hd. Sems, 10-32 x 7/8 |
| 171 | 650520 | 0 | Screw |
| 180 | 30731 | 0 | Screen, Oil bath air cleaner |
| 182 | 9577 | 0 | Nut, Wing, 10-24 |
| 183 | 29511 | 0 | Screw, Slotted hex washer hd., 1/4-20 x 7/16 |
| 184 | 30418 | 0 | Bracket, Cleaner elbow |
| 185A | 650622 | 0 | Bolt, Air cleaner |
| 185 | 31404 | 0 | Cleaner Assy., Oil bath |
| 191A | 730145 | 0 | Air Cleaner Kit |
| 192 | 29432 | 0 | Bracket, Housing |
| 193 | 27165 | 0 | Gasket, Elbow |
| 195 | 31473 | 0 | Elbow, Air cleaner |
| 196 | 650163 | 0 | Screw, Fil. hd. Sems, 10-32 x 7/8 |
| 197 | 27183 | 0 | Washer, Fiber |
| 197 | 31905 | 0 | Washer, Paper |
| 198 | 650519 | 0 | Screw |
| 198 | 650520 | 0 | Screw |
| 199 | 31408 | 0 | Element, Air cleaner |
| 203 | 30688 | 0 | Screw, Hex hd. Sems, 1/4-20 x 1/2 |
| 203A | 650722 | 0 | Lockwasher, 1/4 |
| 204 | 730127 | 0 | Cleaner Assy., Air (Poly) |
| 249B | 30002 | 0 | Decal, Air cleaner |