

| Ref # | Part Number | Qty | Description |
|-------|-------------|-----|---|
| 1 | 35677A | 1 | Cylinder (Incl. 2, 20, 72 & 80) |
| 2 | 27652 | 2 | Dowel Pin |
| 14A | 28558 | 1 | Washer |
| 14 | 28277 | 1 | Washer |
| 15 | 35685 | 1 | Governor Rod (Incl. 14 & 38) |
| 16 | 35686 | 1 | Governor Lever |
| 17 | 29916 | 1 | Governor Lever Clamp |
| 18 | 650548 | 1 | Screw, 8-32 x 5/16" |
| 19 | 35785 | 1 | Extension Spring |
| 20 | 35319 | 1 | Oil Seal |
| 25 | 37861 | 1 | Blower Housing Baffle |
| 26 | 650561 | 2 | Screw, 1/4-20 x 5/8" |
| 28 | 30322 | 1 | Lock Nut, 8-32 |
| 30 | 35784A | 1 | Crankshaft |
| 31 | 35327 | 1 | Counterbalance Gear |
| 35 | 29826 | 1 | Screw, 10-32 x 3/4" |
| 36 | 29918 | 1 | Lock Washer |
| 37 | 29216 | 1 | Lock Nut, 10-32 |
| 38 | 29642 | 3 | Retaining Ring |
| 40 | 35776 | 1 | Piston, Pin & Ring Set (Std.) |
| 40 | 35777 | 1 | Piston, Pin & Ring Set (.010" OS) |
| 40 | 35778 | 1 | Piston, Pin & Ring Set (.020" OS) |
| 41 | 35773 | 1 | Piston & Pin Ass'y. (Std.) (Incl. 43) |
| 41 | 35774 | 1 | Piston & Pin Ass'y. (.010" OS) (Incl. 43) |
| 41 | 35775 | 1 | Piston & Pin Ass'y. (.020" OS) (Incl. 43) |
| 42 | 35779 | 1 | Ring Set (Std.) |
| 42 | 35780 | 1 | Ring Set (.010" OS) |
| 42 | 35781 | 1 | Ring Set (.020" OS) |
| 43 | 35772 | 2 | Piston Pin Retaining Ring |
| 45 | 35681 | 1 | Connecting Rod Ass'y. (Incl. 46 & 47) |
| 46 | 650908 | 1 | Connecting Rod Bolt |
| 47 | 650882 | 1 | Connecting Rod Bolt |
| 48 | 35313 | 2 | Valve Lifter |
| 50 | 35682A | 1 | Camshaft (MCR) |
| 51 | 35315A | 1 | Counterbalance Weight |
| 60 | 35316A | 1 | Blower Housing Extension |
| 62 | 650760 | 1 | Screw, 8-32 x 3/8" |
| 63 | 28545 | 1 | Grommet |
| 65 | 650128 | 1 | Screw, 10-24 x 1/2" |
| 66 | 30063 | 1 | Screw, Torx T-30, 1/4-20 x 1/2" |
| 69 | 35683 | 1 | * Cylinder Cover Gasket |
| 70 | 35684A | 1 | Cylinder Cover (Incl. 14,15,38,71,75) |
| 71 | 35377 | 1 | Crankshaft Bushing |
| 72 | 27642 | 2 | Oil Drain Plug |
| 75 | 35319 | 1 | Oil Seal |
| 80 | 35751 | 1 | Governor Shaft |
| 81 | 35479 | 2 | Washer |
| 82 | 35321 | 1 | Governor Gear Ass'y. |
| 83 | 35322 | 1 | Governor Spool |
| 84 | 29193 | 1 | Retaining Ring |
| 86 | 650833 | 7 | Screw, 1/4-20 x 1-3/16" |
| 87 | 650832 | 1 | Screw, 1/4-20 x 1-11/16" |
| 89 | 32589 | 1 | Flywheel Key |
| 90 | 611094 | 1 | Flywheel (W/Ring Gear) |
| 92 | 650880 | 1 | Lock Washer |
| 93 | 650881 | 1 | Flywheel Nut |
| 100 | 35135 | 1 | Solid State Ignition |
| 101 | 610118 | 1 | Spark Plug Cover |

| Ref # | Part Number | Qty | Description |
|-------|-------------|-----|---|
| 102 | 650872 | 2 | Solid State Mounting Stud |
| 103 | 650814 | 2 | Screw, Torx T-15, 10-24 x 1" |
| 119 | 35854 | 1 | * Cylinder Head Gasket |
| 120 | 35307 | 1 | Cylinder Head |
| 121 | 730218 | 2 | Valve Guide Kit (Incl. 2 of 122) |
| 122 | 792035 | 2 | Retaining Ring |
| 125 | 35308 | 1 | Exhaust Valve (Std.) |
| 125 | 35433 | 1 | Exhaust Valve (1/32" OS) |
| 126 | 35309 | 1 | Intake Valve (Std.) |
| 126 | 35432 | 1 | Intake Valve (1/32" OS) |
| 127 | 650691 | 6 | Washer |
| 128 | 650690 | 6 | Belleville Washer |
| 129 | 650746 | 2 | Screw, 5/16-18 x 1-3/8" |
| 130 | 650692 | 4 | Screw, 5/16-18 x 1-3/4" |
| 135 | 34046 | 1 | Resistor Spark Plug (RL86C) |
| 141 | 33481 | 4 | * "O" Ring (Also Incl. in 401) |
| 142 | 35475 | 2 | Push Rod Tube |
| 143 | 35310 | 1 | Rocker Arm Housing |
| 144 | 33484 | 1 | * "O" Ring (Also Incl. in 401) |
| 145 | 650168 | 1 | Washer |
| 146 | 32610A | 1 | Screw, 1/4-20 x 29/32" |
| 147 | 33509 | 1 | * "O" Ring (Also Incl. in 401) |
| 148 | 34410 | 1 | * "O" Ring (Also Incl. in 401) |
| 149 | 33510 | 2 | Valve Spring Cap |
| 150 | 33507 | 2 | Valve Spring |
| 151 | 33508 | 2 | Valve Spring Keeper |
| 152 | 35295 | 2 | * "O" Ring (Also Incl. in 401) |
| 153 | 35296 | 1 | Push Rod Guide |
| 154 | 650878 | 2 | Rocker Arm Stud |
| 155 | 35297 | 2 | Rocker Arm |
| 156 | 35298 | 2 | Rocker Arm Bearing |
| 157 | 28264 | 2 | * Lock Nut (Incl. 162) (Also Incl. in 4 01) |
| 158 | 35466 | 2 | Push Rod |
| 159 | 35299B | 1 | * "O" Ring (Incl. 2 of 161) (Also Incl. in 401) |
| 160 | 35300 | 1 | Rocker Arm Housing |
| 161 | 650879 | 2 | Screw, Torx T-20, 8-32 x 1/2" |
| 162 | 650903 | 2 | Jam Nut |
| 169 | 27896A | 2 | * Breather Gasket |
| 170 | 28423 | 1 | Breather Body |
| 171 | 28424 | 1 | Breather Element |
| 172 | 28425 | 1 | Valve Cover |
| 173 | 35350 | 1 | Breather Tube |
| 174 | 650128 | 2 | Screw, 10-24 x 1/2" |
| 180 | 35301 | 1 | Blower Housing Extension |
| 181 | 650128 | 1 | Screw, 10-24 x 1/2" |
| 182 | 650517 | 2 | Screw, 1/4-20 x 27/32" |
| 184 | 33263 | 1 | * Carburetor To Intake Pipe Gasket |
| 185 | 35690 | 1 | Intake Pipe |
| 186 | 35691 | 1 | Governor Link |
| 200 | 35786 | 1 | Control Bracket (Incl.203,204,210 & 2 11) |
| 202 | 36482 | 1 | Compression Spring |
| 203 | 31342 | 1 | Compression Spring |
| 204 | 650549 | 1 | Screw, 5-40 x 7/16" |
| 205 | 650777 | 1 | Screw, 6-32 x 21/32" |
| 207 | 35692 | 1 | Throttle Link |
| 209 | 650821 | 2 | Screw, 10-32 x 1/2" |
| 210 | 27793 | 1 | Conduit Clip |
| 211 | 28942 | 1 | Screw, 10-32 x 3/8" |

| Ref # | Part Number | Qty | Description |
|-------|-------------|-----|--|
| 212 | 30773A | 1 | Bushing |
| 213 | 650930 | 1 | Screw, 10-32 x 5/8" |
| 216 | 35679 | 1 | R.P.M. Adjusting Lever |
| 223 | 650971 | 2 | Screw, Torx T-30, 5/16-18 x 7/8" |
| 224 | 33515A | 1 | * Intake Pipe Gasket |
| 260 | 35716 | 1 | Blower Housing |
| 262 | 29747B | 2 | Screw, Torx T-40, 5/16-24 x 21/32" |
| 264A | 650805 | 1 | Screw, 1/4-20 x 11/16" |
| 265 | 35290 | 1 | Cylinder Head Cover |
| 266 | 650876 | 2 | Screw, 5/16-18 x 1-1/4" |
| 269 | 35762 | 1 | * Exhaust Manifold Gasket |
| 270A | 35829A | 1 | Exhaust Port Liner |
| 270 | 35788 | 1 | Exhaust Manifold |
| 271 | 35293 | 1 | Locking Plate |
| 275 | 35789 | 1 | Muffler |
| 276 | 35348 | 1 | Locking Plate |
| 277 | 650877 | 2 | Screw, 5/16-18 x 4-1/2" |
| 287 | 29752 | 4 | Nut & Lock Washer, 1/4-28 |
| 290 | 30705 | 1 | Fuel Line (10.50") |
| 291 | 30962 | 1 | Fuel Line (19.00") |
| 291A | 29774 | 1 | Fuel Line |
| 292 | 26460 | 4 | Fuel Line Clamp |
| 295 | 35857 | 1 | Fuel Shut-Off Valve |
| 296 | 34279B | 1 | Fuel Filter (Incl. 292) |
| 303 | 28566 | 1 | Fuel Line Fitting |
| 305 | 35574 | 1 | Oil Fill Tube |
| 307 | 35499 | 1 | "O" Ring |
| 308 | 35539 | 1 | Fill Tube Clip |
| 310 | 35700 | 1 | Dipstick |
| 314 | 650873 | 2 | Screw, 1/4-20 x 3/4" |
| 321 | 611161 | 1 | Diode |
| 325 | 34246 | 1 | Wire Clip |
| 327 | 34113 | 1 | Starter Plug |
| 342 | 650273 | 2 | Screw, 5/16-18 x 5/8" |
| 361 | 650990 | 4 | Screw, 5/16-18 x 15/32" |
| 370 | 34686 | 1 | Logo Decal |
| 370A | 36261 | 1 | Instruction Decal |
| 380 | 632555 | 1 | Carburetor (Incl. 184) |
| 395 | 35763A | 1 | Electric Starter Motor (12 Volt) |
| 400 | 35331B | 1 | * Gasket Set (Incl. items marked PK in notes) Incl. part #'s 27272A (1), 27896A (2), 28264 (2), 33263 (1), 33481 (4), 33484 (1), 33509 (1), 33515A(1), 33629 (2), 34410 (1), 34912 (1), 35295 (2), 35299B (1), 35306A (1), 35317 (1), 35683 (1), 35762 (2) |
| 401 | 35332 | 1 | "O" Ring Kit (Also incl. in 400) 28264 (2), 33481 (4), 33484 (1), 33509 (1), 34410 (1), 35295 (2), 35299B (1) |
| 420 | 730225 | 1 | SAE 30 4-Cycle Engine Oil (Quart) |

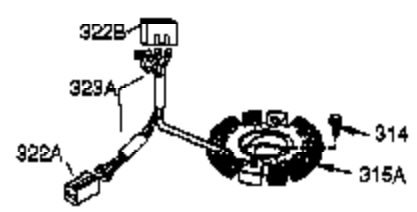
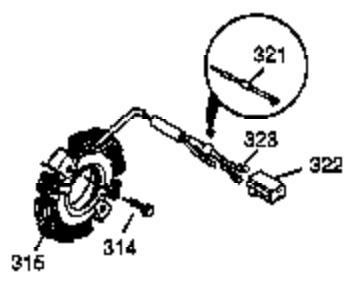
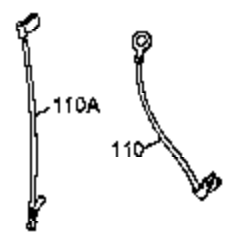
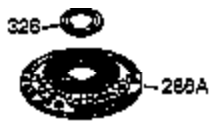
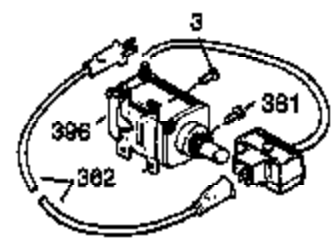
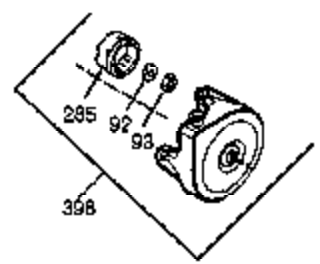
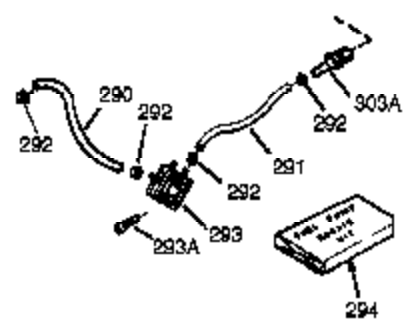
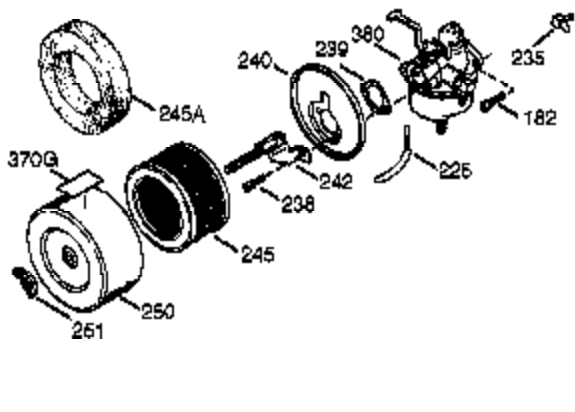

| Ref # | Part Number | Qty | Description |
|-------|-------------|-----|--|
| 62 | 650760 | 1 | Screw, 8-32 x 3/8" |
| 63 | 28545 | 1 | Grommet |
| 68 | 33356 | 1 | Ground Terminal |
| 92 | 650880 | 1 | Lock Washer |
| 93 | 650881 | 1 | Flywheel Nut |
| 110 | 35234 | 1 | Ground Wire |
| 129 | 650746 | 2 | Screw, 5/16-18 x 1-3/8" |
| 182 | 650517 | 2 | Screw, 1/4-20 x 27/32" |
| 225 | 35043 | 1 | Carburetor Tube |
| 238 | 28820 | 2 | Screw, 10-32 x 1/2" |
| 239 | 27272A | 1 | Air Cleaner Gasket |
| 240 | 32380 | 1 | Air Cleaner Body |
| 242 | 32377 | 1 | Air Cleaner Bracket |
| 245 | 31925 | 1 | Air Cleaner Filter |
| 250 | 31926 | 1 | Air Cleaner Cover |
| 251 | 650513 | 1 | Wing Nut, 1/4-20" |
| 286 | 35790 | 1 | Starter Screen |
| 290 | 30705 | 1 | Fuel Line (10.50") |
| 291 | 30962 | 1 | Fuel Line (19.00") |
| 292 | 26460 | 4 | Fuel Line Clamp |
| 293 | 35787 | 1 | Pulse Pump |
| 293A | 650931 | 2 | Screw, 8-32 x 1-1/2" |
| 294 | 35791 | 1 | Pulse Pump Repair Kit |
| 303 | 28566 | 1 | Fuel Line Fitting |
| 314 | 650873 | 2 | Screw, 1/4-20 x 3/4" |
| 315 | 611104 | 1 | Alternator Coil (3/5 Split)(Incl.321, 322&323) |
| 321 | 611161 | 1 | Diode |
| 322 | 611142 | 1 | Connector Body |
| 323 | 611118 | 1 | Terminal |
| 361 | 650990 | 4 | Screw, 5/16-18 x 15/32" |
| 370G | 35274 | 1 | Instruction Decal |
| 380 | 632555 | 1 | Carburetor (Incl. 184) |