

| Ref # | Part Number | Qty | Description |
|-------|-------------|-----|---|
| 1 | 35677A | 1 | Cylinder (Incl. 2, 20, 72 & 80) |
| 2 | 27652 | 2 | Dowel Pin |
| 14A | 28558 | 1 | Washer |
| 14 | 28277 | 1 | Washer |
| 15 | 35685 | 1 | Governor Rod (Incl. 14 & 38) |
| 16 | 35686 | 1 | Governor Lever |
| 17 | 35687 | 1 | Governor Lever Clamp |
| 18 | 650548 | 1 | Screw, 8-32 x 5/16" |
| 19 | 35785 | 1 | Extension Spring |
| 20 | 35319 | 1 | Oil Seal |
| 25 | 36460 | 1 | Blower Housing Baffle |
| 26 | 650561 | 2 | Screw, 1/4-20 x 5/8" |
| 28 | 30322 | 1 | Nut & Lock Washer, 10-32 |
| 30 | 35784A | 1 | Crankshaft |
| 31 | 35327 | 1 | Counterbalance Gear |
| 35 | 29826 | 1 | Screw, 10-32 x 3/4" |
| 36 | 29918 | 1 | Lock Washer |
| 38 | 29642 | 3 | Retaining Ring |
| 40 | 35776 | 1 | Piston, Pin & Ring Set (Std.) |
| 40 | 35777 | 1 | Piston, Pin & Ring Set (.010" OS) |
| 40 | 35778 | 1 | Piston, Pin & Ring Set (.020" OS) |
| 41 | 35773 | 1 | Piston & Pin Ass'y. (Std.) (Incl. 43) |
| 41 | 35774 | 1 | Piston & Pin Ass'y. (.010" OS) (Incl. 43) |
| 41 | 35775 | 1 | Piston & Pin Ass'y. (.020" OS) (Incl. 43) |
| 42 | 35779 | 1 | Ring Set (Std.) |
| 42 | 35780 | 1 | Ring Set (.010" OS) |
| 42 | 35781 | 1 | Ring Set (.020" OS) |
| 43 | 35772 | 2 | Piston Pin Retaining Ring |
| 45 | 35681 | 1 | Connecting Rod Ass'y. (Incl. 46 & 47) |
| 46 | 650908 | 1 | Connecting Rod Bolt |
| 47 | 650882 | 1 | Connecting Rod Bolt |
| 48 | 35313 | 2 | Valve Lifter |
| 50 | 35682A | 1 | Camshaft (MCR) |
| 51 | 35315A | 1 | Counterbalance Weight |
| 60 | 35316 | 1 | Blower Housing Extension |
| 62 | 650760 | 1 | Screw, 8-32 x 3/8" |
| 63 | 28545 | 1 | Grommet |
| 65 | 650128 | 1 | Screw, 10-24 x 1/2" |
| 66 | 30063 | 1 | Screw, Torx T-30, 1/4-20 x 1/2" |
| 69 | 35683 | 1 | * Cylinder Cover Gasket |
| 70 | 35684A | 1 | Cylinder Cover (Incl. 14, 15, 38, 71, 75) |
| 71 | 35377 | 1 | Crankshaft Bushing |
| 72 | 27642 | 2 | Oil Drain Plug |
| 75 | 35319 | 1 | Oil Seal |
| 80 | 35751 | 1 | Governor Shaft |
| 81 | 35479 | 2 | Washer |
| 82 | 35321 | 1 | Governor Gear Ass'y. |
| 83 | 35322 | 1 | Governor Spool |
| 84 | 29193 | 1 | Retaining Ring |
| 86 | 650833 | 7 | Screw, 1/4-20 x 1-3/16" |
| 87 | 650832 | 1 | Screw, 1/4-20 x 1-11/16" |
| 89 | 32589 | 1 | Flywheel Key |
| 90 | 611094 | 1 | Flywheel (W/Ring Gear) |
| 92 | 650880 | 1 | Lock Washer |
| 93 | 650881 | 1 | Flywheel Nut |
| 100 | 35135 | 1 | Solid State Ignition |
| 101 | 610118 | 1 | Spark Plug Cover |
| 102 | 650872 | 2 | Solid State Mounting Stud |

| Ref # | Part Number | Qty | Description |
|-------|-------------|-----|---|
| 103 | 650814 | 2 | Screw, Torx T-15, 10-24 x 1" |
| 119 | 35854 | 1 | * Cylinder Head Gasket |
| 120 | 35307 | 1 | Cylinder Head |
| 121 | 730218 | 2 | Valve Guide Kit (Incl. 2 of 122) |
| 122 | 792035 | 2 | Retaining Ring |
| 125 | 35308 | 1 | Exhaust Valve (Std.) |
| 125 | 35433 | 1 | Exhaust Valve (1/32" OS) |
| 126 | 35309 | 1 | Intake Valve (Std.) |
| 126 | 35432 | 1 | Intake Valve (1/32" OS) |
| 127 | 650691 | 6 | Washer |
| 128 | 650690 | 6 | Belleville Washer |
| 129 | 650746 | 2 | Screw, 5/16-18 x 1-3/8" |
| 130 | 650692 | 4 | Screw, 5/16-18 x 1-3/4" |
| 135 | 34046 | 1 | Resistor Spark Plug (RL86C) |
| 141 | 33481 | 4 | * "O" Ring (Also Incl. in 401) |
| 142 | 35475 | 2 | Push Rod Tube |
| 143 | 35310 | 1 | Rocker Arm Housing |
| 144 | 33484 | 1 | * "O" Ring (Also Incl. in 401) |
| 145 | 650168 | 1 | Washer |
| 146 | 32610A | 1 | Screw, 1/4-20 x 29/32" |
| 147 | 33509 | 1 | * "O" Ring (Also Incl. in 401) |
| 148 | 34410 | 1 | * "O" Ring (Also Incl. in 401) |
| 149 | 33510 | 2 | Valve Spring Cap |
| 150 | 33507 | 2 | Valve Spring |
| 151 | 33508 | 2 | Valve Spring Keeper |
| 152 | 35295 | 2 | * "O" Ring (Also Incl. in 401) |
| 153 | 35296 | 1 | Push Rod Guide |
| 154 | 650878 | 2 | Rocker Arm Stud |
| 155 | 35297 | 2 | Rocker Arm |
| 156 | 35298 | 2 | Rocker Arm Bearing |
| 157 | 28264 | 2 | * Lock Nut (Incl. 162) (Also Incl. in 4 01) |
| 158 | 35466 | 2 | Push Rod |
| 159 | 35299B | 1 | * "O" Ring (Incl. 2 of 161) (Also Incl. in 401) |
| 160 | 35300 | 1 | Rocker Arm Housing |
| 161 | 650879 | 2 | Screw, Torx T-20, 8-32 x 1/2" |
| 162 | 650903 | 2 | Jam Nut |
| 169 | 27896A | 2 | * Breather Gasket |
| 170 | 28423 | 1 | Breather Body |
| 171 | 28424 | 1 | Breather Element |
| 172 | 28425 | 1 | Valve Cover |
| 173 | 35350 | 1 | Breather Tube |
| 174 | 650128 | 2 | Screw, 10-24 x 1/2" |
| 180 | 35301 | 1 | Blower Housing Extension |
| 181 | 650128 | 1 | Screw, 10-24 x 1/2" |
| 182 | 650517 | 2 | Screw, 1/4-20 x 27/32" |
| 184 | 33263 | 1 | * Carburetor To Intake Pipe Gasket |
| 185 | 35690 | 1 | Intake Pipe |
| 186 | 35691 | 1 | Governor Link |
| 200 | 35786 | 1 | Control Bracket (Incl. 203 & 204) |
| 203 | 31342 | 1 | Compression Spring |
| 204 | 650549 | 1 | Screw, 5-40 x 7/16" |
| 207 | 35692 | 1 | Throttle Link |
| 209 | 650821 | 2 | Screw, 10-32 x 1/2" |
| 212 | 30773A | 1 | Bushing |
| 213 | 650930 | 1 | Screw, 10-32 x 5/8" |
| 216 | 35679 | 1 | R.P.M. Adjusting Lever |
| 223 | 650971 | 2 | Screw, Torx T-30, 5/16-18 x 7/8" |
| 224 | 33515A | 1 | * Intake Pipe Gasket |

| Ref # | Part Number | Qty | Description |
|-------|-------------|-----|--|
| 260 | 35716 | 1 | Blower Housing |
| 261 | 30063 | 1 | Screw, Torx T-30, 1/4-20 x 1/2" |
| 262 | 29747B | 2 | Screw, Torx T-40, 5/16-24 x 21/32" |
| 264A | 650805 | 1 | Screw, 1/4-20 x 11/16" |
| 265 | 35290 | 1 | Cylinder Head Cover |
| 266 | 650876 | 2 | Screw, 5/16-18 x 1-1/4" |
| 269 | 35762 | 1 | Exhaust Gasket |
| 270A | 35829A | 1 | Port Liner |
| 270 | 35788 | 1 | Manifold |
| 271 | 35293 | 1 | Locking Plate |
| 275 | 35789 | 1 | Muffler |
| 276 | 35348 | 1 | Locking Plate |
| 277 | 650877 | 2 | Screw, 5/16-18 x 4-1/2" |
| 281 | 33013 | 1 | Starter Bubble Cover |
| 282 | 650760 | 1 | Screw, 8-32 x 3/8" |
| 285 | 35287A | 1 | Starter Cup |
| 287 | 29752 | 4 | Nut & Lock Washer, 1/4-28 |
| 290 | 30705 | 1 | Fuel Line (10.50") |
| 291 | 30962 | 1 | Fuel Line |
| 291A | 29774 | 2 | Fuel Line |
| 292 | 26460 | 5 | Fuel Line Clamp |
| 296 | 34279B | 1 | Fuel Filter (Incl. 292) |
| 303 | 28566 | 1 | Fuel Fitting |
| 305 | 35574 | 1 | Oil Fill Tube |
| 307 | 35499 | 1 | "O" Ring |
| 308 | 35539 | 1 | Fill Tube Clip |
| 310 | 35700 | 1 | Dipstick |
| 314 | 650873 | 2 | Screw, 1/4-20 x 3/4" |
| 321 | 611161 | 1 | Diode |
| 325 | 34246 | 1 | Wire Clip |
| 326A | 34113 | 1 | Screen Plug |
| 342 | 650273 | 2 | Screw, 5/16-18 x 5/8" |
| 370 | 34686 | 1 | Logo Decal |
| 370A | 36261 | 1 | Lubrication Decal |
| 370B | 35274 | 1 | Instruction Decal |
| 380 | 632555 | 1 | Carburetor (Incl. 184) |
| 400 | 35331B | 1 | *Gasket Set (Incl. items marked PK in notes) Incl. part #'s 27272A (1), 27896A (2), 28264 (2), 33263 (1), 33481 (4), 33484 (1), 33509 (1), 33515A (1), 33629 (2), 34410 (1), 34912 (1), 35295 (2), 35299B (1), 35306A (1), 35317 (1), 35683 (1), 35762 (2) |
| 401 | 35332 | 1 | "O" Ring Kit (Also Incl. in 400) 28264 (2), 33481 (4), 33484 (1), 33509 (1), 34410 (1), 35295 (2), 35299B (1) |
| 420 | 730225 | 1 | SAE 30 4-Cycle Engine Oil (Quart) |

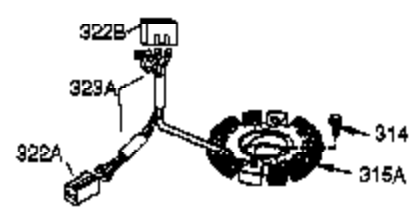
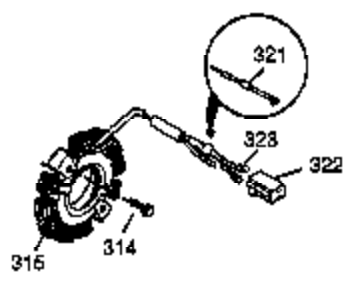
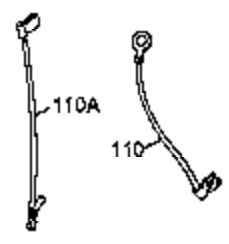
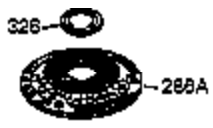
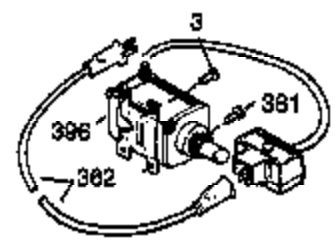
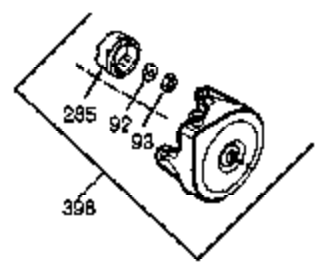
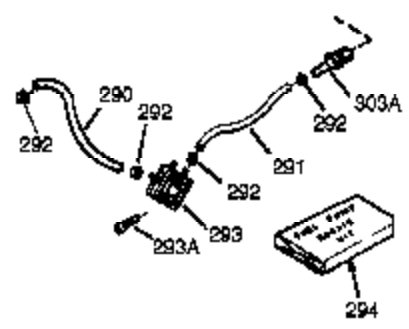
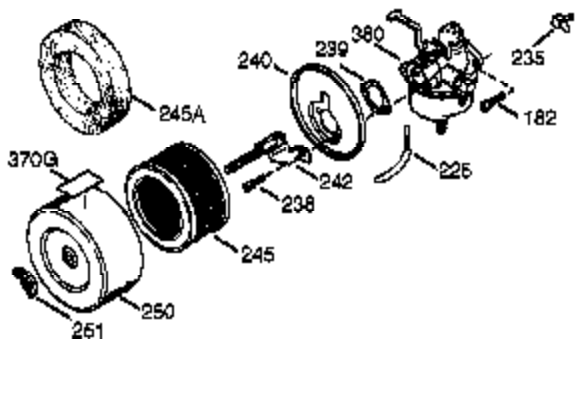

| Ref # | Part Number | Qty | Description |
|-------|-------------|-----|--|
| 62 | 650760 | 1 | Screw, 8-32 x 3/8" |
| 63 | 28545 | 1 | Grommet |
| 68 | 33356 | 1 | Ground Terminal |
| 92 | 650880 | 1 | Lock Washer |
| 93 | 650881 | 1 | Flywheel Nut |
| 110 | 35234 | 1 | Ground Wire |
| 129 | 650746 | 2 | Screw, 5/16-18 x 1-3/8" |
| 182 | 650517 | 2 | Screw, 1/4-20 x 27/32" |
| 225 | 35043 | 1 | Carburetor Tube |
| 238 | 28820 | 2 | Screw, 10-32 x 1/2" |
| 239 | 27272A | 1 | * Air Cleaner Gasket |
| 240 | 32380 | 1 | Air Cleaner Body |
| 242 | 32377 | 1 | Air Cleaner Bracket |
| 245 | 31925 | 1 | Air Cleaner Filter |
| 250 | 31926 | 1 | Air Cleaner Cover |
| 251 | 650513 | 1 | Wing Nut, 1/4-20" |
| 285 | 35287A | 1 | Starter Cup |
| 286 | 35790 | 1 | Starter Screen |
| 290 | 30705 | 1 | Fuel Line (10.50") |
| 291 | 30962 | 1 | Fuel Line |
| 292 | 26460 | 5 | Fuel Line Clamp |
| 293 | 35787 | 1 | Pulse Pump |
| 293A | 650931 | 2 | Screw, 8-32 x 1-1/2" |
| 294 | 35791 | 1 | Pulse Pump Repair Kit |
| 303 | 28566 | 1 | Fuel Fitting |
| 314 | 650873 | 2 | Screw, 1/4-20 x 3/4" |
| 315 | 611104 | 1 | Alternator Coil (3/5 Split)(Incl.321, 322,323) |
| 321 | 611161 | 1 | Diode |
| 322 | 611142 | 1 | Connector Body |
| 323 | 611118 | 2 | Terminal |
| 326A | 34113 | 1 | Screen Plug |
| 380 | 632555 | 1 | Carburetor (Incl. 184) |