

| Ref # | Part Number | Qty | Description                      |
|-------|-------------|-----|----------------------------------|
| 1     | 36922A      | 1   | Cylinder (Incl. 2, 20 & 72)      |
| 2     | 27652       | 2   | Dowel Pin                        |
| 14    | 28277       | 2   | Washer                           |
| 15    | 35324       | 1   | Governor Rod                     |
| 16    | 36284A      | 1   | Governor Lever (Incl. 212A)      |
| 17    | 29916       | 1   | Governor Lever Clamp             |
| 18    | 651028      | 1   | Screw, Torx T-15, 8-32 x 3/8"    |
| 19    | 35945       | 1   | Extension Spring                 |
| 20    | 35319       | 1   | Oil Seal                         |
| 25    | 36923       | 1   | Blower Housing Baffle            |
| 26    | 650561      | 2   | Screw, 1/4-20 x 5/8"             |
| 28    | 30322       | 1   | Lock Nut, 8-32                   |
| 35    | 29826       | 1   | Screw, 10-32 x 3/4"              |
| 36    | 29918       | 1   | Lock Washer                      |
| 37    | 29216       | 1   | Lock Nut, 10-32                  |
| 38    | 29642       | 1   | Retaining Ring                   |
| 52    | 36332       | 1   | Oil Pump Assembly                |
| 60    | 36927       | 1   | Blower Housing Extension         |
| 65    | 650128      | 1   | Screw, 10-24 x 1/2"              |
| 66    | 30063       | 1   | Screw, Torx T-30, 1/4-20 x 1/2"  |
| 90    | 611240      | 1   | Flywheel                         |
| 91A   | 611242      | 1   | Flywheel Retainer                |
| 91    | 611241      | 1   | Flywheel Fan                     |
| 92    | 650666      | 1   | Lock Washer                      |
| 93    | 650594      | 1   | Flywheel Nut                     |
| 100   | 36344       | 1   | Solid State Ignition (Incl. 101) |
| 101   | 610118      | 1   | Spark Plug Cover                 |
| 102   | 651024      | 2   | Solid State Mounting Stud        |
| 103   | 651007      | 2   | Screw, Torx T-15, 10-24 x 15/16" |
| 110   | 36225       | 1   | Ground Wire                      |
| 119   | 36932       | 1   | * Cylinder Head Gasket           |
| 120   | 36933       | 1   | Cylinder Head                    |
| 125   | 36934       | 1   | Exhaust Valve (Std.)             |
| 125   | 36936       | 1   | Exhaust Valve (1/32" OS)         |
| 126   | 36935       | 1   | Intake Valve (Std.)              |
| 126   | 36937       | 1   | Intake Valve (1/32" OS)          |
| 127   | 650691      | 6   | Washer                           |
| 128   | 650690      | 6   | Belleville Washer                |
| 130   | 650697A     | 6   | Screw, 5/16-18 x 2-1/2"          |
| 135   | 34645       | 1   | Spark Plug (RN4C)                |
| 150   | 33507       | 2   | Valve Spring                     |
| 151   | 33508       | 2   | Valve Spring Keeper              |
| 153   | 35949       | 1   | Push Rod Guide                   |
| 154   | 650945      | 2   | Rocker Arm Stud                  |
| 155   | 35950       | 2   | Rocker Arm                       |
| 156   | 650890      | 2   | Lock Washer                      |
| 157   | 650947      | 2   | Lock Nut, 5/16-24                |
| 158   | 35466       | 2   | Push Rod                         |
| 159   | 35952       | 1   | Rocker Arm Cover Gasket          |
| 160   | 35953A      | 1   | Rocker Arm Cover                 |
| 161   | 30063       | 4   | Screw, Torx T-30, 1/4-20 x 1/2"  |
| 169   | 27896A      | 2   | * Breather Gasket                |
| 170   | 28423       | 1   | Breather Body                    |
| 171   | 28424       | 1   | Breather Element                 |
| 172   | 36938       | 1   | Valve Cover                      |
| 173   | 36939       | 1   | Breather Tube                    |
| 174   | 650128      | 2   | Screw, 10-24 x 1/2"              |
| 180   | 35954       | 1   | Blower Housing Extension         |

| Ref # | Part Number | Qty | Description  |
|-------|-------------|-----|--|
| 181   | 30200       | 2   | Screw, 10-24 x 9/16"   |
| 186   | 36941       | 1   | Governor Link  |
| 200   | 36233       | 1   | Control Bracket (Incl. 203, 204 & 212 A)   |
| 203   | 36482       | 1   | Compression Spring   |
| 204   | 650777      | 1   | Screw, 6-32 x 21/32"   |
| 209   | 650902      | 2   | Screw, 10-32 x 7/16"   |
| 210   | 27793       | 2   | Conduit Clip   |
| 211   | 28942       | 2   | Screw, 10-32 x 3/8"  |
| 212A  | 36288       | 2   | Bushing  |
| 260   | 36943       | 1   | Blower Housing   |
| 262   | 30063       | 2   | Screw, Torx T-30, 1/4-20 x 1/2"  |
| 263   | 36367       | 1   | Tirm Ring  |
| 264   | 650273      | 2   | Screw, 5/16-18 x 5/8"  |
| 265   | 36944       | 1   | Cylinder Head Cover  |
| 270A  | 35829A      | 1   | Exhaust Port Liner   |
| 286   | 36343       | 1   | Cup & Screen   |
| 291   | 30705       | 1   | Fuel Line  |
| 292   | 26460       | 2   | Fuel Line Clamp  |
| 296   | 34279B      | 1   | Fuel Filter (Incl. 292)  |
| 314   | 650873      | 2   | Screw, 1/4-20 x 3/4"   |
| 315   | 611104      | 1   | Alternator Coil (3/5 Split)(Incl. 321 - 323)   |
| 321   | 611161      | 1   | Diode  |
| 322   | 611142      | 1   | Connector Body   |
| 323   | 611118      | 1   | Terminal   |
| 325   | 34246       | 1   | Wire Clip  |
| 326   | 36210       | 1   | Blower Housing Plug  |
| 347   | 650949      | 3   | Screw, 10-32 x 9/16"   |
| 361   | 650990      | 4   | Screw, Torx T-30, 5/16-18 x 15/32"   |
| 370G  | 35274       | 1   | Oil Instruction Decal  |
| 394A  | 650982      | 1   | Washer   |
| 395   | 36914       | 1   | Electric Starter Motor (12 Volt)   |
| 400   | 36947       | 1   | * Gasket Set (Incl. items marked PK i n notes) Incl. part #'s<br>27896A (2),35317 (1), 35952 (1), 36333 (1), 36352 (1), 36358<br>(2), 36832 (1), 36930 (1), 36932 (1), 36942 (1) |
| 420   | 730225      | 1   | SAE 30 4-Cycle Engine Oil (Quart)  |

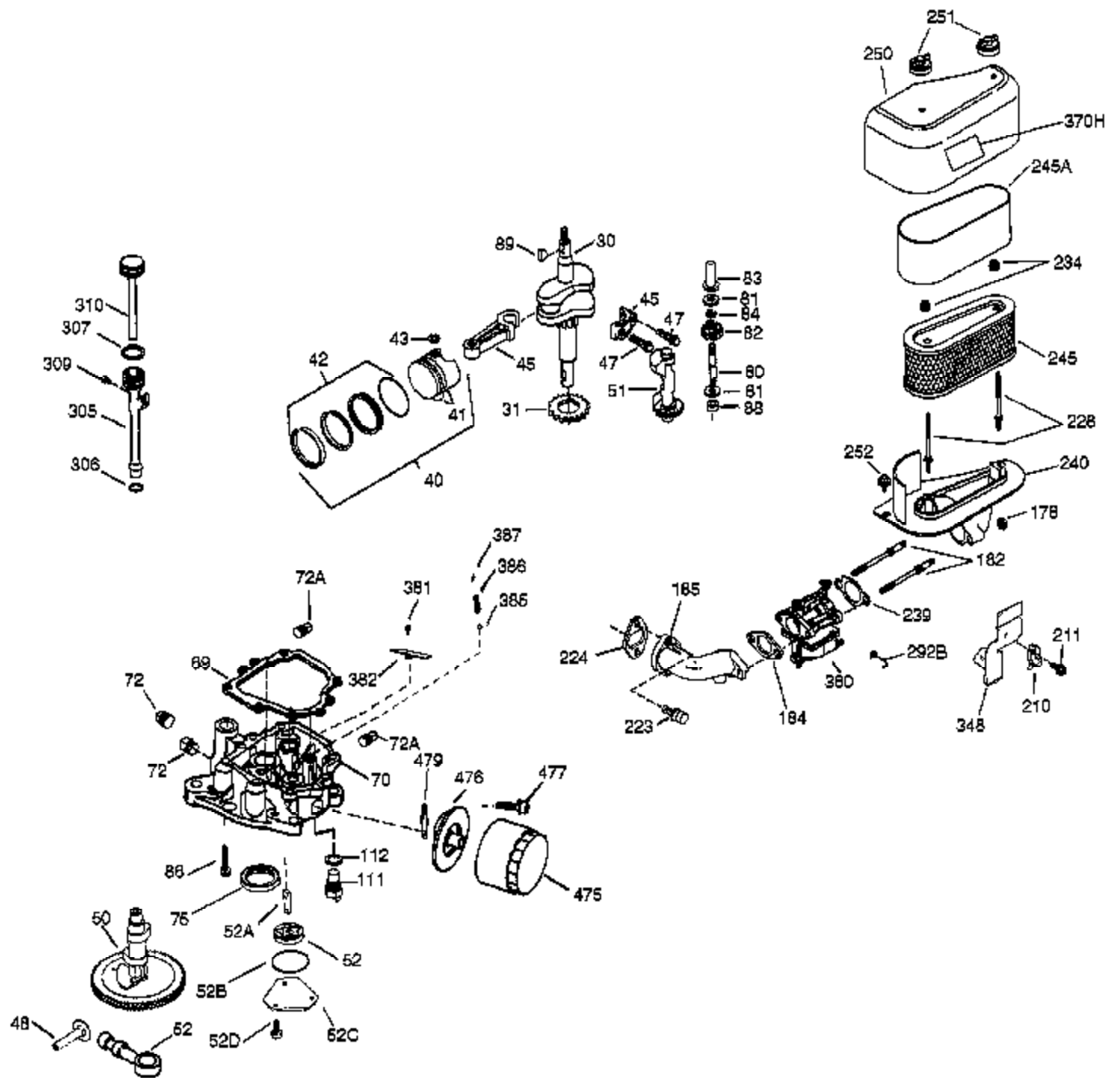

| Ref # | Part Number | Qty | Description                                   |
|-------|-------------|-----|---|
| 30    | 36924       | 1   | Crankshaft                                    |
| 31    | 35327       | 1   | Counterbalance Gear                           |
| 40    | 35776A      | 1   | Piston, Pin & Ring Set (Std.)                 |
| 40    | 35777A      | 1   | Piston, Pin & Ring Set (.010" OS)             |
| 40    | 35778A      | 1   | Piston, Pin & Ring Set (.020" OS)             |
| 41    | 35773A      | 1   | Piston & Pin Ass'y. (Std.) (Incl. 43)         |
| 41    | 35774A      | 1   | Piston & Pin Ass'y. (.010" OS) (Incl. 43)     |
| 41    | 35775A      | 1   | Piston & Pin Ass'y. (.020" OS) (Incl. 43)     |
| 42    | 35779       | 1   | Ring Set (Std.)                               |
| 42    | 35780       | 1   | Ring Set (.010" OS)                           |
| 42    | 35781       | 1   | Ring Set (.020" OS)                           |
| 43    | 35772       | 2   | Piston Pin Retaining Ring                     |
| 45    | 36925       | 1   | Connecting Rod Ass'y. (Incl. 47)              |
| 47    | 651033      | 2   | Connecting Rod Bolt                           |
| 48    | 35313       | 2   | Valve Lifter                                  |
| 50    | 36926A      | 1   | Camshaft (MCR)                                |
| 51    | 35315A      | 1   | Counterbalance Weight                         |
| 52A   | 36331       | 1   | Oil Pump Shaft                                |
| 52B   | 36333       | 1   | "O" Ring                                      |
| 52C   | 36334       | 1   | Oil Pump Cover (Incl. 52B)                    |
| 52D   | 650888      | 3   | Screw, Torx T-30, 1/4-20 x 43/64"             |
| 52    | 36332       | 1   | Oil Pump Assembly                             |
| 69    | 35317       | 1   | * Mounting Flange Gasket                      |
| 70    | 36928       | 1   | Mounting Flange (Incl. 72, 75, 80 & 3 81-387) |
| 72    | 31927       | 1   | Oil Drain Plug                                |
| 75    | 35319       | 1   | Oil Seal                                      |
| 80    | 35712       | 1   | Governor Shaft                                |
| 81    | 35479       | 2   | Washer  |
| 82    | 35321       | 1   | Governor Gear Ass'y.                          |
| 83    | 35322       | 1   | Governor Spool                                |
| 84    | 29193       | 1   | Retaining Ring                                |
| 86    | 650833      | 7   | Screw, 1/4-20 x 1-3/16"                       |
| 88    | 31707A      | 1   | Spacer  |
| 89    | 650592      | 1   | Flywheel Key                                  |
| 178   | 650928      | 2   | Lock Nut, 1/4-20                              |
| 182   | 650925A     | 2   | Screw, 1/4-20 x 27/32"                        |
| 184   | 36352       | 1   | * Carburetor To Intake Pipe Gasket            |
| 185   | 36940       | 1   | Intake Pipe                                   |
| 210   | 27793       | 2   | Conduit Clip                                  |
| 211   | 28942       | 2   | Screw, 10-32 x 3/8"                           |
| 223   | 650378      | 2   | Screw, Torx T-30, 5/16-18 x 1-3/32"           |
| 224   | 36942       | 1   | * Intake Pipe Gasket                          |
| 228   | 650977      | 2   | Air Cleaner Stud                              |
| 234   | 650825      | 2   | Nut & Lock Washer, 1/4-20                     |
| 239   | 36358       | 2   | * Air Cleaner Gasket                          |
| 240   | 36355       | 1   | Air Cleaner Body (Incl. 239)                  |
| 245   | 36356       | 1   | Air Cleaner Filter (Incl. 234)                |
| 245A  | 36357       | 1   | Air Cleaner Filter                            |
| 250   | 36359       | 1   | Air Cleaner Cover                             |
| 251   | 650886      | 2   | Wing Nut, 1/4-20                              |
| 252   | 650976      | 1   | Screw, 1/4-20 x 19/32"                        |
| 286   | 36343       | 1   | Cup & Screen                                  |
| 292B  | 36946       | 1   | Fuel Line Clamp                               |
| 305   | 36945       | 1   | Oil Fill Tube                                 |
| 306   | 36832       | 1   | Fill Tube Gasket                              |
| 307   | 35499       | 1   | "O" Ring                                      |
| 309   | 650976      | 1   | Screw, 1/4-20 x 19/32"                        |
| 310   | 35973       | 1   | Dipstick                                      |

| Ref # | Part Number | Qty | Description                         |
|-------|-------------|-----|-------------------------------------|
| 348   | 36383       | 1   | Choke Bracket                       |
| 380   | 640065      | 1   | Carburetor (Incl. 184)              |
| 381   | 650767      | 1   | Screw, 8-32 x 27-64"                |
| 382   | 36931       | 1   | Oil Strainer Screen                 |
| 385   | 570673      | 1   | Ball                                |
| 386   | 36329       | 1   | Pressure Relief Spring              |
| 387   | 36330       | 1   | Roll Pin                            |
| 475   | 36961       | 1   | Oil Filter                          |
| 476   | 36929       | 1   | Oil Filter Adapter (Incl. 479)      |
| 477   | 650378      | 2   | Screw, Torx T-30, 5-16/18 x 1-3/32" |
| 479   | 36930       | 1   | Oil Filter Adapter Gasket           |